

F.A.I. RTE.	SECTION	COUNTY	TOTAL SHEETS	SHEET NO.
80	(50-5) HBK-2	LASALLE	331	99
STA. 400+00.00 TO STA. 413+00.00		ILLINOIS FED. AID PROJECT		

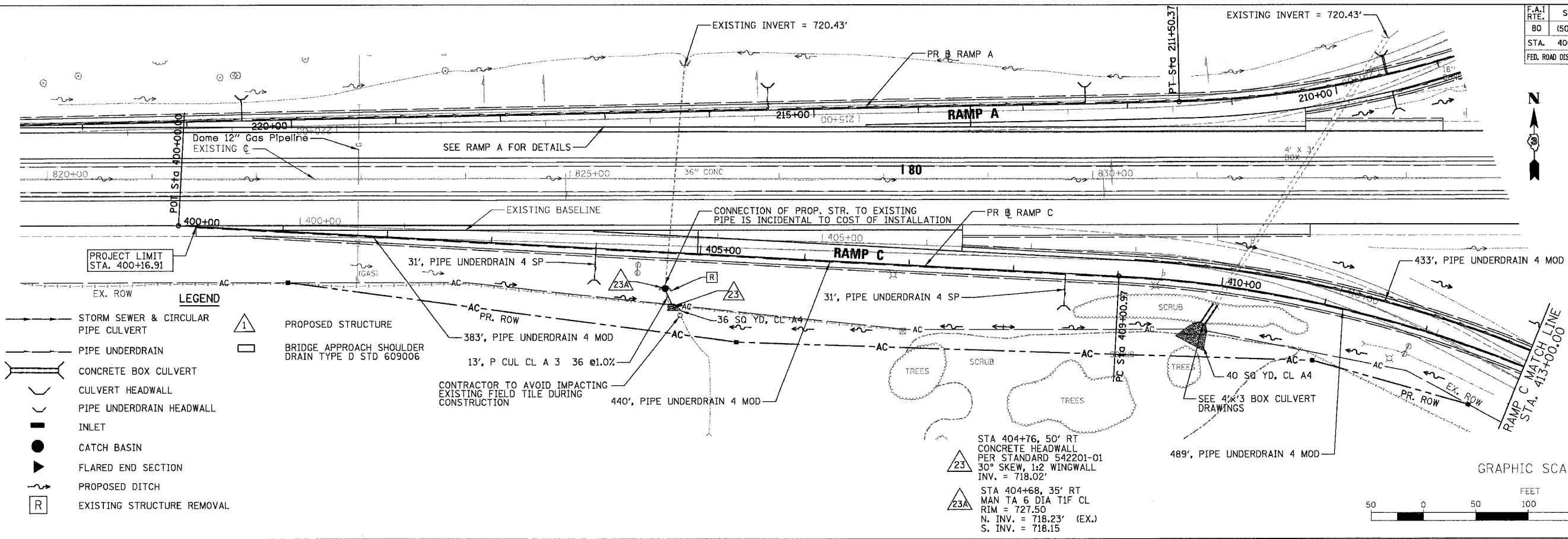

- LEGEND**
- STORM SEWER & CIRCULAR PIPE CULVERT
  - PIPE UNDERDRAIN
  - CONCRETE BOX CULVERT
  - CULVERT HEADWALL
  - PIPE UNDERDRAIN HEADWALL
  - INLET
  - CATCH BASIN
  - ▼ FLARED END SECTION
  - PROPOSED DITCH
  - [R] EXISTING STRUCTURE REMOVAL
  - △ PROPOSED STRUCTURE
  - BRIDGE APPROACH SHOULDER DRAIN TYPE D STD 609006

△ 23 STA 404+76, 50' RT CONCRETE HEADWALL PER STANDARD 542201-01 30° SKEW, 1/2 WINGWALL INV. = 718.02'

△ 23A STA 404+68, 35' RT MAN TA 6 DIA TIF CL RIM = 727.50 N. INV. = 718.23' (EX.) S. INV. = 718.15



DATE: \_\_\_\_\_ BY: \_\_\_\_\_

PLANNING: \_\_\_\_\_ SURVEYED: \_\_\_\_\_

NOTE BOOK NO. \_\_\_\_\_ GRADES CHECKED: \_\_\_\_\_

NO. \_\_\_\_\_ STRUCTURE NOTATIONS DWG. NO. \_\_\_\_\_

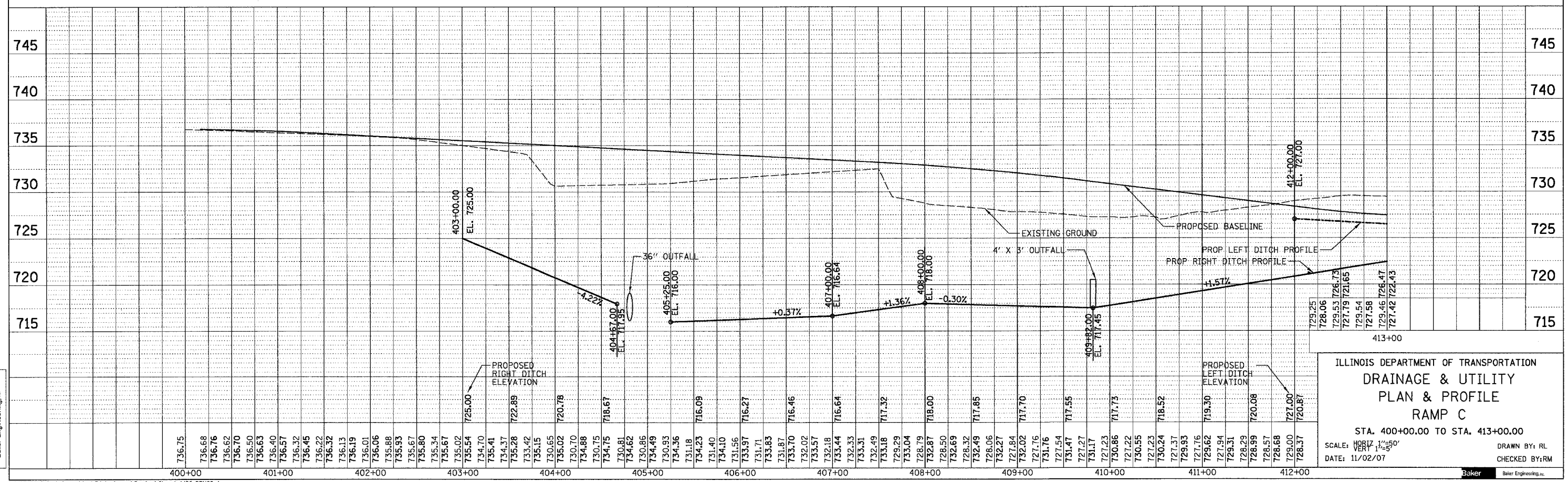

ILLINOIS DEPARTMENT OF TRANSPORTATION  
**DRAINAGE & UTILITY**  
**PLAN & PROFILE**  
**RAMP C**  
 STA. 400+00.00 TO STA. 413+00.00

SCALE: HORIZ. 1" = 50' VERT. 1" = 5'

DATE: 11/02/07

DRAWN BY: RL  
 CHECKED BY: RM



h:\107496\3.0 deliverables\3\drainage\Design\Sheets\80\_DRU08.dru 1/5/2007