

F.A.I. RTE.	SECTION	COUNTY	TOTAL SHEETS	SHEET NO.
80	(50-5) HBK-2	LASALLE	331	102
STA. 512 + 00.00 TO STA. 526 + 44.77				
FED. ROAD DIST. NO. ILLINOIS FED. AID PROJECT				

- 30 STA 305+48, 28' RT PRC FLAR END SEC 36 INV.=711.09
- 30A STA 304+50, 28' RT PRC FLAR END SEC 12 INV.=713.33
- 31 STA 515+64, 31' RT PRC FLAR END SEC 36 INV.=710.55
- 31A STA 304+50, 18' LT CB TA 4 DIA TIF OL RIM=718.70 INV.=713.75

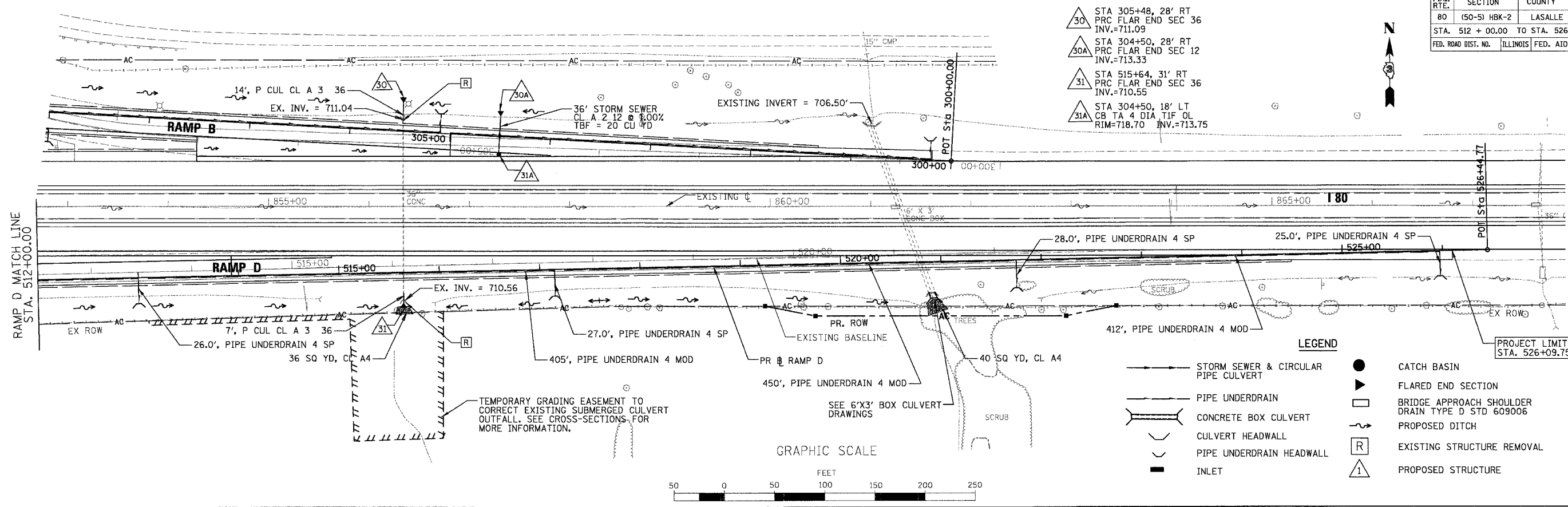

- LEGEND**
- STORM SEWER & CIRCULAR PIPE CULVERT
 - PIPE UNDERDRAIN
 - CONCRETE BOX CULVERT
 - CULVERT HEADWALL
 - PIPE UNDERDRAIN HEADWALL
 - INLET
 - CATCH BASIN
 - FLARED END SECTION
 - BRIDGE APPROACH SHOULDER DRAIN TYPE D STD 609006
 - PROPOSED DITCH
 - EXISTING STRUCTURE REMOVAL
 - PROPOSED STRUCTURE

PLAN	SURVEYED	DATE
	PLANNED	BY
	CHECKED	
	NO. OF WY. CHECKED	
	DATE FILE NAME	

PROFILE	SURVEYED	DATE
	PLANNED	BY
	CHECKED	
	NO. OF WY. CHECKED	
	STRUCTURE NOTATIONS CHD	

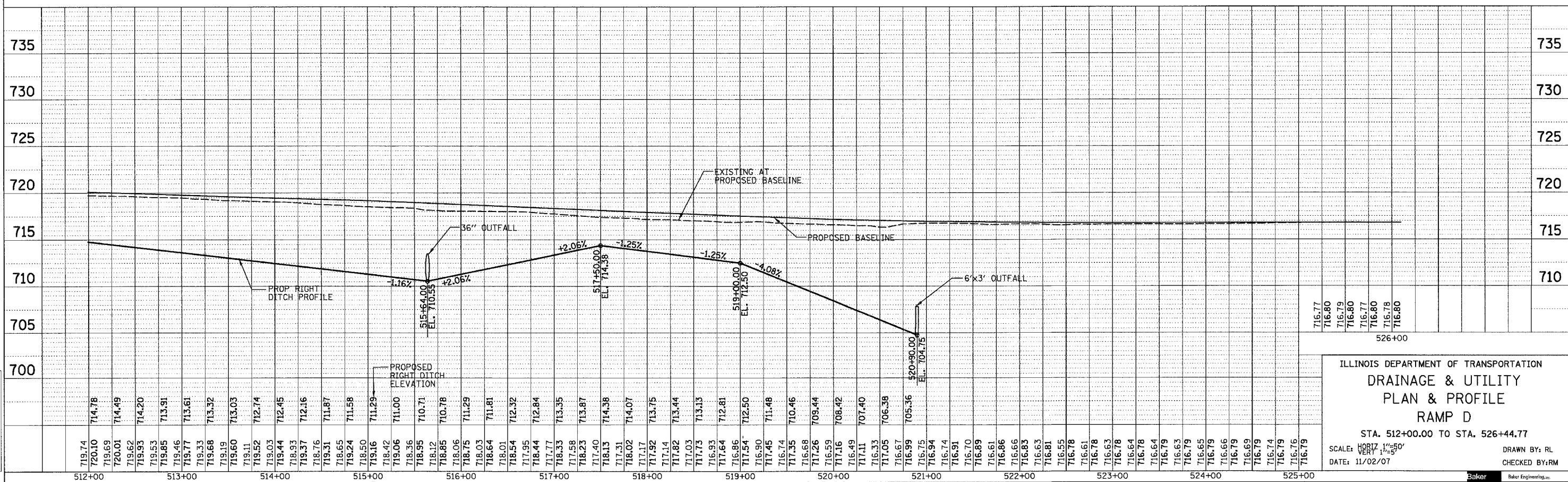

ILLINOIS DEPARTMENT OF TRANSPORTATION
DRAINAGE & UTILITY
PLAN & PROFILE
RAMP D
 STA. 512+00.00 TO STA. 526+44.77
 SCALE: HORIZ. 1"=50'
 VERT. 1"=5'
 DATE: 11/02/07
 DRAWN BY: RL
 CHECKED BY: RM



h:\07496\3.0 dellverable\3.1 drainage\Design\Sheets\80_DRU.dru
 11/5/2007