

F.A.P. RTE.	SECTION	COUNTY	TOTAL SHEETS	SHEET NO.
318	1RS-1, 2RS-2,	MARSHALL	28	13
645	3RS-3; (106)RS-5			
FED. ROAD DIST. NO.		ILLINOIS FED. AID PROJECT		

HENRY

ROADWAY IMPROVEMENTS
BEGINS STA. 7+98

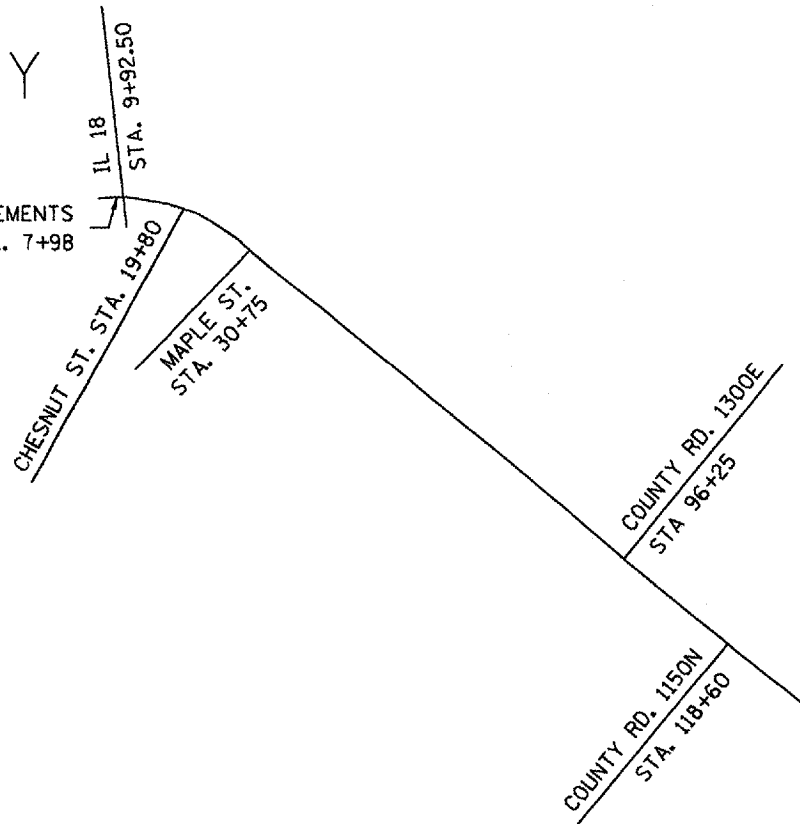

DETAIL A

ROADWAY IMPROVEMENTS
ENDS STA. 386+34.51

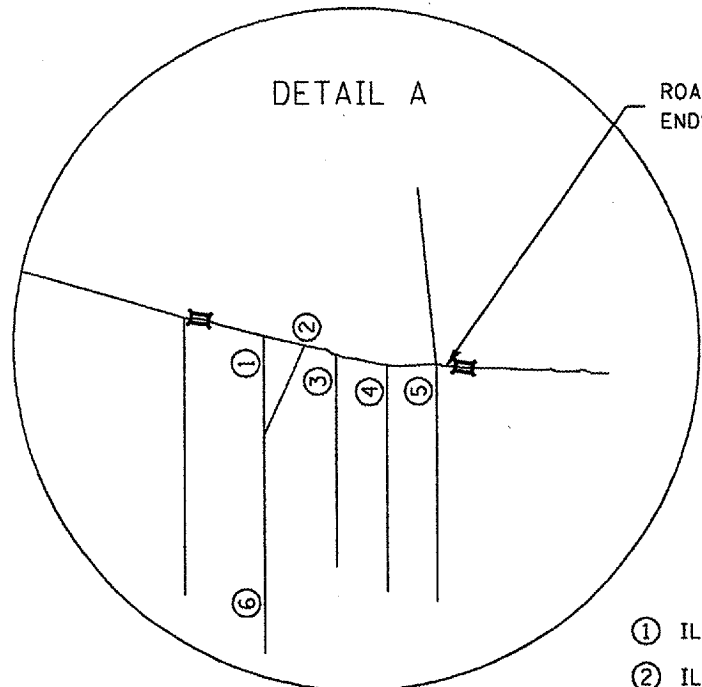

- ① IL-17 A: STA. 369+40
- ② IL-17 W: STA. 370+87
- ③ MAIN ST.: STA. 375+55
- ④ NORTH ST.: STA. 380+88
- ⑤ FERRY ST.: STA. 385+63
- ⑥ IMPROVEMENTS ON IL-17 W: STA. 532+25 TO STA. 533+60

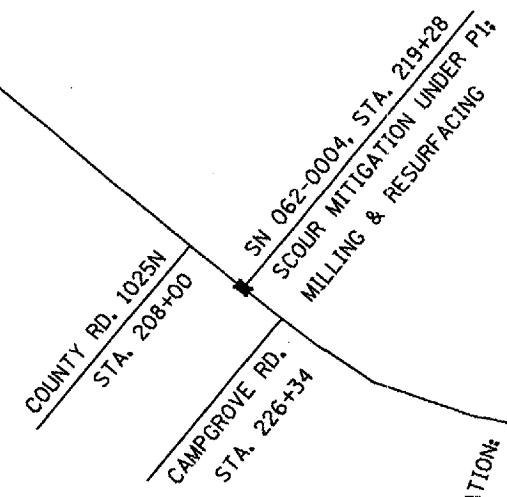

SN 062-0004, STA. 219+28
SCOUR MITIGATION UNDER PI;
MILLING & RESURFACING

STATION EQUATION:
STA. 284+19.50 (BK)
STA. 284+23.25 (AH)
COUNTY RD. 1100E
STA. 290+32

SPARLAND

SEE DETAIL A
ON THIS SHEET

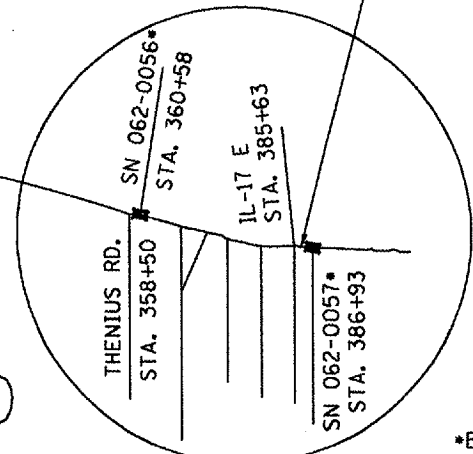

*BRIDGE OMISSION

PLOT DATE = 10/20/2007
 PLOT NAME = I:\68355\12\henry\plotted.dgn
 PLOT SCALE = 1/8" = 100' / 1" = 1200'
 USER NAME = korojm

REVISIONS	
NAME	DATE

ILLINOIS DEPARTMENT OF TRANSPORTATION

LINE DIAGRAM
(NOT TO SCALE)

SCALE: VERT.
HORIZ.
DATE

DRAWN BY
CHECKED BY