

F.A.P. RTE.	SECTION	COUNTY	TOTAL SHEETS	SHEET NO.
310	(103BR)I-1	MERCER	9	1

14
13

D-94-086-07

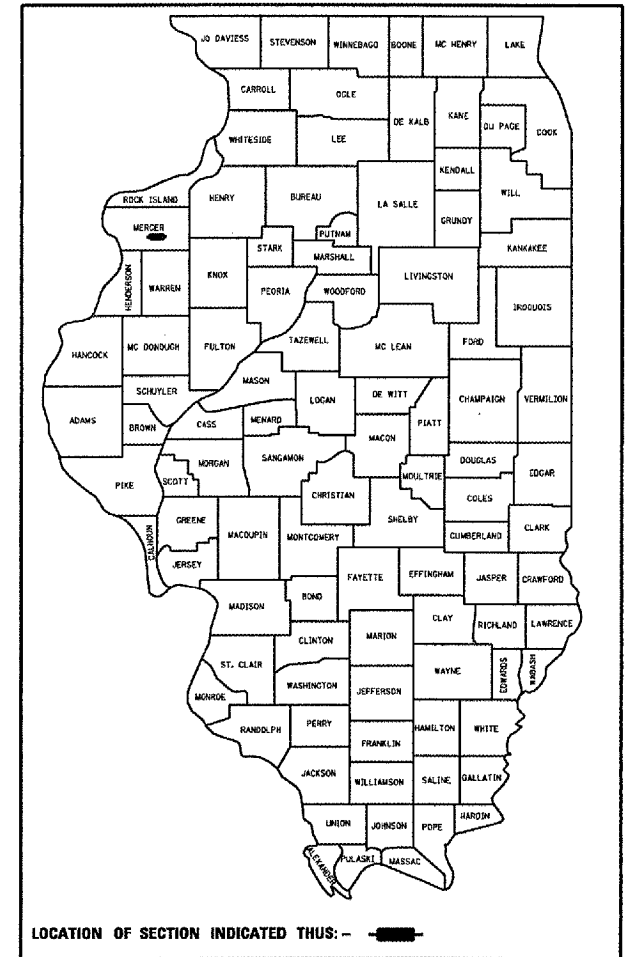

STATE OF ILLINOIS
DEPARTMENT OF TRANSPORTATION
DIVISION OF HIGHWAYS

**PROPOSED
HIGHWAY PLANS**

FAP 310 (US.67)
SECTION (103BR)I-1
MERCER COUNTY
C-94-131-07

INDEX OF SHEETS:

1. COVER SHEET
2. GENERAL NOTES
3. SUMMARY OF QUANTITIES
4. TYPICAL SECTIONS
5. SCHEDULE OF QUANTITIES
6. GENERAL LAYOUT
7. TRAFFIC CONTROL
- 7A-7D. REMOVE AND REERECT STEEL PLATE BEAM GUARDRAIL
- 8-9. GENERAL PLAN, ELEVATION, BEAM DETAILS

STANDARDS:

- 701001-01 701901
- 701006-02 780001-01
- 701201-02

SN. 066-0003

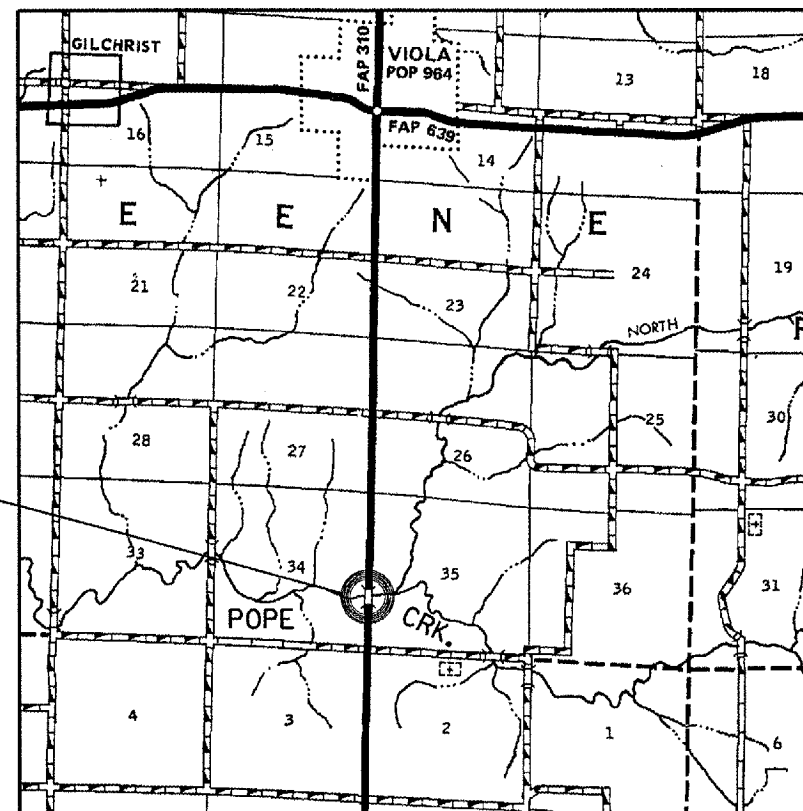

LOCATION MAP

PROJECT CONSISTS OF THE INSTALLATION OF STEEL SUPPORTING BEAMS FOR BRACING (5) DETERIORATED PPC BEAMS ON STRUCTURE (SN.066-0003) CARRYING US67 OVER POPE CREEK THREE MILES SOUTH OF VIOLA.

STATE OF ILLINOIS
DEPARTMENT OF TRANSPORTATION
DIVISION OF HIGHWAYS

SUBMITTED *Oct 18, 2007*

[Signature]
DEPUTY DIRECTOR OF HIGHWAYS, REGION ENGINEER

Dec 7, 2007
[Signature]
ENGINEER OF DESIGN AND ENVIRONMENT

Dec 7, 2007
[Signature]
DIRECTOR OF HIGHWAYS, CHIEF ENGINEER

**PRINTED BY THE AUTHORITY
OF THE STATE OF ILLINOIS**

DESIGNER: CLARK JONES
PHONE: (309)671-3452

PROJECT ENGINEER: JIM MILLER
PHONE: (309)671-3451

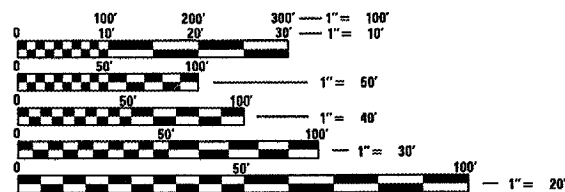

FULL SIZE PLANS HAVE BEEN PREPARED USING STANDARD ENGINEERING SCALES. REDUCED SIZED PLANS WILL NOT CONFORM TO STANDARD SCALES. IN MAKING MEASUREMENTS ON REDUCED PLANS, THE ABOVE SCALES MAY BE USED.

J.U.L.I.E.
JOINT UTILITY LOCATION INFORMATION FOR EXCAVATION
1-800-892-0123