

F.A.P. RTE.	SECTION	COUNTY	TOTAL SHEETS	SHEET NO.
310	(103BR11-1)	MERCER	9	6
STA. 10+530.216 TO STA. 10+560.216				
FED. ROAD DIST. NO. 4   ILLINOIS FED. AID PROJECT				

BENCHMARK #66:  
Sta. 10+528.601 - 5.791m. Rt. Chiseled Square on top of  
East end wingwall of Pope Creek bridge. Elev. 203.067

### T14N-R2W-4TH P.M. SECTION 34 & 35

JON E. RICKETTE  
AND  
RHONDA L. RICKETTS

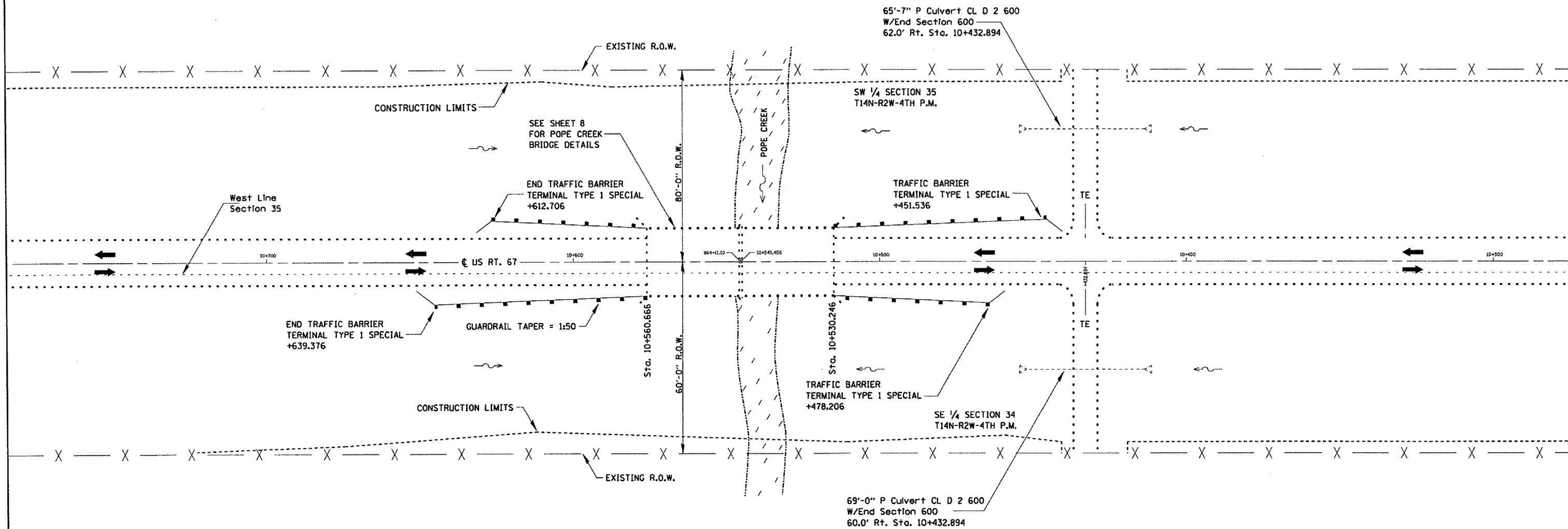
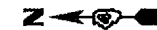

DANIEL S. MILLER  
AND  
RHONDA E. MILLER

SN.066-0003 US. 67  
over POPE CRK.

REVISIONS	
NAME	DATE

ILLINOIS DEPARTMENT OF TRANSPORTATION

## GENERAL LAYOUT

SCALE: VERT.  
HORIZ.  
DATE 06-18-2007

DRAWN BY CEJ  
CHECKED BY

**NOTES**  
When it is necessary for the Contractor to remove guardrail for temporary off-road access the appearance and condition of the affected sod area shall be left as it was found and according to the discretion of the Engineer. All necessary work and Seeding Minor Areas shall be included in cost of Erosion Control Blanket.

I:\Projects\68752\Drawings\68752-0003 US67 over PopeCk.dwg  
 DATE 06-29-07  
 FILED IN: I:\Projects\68752\Drawings\68752-0003 US67 over PopeCk.dwg  
 PLOT DATE: 06-29-07