

F.A.P. RTE.	SECTION	COUNTY	TOTAL SHEETS	SHEET NO.
.840	(121,122)RS-3	_VERMILION_	.89	_35_
STA. 1209+00		TO STA. 1237+00		
FED. ROAD DIST. NO. _		ILLINOIS FED. AID PROJECT		

SEC. 23, T 23 N, R 14 W

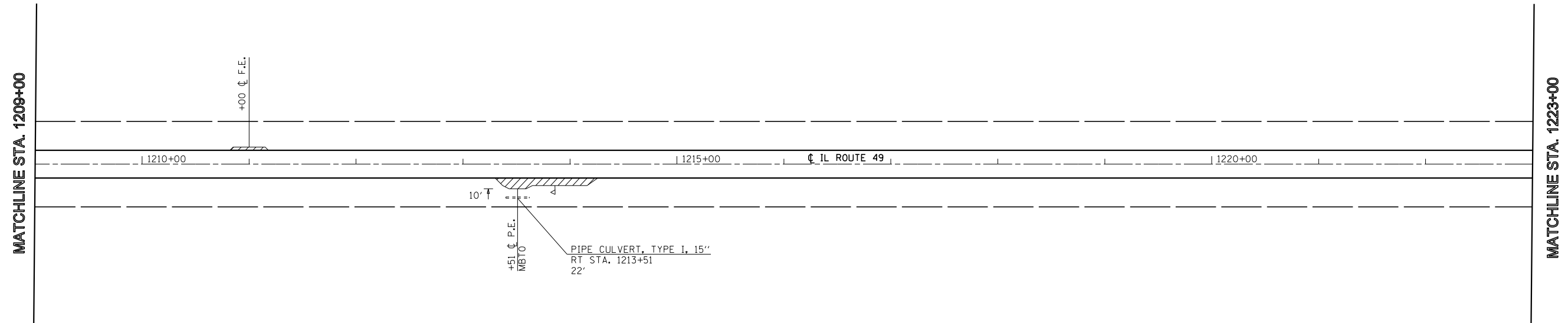

INCIDENTAL HMA RESURFACING

SEC. 24, T 23 N, R 14 W

SEC. 23, T 23 N, R 14 W



SEC. 14, T 23 N, R 14 W

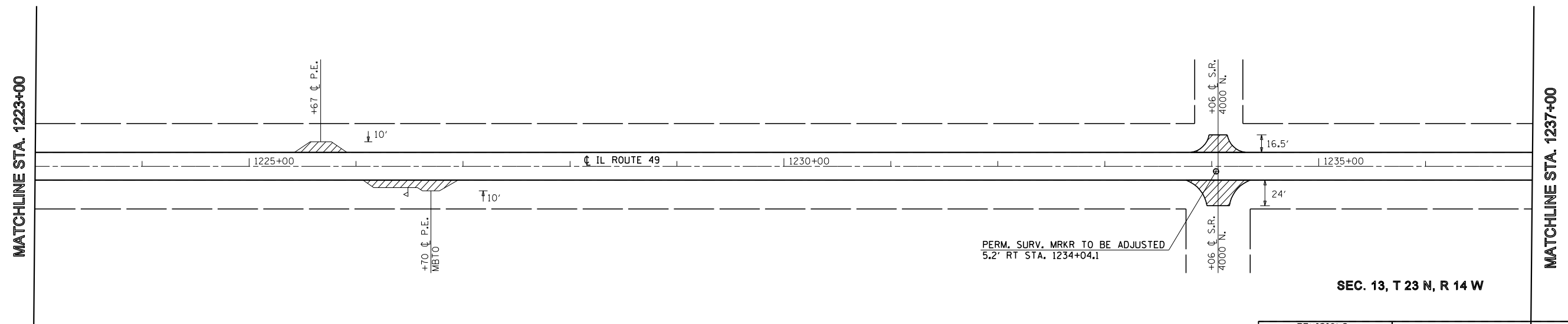

INCIDENTAL HMA RESURFACING

SEC. 24, T 23 N, R 14 W

PERM. SURV. MRKR TO BE ADJUSTED
5.2' RT STA. 1234+04.1

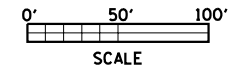

REVISIONS	
NAME	DATE

ILLINOIS DEPARTMENT OF TRANSPORTATION

EXISTING / PROPOSED
PLAN SHEETS
STA. 1209+00 - 1237+00

SCALE: VERT.
HORIZ.
DATE

DRAWN BY
CHECKED BY

PLOT DATE = 11/16/2007
FILE NAME = c:\projects\4595580 (v8)\rev.plansht.dgn
PLOT SCALE = 1/8"=1'-0" / IN.
USER NAME = collierb