

F.A.P. RTE.	SECTION	COUNTY	TOTAL SHEETS	SHEET NO.
840	(121,122)RS-3	VERMILION	89	37
STA. 1265+00		TO STA.		
FED. ROAD DIST. NO.	ILLINOIS	FED. AID PROJECT		

SEC. 14, T 23 N, R 14 W

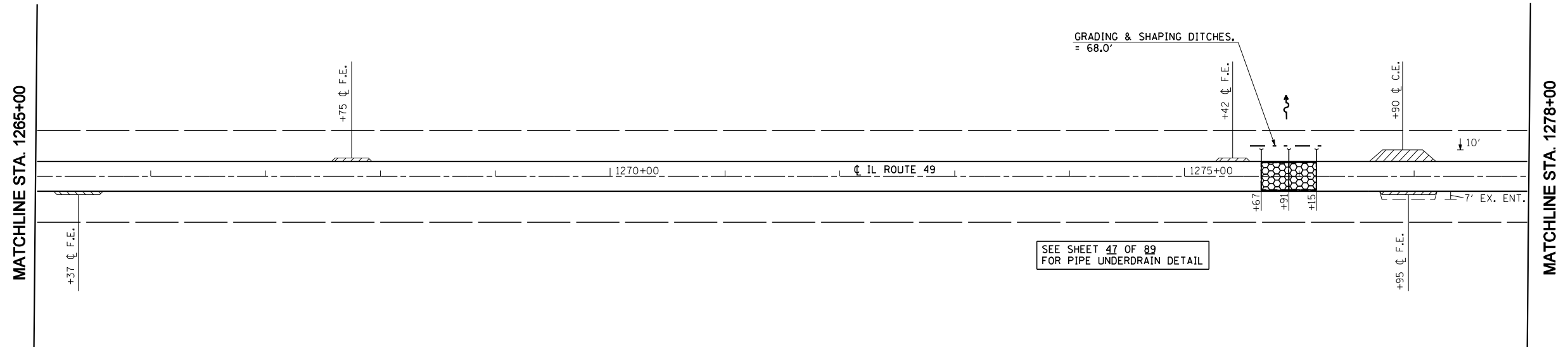

- CLASS D PATCH, TYPE IV, 9"
- INCIDENTAL HMA RESURFACING

SEC. 13, T 23 N, R 14 W

SEC. 14, T 23 N, R 14 W



BENCH MARK: 4689-2
CHISLED SQUARE ON TOP
OF THE NORTHWEST
WINGWALL OF BRIDGE
ELEVATION = 716.459

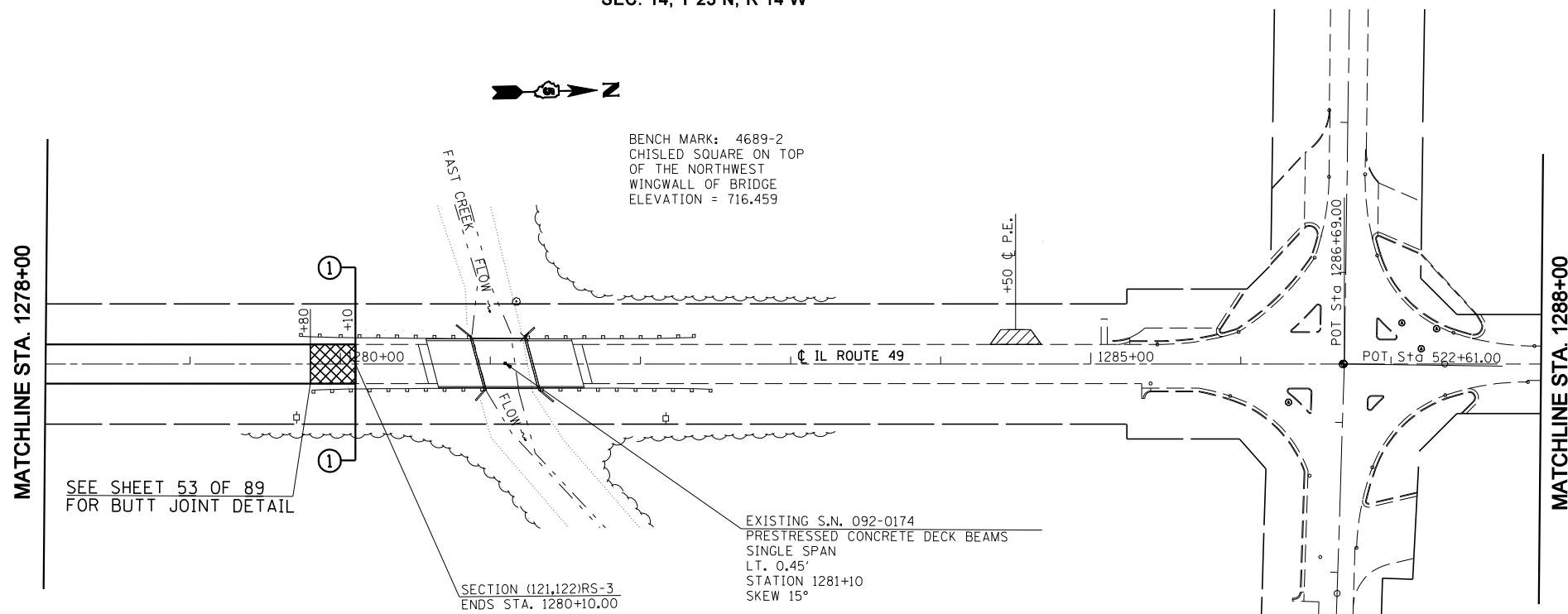

- HMA SURFACE REMOVAL - BUTT JOINT
- INCIDENTAL HMA RESURFACING

SEC. 13, T 23 N, R 14 W

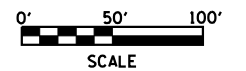

REVISIONS	
NAME	DATE

ILLINOIS DEPARTMENT OF TRANSPORTATION

**EXISTING / PROPOSED
PLAN SHEETS
STA. 1265+00 - 1288+00**

SCALE: VERT.
HORIZ.
DATE

DRAWN BY
CHECKED BY