

F.A.I. RTE.	SECTION	COUNTY	TOTAL SHEETS	SHEET NO.
*	**	SANGAMON	248	81
STA.		TO STA.		
FED. ROAD DIST. NO.	ILLINOIS	FED. AID PROJECT		
* FA155(I-55), FA172(I-72), FAP666(I-55 BUS)				
** D6 INTERSTATE RS,BR,M CAB 2008				

**RAMP 'B'**

EXIST. CURVE 104 PI STA. = 7+94.39 Δ = 14° 09' 44" (RT) D = 8° 48' 02" R = 651.04' T = 80.87' L = 160.92' E = 5.00' e = ----- P.C. STA. = 7+13.52 P.T. STA. = 8+74.44	EXIST. CURVE 105 PI STA. = 13+70.77 Δ = 18° 41' 13" (RT) D = 2° 04' 52" R = 2,753.12' T = 452.99' L = 897.93' E = 37.02' e = ----- P.C. STA. = 9+17.78 P.T. STA. = 18+15.71
---	---

SECTION 12, T15N, R5W, 3rd PM

**29 GUARDRAIL REMOVAL**  
REM AND RE-ERECT RAIL ELEMENT OF EX GR  
TBT TYPE TYPE 1, SPECIAL (TANGENT)  
TRAFFIC BARRIER TERMINAL, TYPE 2  
TERMINAL MARKER - DIRECT APPLIED  
GUARDRAIL MARKERS, TYPE A

**RAMP 'A'**

EXIST. CURVE 101 PI STA. = 14+59.88 Δ = 52° 00' 07" (LT) D = 25° 20' 45" R = 226.06' T = 110.26' L = 205.17' E = 25.46' e = ----- P.C. STA. = 13+49.62 P.T. STA. = 15+54.79	EXIST. CURVE 102 PI STA. = 8+92.63 Δ = 38° 21' 00" (RT) D = 8° 18' 53" R = 689.09' T = 239.63' L = 461.23' E = 40.48' e = ----- P.C. STA. = 6+53.00 P.T. STA. = 11+14.23
---	--

**27 GUARDRAIL REMOVAL**  
REM AND RE-ERECT RAIL ELEMENT OF EX GR  
STEEL PLATE BEAM GUARDRAIL, TYPE A  
TBT TYPE TYPE 1, SPECIAL (TANGENT)  
TRAFFIC BARRIER TERMINAL, TYPE 2  
TERMINAL MARKER - DIRECT APPLIED  
GUARDRAIL MARKERS, TYPE A

**28 GUARDRAIL REMOVAL**  
REM AND RE-ERECT RAIL ELEMENT OF EX GR  
STEEL PLATE BEAM GUARDRAIL, TYPE A  
GUARDRAIL MARKERS, TYPE A

FENCE REPLACEMENT AND MOW SWATH  
SEE TYPICAL FENCE REPLACEMENT DETAIL SHEET# 156  
SEE SCHEDULE OF QUANTITIES

SEE HIGH TENSION CABLE DETAIL SHEET# 191  
HIGH TENSION CABLE MEDIAN BARRIER SYSTEM  
EXCAVATING AND GRADING EXISTING SHOULDER  
HOT-MIX ASPHALT SHOULDERS, 4"

**30 REM AND RE-ERECT RAIL ELEMENT OF EX GR**  
GUARDRAIL MARKERS, TYPE A

**LEGEND**

- ⊕ - GUARDRAIL SECTION - SEE SCHEDULES
- MOWING SWATH EDGE
- TREE REMOVAL LIMIT
- ▨ TRANSITION LOCATIONS  
SEE DETAIL SHEETS# 151-155
- ▨ VERTICAL CLEARANCE  
SEE DETAIL SHEET#157

**RAMP 'C'**

EXIST. CURVE 106 PI STA. = 5+45.71 Δ = 20° 33' 56" (RT) D = 13° 18' 34" R = 430.49' T = 78.10' L = 154.52' E = 7.03' P.C. STA. = 4+67.61 P.T. STA. = 6+22.13	EXIST. CURVE 107 PI STA. = 15+82.32 Δ = 154° 43' 25" (RT) D = 26° 36' 43" R = 215.30' T = 960.19' L = 581.40' E = 768.73' P.C. STA. = 6+22.13 P.T. STA. = 12+03.54
---	---

**RAMP 'D'**

EXIST. CURVE 108 PI STA. = 4+07.79 Δ = 58° 32' 56" (LT) D = 20° 14' 36" R = 283.04' T = 158.67' L = 289.23' E = 41.44' P.C. STA. = 2+49.12 P.T. STA. = 5+38.35	EXIST. CURVE 109 PI STA. = 9+96.44 Δ = 57° 30' 21" (RT) D = 13° 18' 44" R = 430.40' T = 236.16' L = 431.98' E = 60.53' P.C. STA. = 7+60.28 P.T. STA. = 11+92.26
---	--

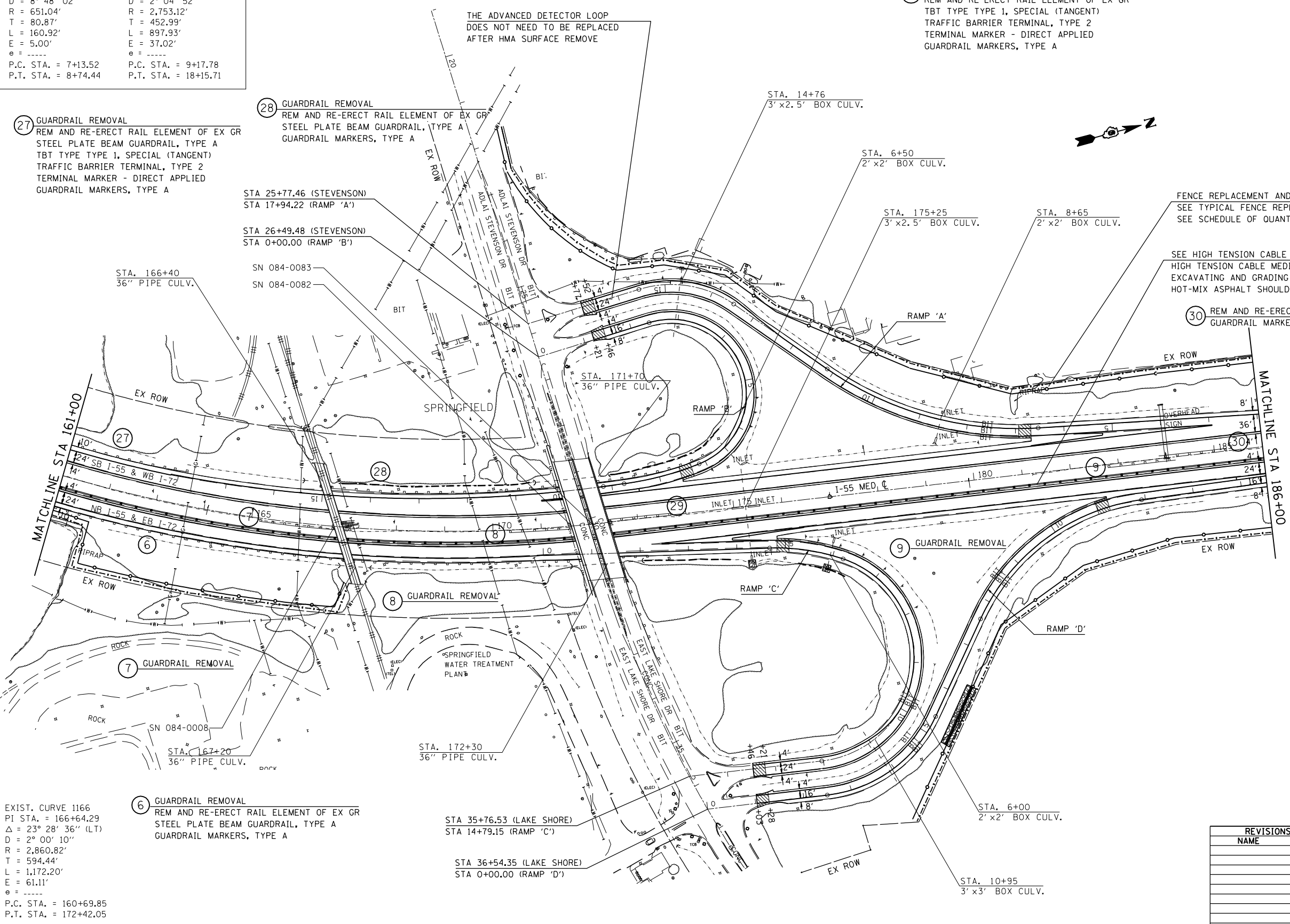

PLOT DATE = Oct-23-2007 09:52:31AM  
FILE NAME = c:\p\projects\4652882\plan\_6.dgn  
PLOT SCALE = 2117647 / IN  
USER NAME = laughlinr1

**REVISIONS**

NAME	DATE

ILLINOIS DEPARTMENT OF TRANSPORTATION  
**PLAN SHEET**  
FA155(I-55), FA172(I-72), FAP666(I-55 BUS)  
SECTION D6 INTERSTATE RS,BR,M CAB 2008  
SANGAMON COUNTY  
SCALE: 1" = 100'  
DATE \_\_\_\_\_ DRAWN BY TFC  
CHECKED BY \_\_\_\_\_