

F.A.I. RTE.	SECTION	COUNTY	TOTAL SHEETS	SHEET NO.
*	**	SANGAMON	248	111
STA.		TO STA.		
FED. ROAD DIST. NO.		ILLINOIS FED. AID PROJECT		
		* FA155(I-55), FA172(I-72), FAP666(I-55 BUS)		
		** D6 INTERSTATE RS,BR,M CAB 2008		

SECTION 25, T16N, R5W, 3rd PM

SECTION 30, T16N, R4W, 3rd PM

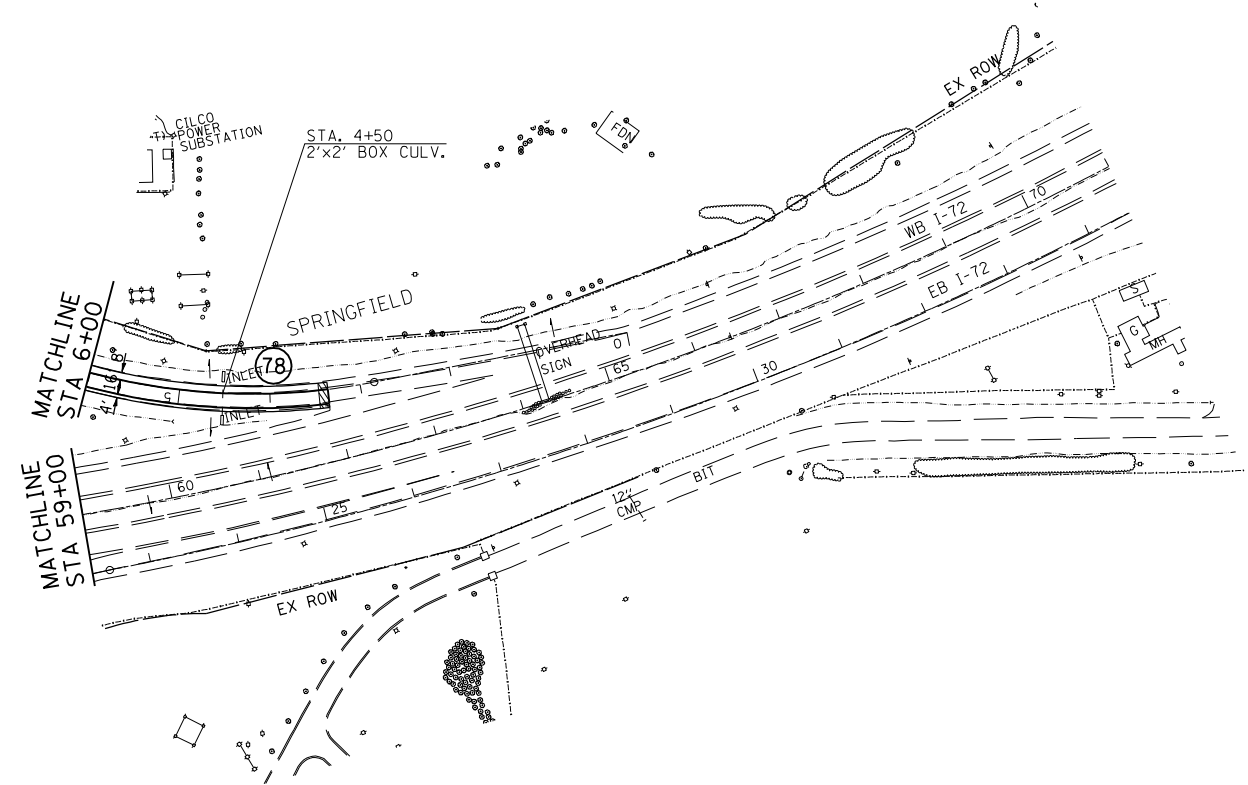
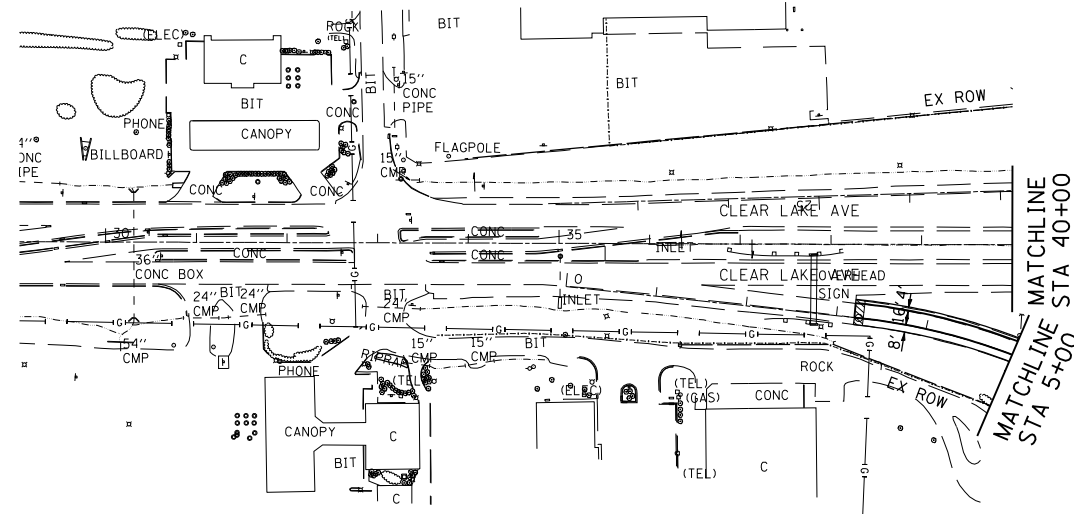

LEGEND

- TEMPORARY DITCH CHECKS
- INLET AND PIPE PROTECTION
- EROSION CONTROL BLANKET
- TEMP EROSION CONTROL SEEDING
- STONE RIPRAP
- DRAINAGE STRUCTURE NUMBER

CLEAR LAKE AVE

I-72

PLOT DATE = 08/22/2007 08:21:16AM
 FILE NAME = c:\p\projects\652882\sh\erosion3.dgn
 PLOT SCALE = 211.7647 / IN.
 USER NAME = laughlin-1

REVISIONS	
NAME	DATE

ILLINOIS DEPARTMENT OF TRANSPORTATION
 EROSION CONTROL AND
 DRAINAGE PLAN SHEETS
 FA155(I-55), FA172(I-72), FAP666(I-55 BUS)
 SECTION D6 INTERSTATE RS,BR,M CAB 2008
 SANGAMON COUNTY
 SCALE: 1" = 100'
 DATE _____ DRAWN BY TEC
 CHECKED BY _____

CLEAR LAKE AVE I-72