

**Existing Structure:**

The existing structure, built in 1963, is a three span plate girder bridge with spill-through abutments on steel piles and hammerhead piers on timber piles. 280'-3" back to back of abutments, 36'-0" out to out.

**Proposed Improvements:**

Work to be completed at this bridge includes: installation of permanent protective shield.

STATE OF ILLINOIS  
DEPARTMENT OF TRANSPORTATION

F.A.I. RTE.		SECTION	COUNTY	TOTAL SHEETS	SHEET NO.
*		**	SANGAMON	246	211
FED. ROAD DIST. NO.		ILLINOIS	FED. AID PROJECT		
* F.A.I. 55, F.A.I. 72, F.A.P. 666		** D6 Interstate R5, BR, M CAB 2008			

Sheet No. 1  
of 2 Sheets

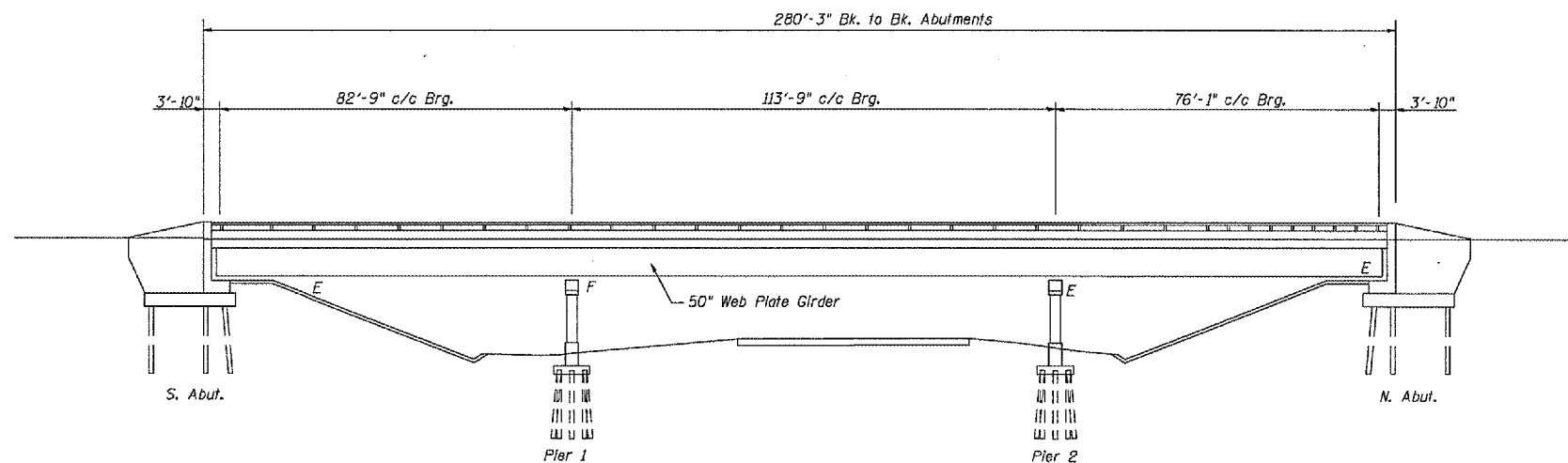

**ELEVATION**

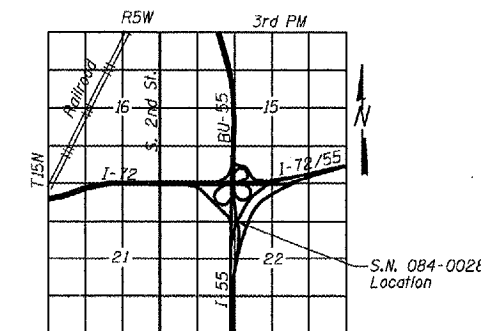

**LOCATION SKETCH**

**GENERAL NOTES**

- Plan dimensions and details relative to existing plans are subject to routine variations. The Contractor shall field verify existing dimensions and details affecting new construction and make necessary approved adjustments prior to construction or ordering of materials. Such variations shall not be cause for additional compensation for a change in scope of the work, however, the Contractor will be paid for the quantity actually furnished based upon the unit price bid for the work.
- The existing structural steel coating contains lead. The Contractor shall take appropriate precautions to deal with the presence of lead on this project.

**TOTAL BILL OF MATERIAL (S.N. 084-0028)**

Item	Unit	Quantity
Protective Shield (Permanent)	Sq. Yd.	178

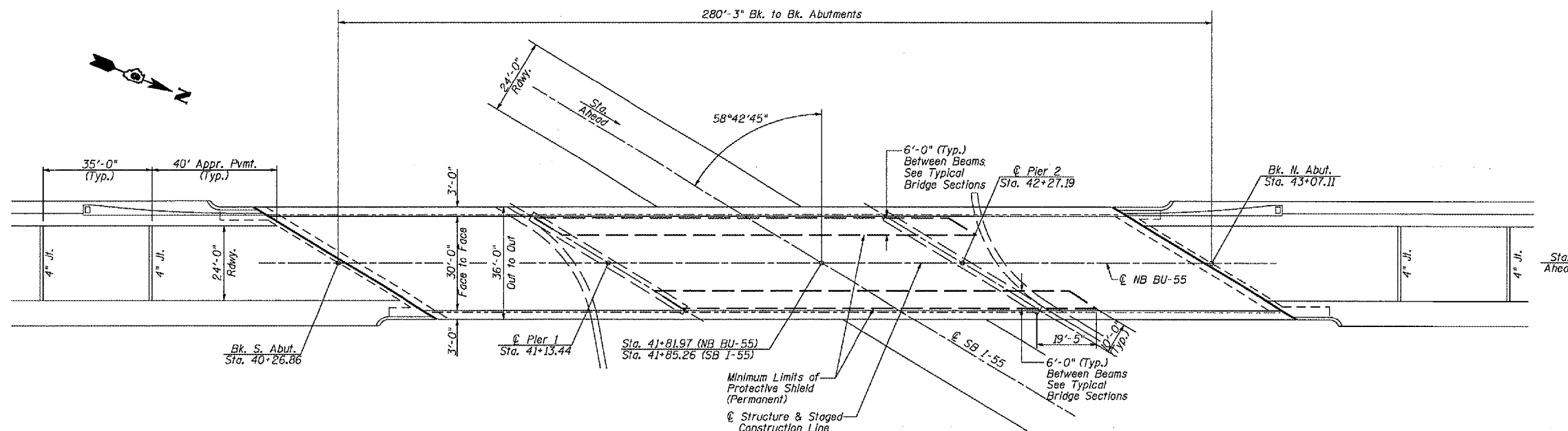

**PLAN**

**INDEX OF SHEETS**

- General Plan and Elevation
- Protective Shield Details

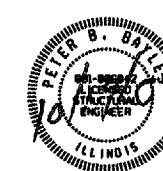

*Peter B. Bayles*  
Peter B. Bayles, P.E., S.E.  
Structural Engineer License No. 081-006042  
Expiration Date: 11/30/2008

**GENERAL PLAN & ELEVATION**  
F.A.I. 55, F.A.I. 72, F.A.P. 666  
Section D6 Interstate R5, BR, M CAB 2008  
Sangamon County  
NB BU-55 Over SB I-55  
S.N. 084-0028