

F.A.I. RTE.	SECTION	COUNTY	TOTAL SHEETS	SHEET NO.
*	**	SANGAMON	248	230
STA.		TO STA.		
FED. ROAD DIST. NO.		ILLINOIS FED. AID PROJECT		
* F.A.I. 55, F.A.I. 72, F.A.P. 666 ** D6 Interstate R5, BR, M CAB 2008				

HOT-MIX ASPHALT BASE COURSE WIDENING, 12"

STATION TO	STATION	SQ YD
663+34.69	673+12.11	1123
676+61.50	680+10.00	403
675+04.78	678+10.00	266
TOTAL		1792

PAVED SHOULDER REMOVAL

STATION TO	STATION	SQ YD
663+34.69	673+12.11	1029
676+61.50	680+10.00	403
675+04.78	678+10.00	266
TOTAL		1698

PAVEMENT MARKING REMOVAL

STATION TO	STATION	FOOT
663+10.00	673+13.13	250
663+10.00	673+13.13	1003
663+10.00	673+13.13	1003
670+95.79	673+13.13	217
675+04.78	680+10.00	505
675+04.78	680+10.00	130
675+04.78	680+10.00	505
675+04.78	678+10.00	307
676+61.50	678+43.73	182
TOTAL		4102

TEMPORARY PAVEMENT MARKING TAPE, TYPE 3

STATION TO	STATION	FOOT
663+10.00	680+10.00	430
663+10.00	680+10.00	1700
663+10.00	677+43.00	1433
675+05.00	677+57.00	64
677+57.00	680+10.00	253
677+57.00	678+44.00	87
TOTAL		3967

TEMPORARY CONCRETE BARRIER

STATION TO	STATION	FOOT
670+61.00	675+10.00	450

IMPACT ATTENUATORS, TEMPORARY (FULLY REDIRECTIVE, NARROW), TEST LEVEL 3

STATION	EACH
670+61.00	1

TEMPORARY RAISED REFLECTIVE MARKER

STATION TO	STATION	EACH
672+80.00	677+30.00	10

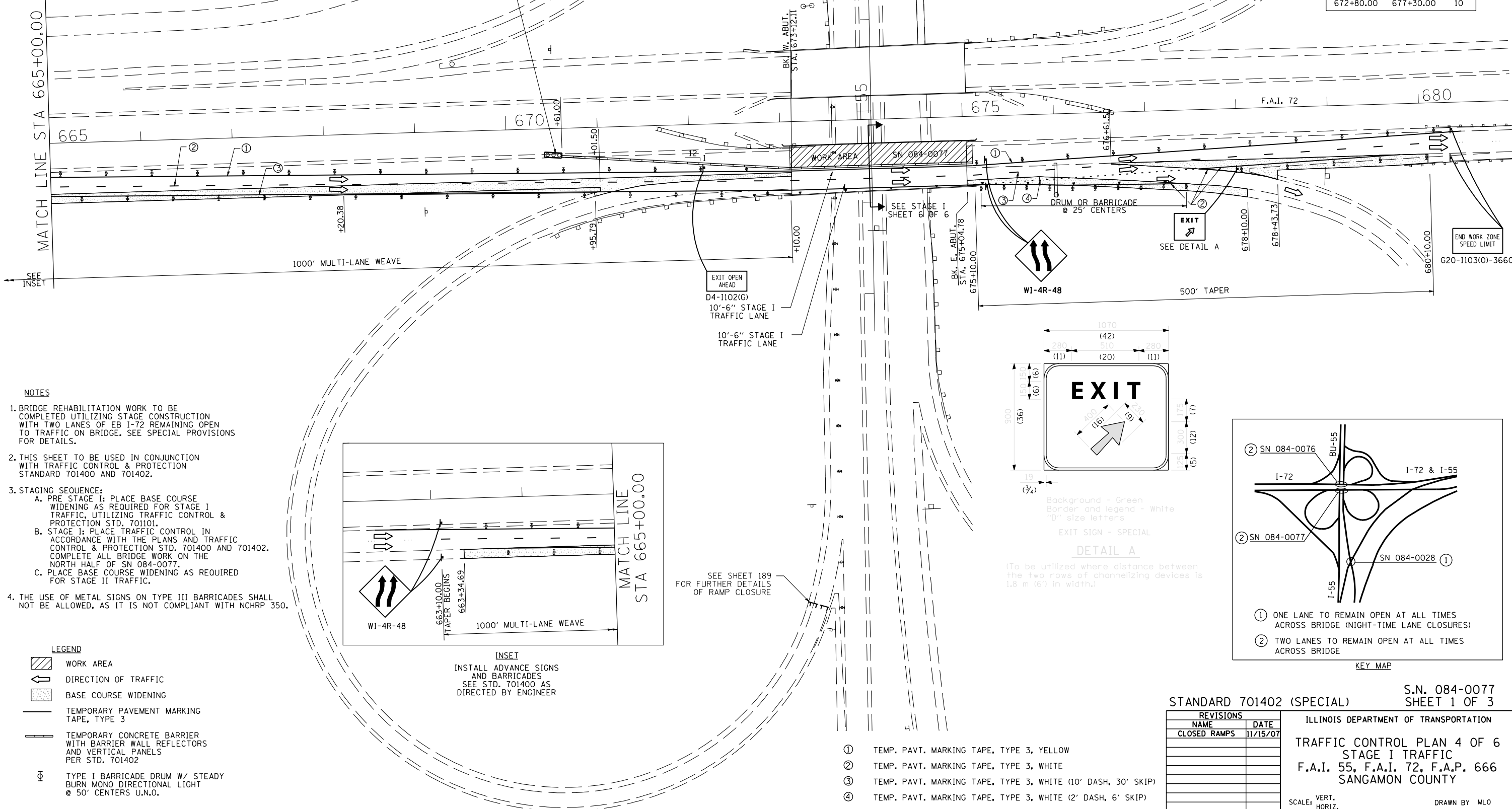
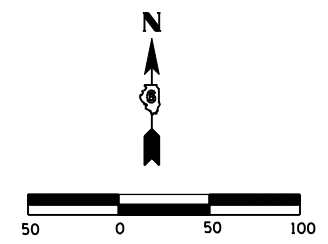

- NOTES**
- BRIDGE REHABILITATION WORK TO BE COMPLETED UTILIZING STAGE CONSTRUCTION WITH TWO LANES OF EB I-72 REMAINING OPEN TO TRAFFIC ON BRIDGE. SEE SPECIAL PROVISIONS FOR DETAILS.
  - THIS SHEET TO BE USED IN CONJUNCTION WITH TRAFFIC CONTROL & PROTECTION STANDARD 701400 AND 701402.
  - STAGING SEQUENCE:
    - PRE STAGE I: PLACE BASE COURSE WIDENING AS REQUIRED FOR STAGE I TRAFFIC, UTILIZING TRAFFIC CONTROL & PROTECTION STD. 701101.
    - STAGE I: PLACE TRAFFIC CONTROL IN ACCORDANCE WITH THE PLANS AND TRAFFIC CONTROL & PROTECTION STD. 701400 AND 701402. COMPLETE ALL BRIDGE WORK ON THE NORTH HALF OF SN 084-0077.
    - PLACE BASE COURSE WIDENING AS REQUIRED FOR STAGE II TRAFFIC.
  - THE USE OF METAL SIGNS ON TYPE III BARRICADES SHALL NOT BE ALLOWED, AS IT IS NOT COMPLIANT WITH NCHRP 350.

- LEGEND**
- WORK AREA
  - DIRECTION OF TRAFFIC
  - BASE COURSE WIDENING
  - TEMPORARY PAVEMENT MARKING TAPE, TYPE 3
  - TEMPORARY CONCRETE BARRIER WITH BARRIER WALL REFLECTORS AND VERTICAL PANELS PER STD. 701402
  - TYPE I BARRICADE DRUM W/ STEADY BURN MONO DIRECTIONAL LIGHT @ 50' CENTERS U.N.O.

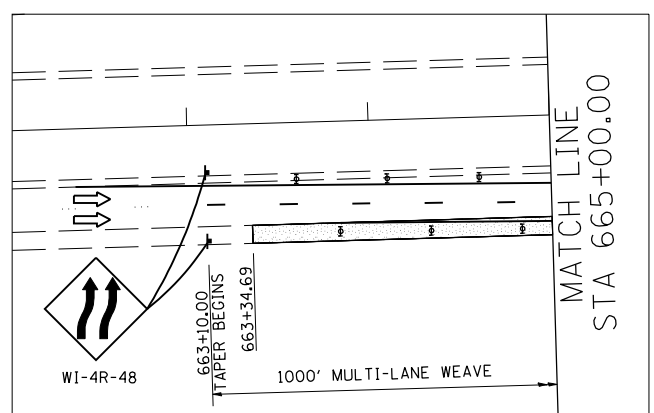

**INSET**  
INSTALL ADVANCE SIGNS AND BARRICADES SEE STD. 701400 AS DIRECTED BY ENGINEER

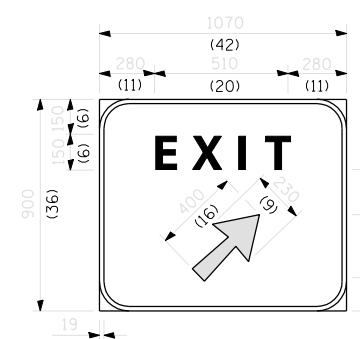

Background - Green  
Border and legend - White  
"0" size letters  
EXIT SIGN - SPECIAL  
**DETAIL A**  
(To be utilized where distance between the two rows of channelizing devices is 1.8 m (6') in width.)

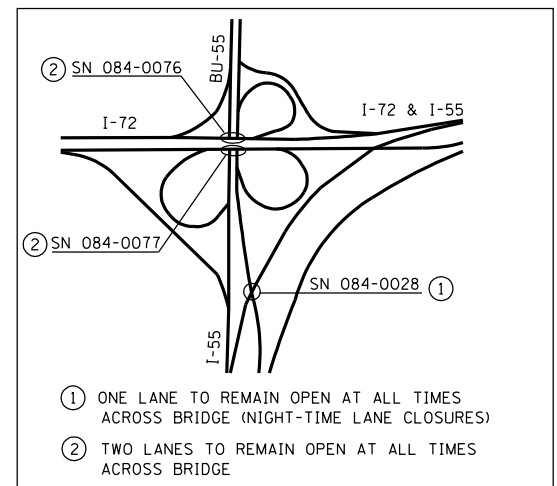

- ONE LANE TO REMAIN OPEN AT ALL TIMES ACROSS BRIDGE (NIGHT-TIME LANE CLOSURES)
- TWO LANES TO REMAIN OPEN AT ALL TIMES ACROSS BRIDGE

- TEMP. PAVT. MARKING TAPE, TYPE 3, YELLOW
- TEMP. PAVT. MARKING TAPE, TYPE 3, WHITE
- TEMP. PAVT. MARKING TAPE, TYPE 3, WHITE (10' DASH, 30' SKIP)
- TEMP. PAVT. MARKING TAPE, TYPE 3, WHITE (2' DASH, 6' SKIP)

STANDARD 701402 (SPECIAL) S.N. 084-0077 SHEET 1 OF 3

REVISIONS	
NAME	DATE
CLOSED RAMPS	11/15/07

ILLINOIS DEPARTMENT OF TRANSPORTATION  
TRAFFIC CONTROL PLAN 4 OF 6  
STAGE I TRAFFIC  
F.A.I. 55, F.A.I. 72, F.A.P. 666  
SANGAMON COUNTY

SCALE: VERT. HORIZ. DATE: 7/04  
DRAWN BY: MLO  
CHECKED BY: SJK