

F.A.P. RTE.	SECTION	COUNTY	TOTAL SHEETS	SHEET NO.
321	18(N-1,TS)	PIKE	55	15
STA.		TO STA.		
FED. ROAD DIST. NO.		ILLINOIS FED. AID PROJECT		

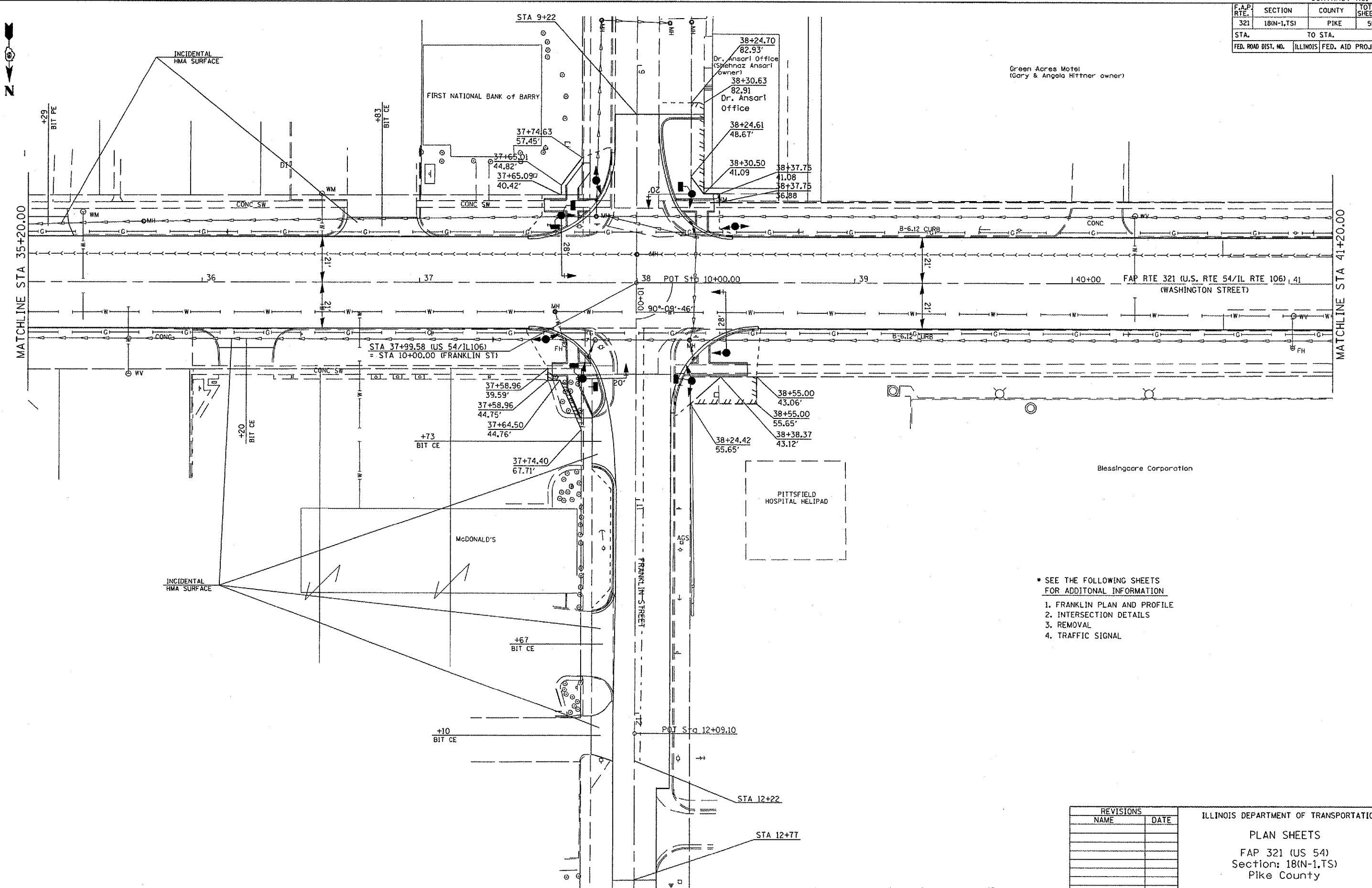

- SEE THE FOLLOWING SHEETS FOR ADDITIONAL INFORMATION
- 1. FRANKLIN PLAN AND PROFILE
- 2. INTERSECTION DETAILS
- 3. REMOVAL
- 4. TRAFFIC SIGNAL

REVISIONS	
NAME	DATE

ILLINOIS DEPARTMENT OF TRANSPORTATION
 PLAN SHEETS
 FAP 321 (US 54)
 Section: 18(N-1,TS)
 Pike County

SCALE: 1" = 20'
 DATE _____
 DRAWN BY _____
 CHECKED BY _____

Rev. Sheet 1-2-08

Plot Date: Dec-11-2007 07:43:55AM
 File Name: c:\projects\72933\18n-1\plan15.dgn
 Plot Scale: 1/2" = 20'
 User Name: baughman