

F.A.P. RTE.	SECTION	COUNTY	TOTAL SHEETS	SHEET NO.
315		MASON	11	1

*D-6 SHLDR RUMBLE STRIPS 2008-2

STATE OF ILLINOIS
DEPARTMENT OF TRANSPORTATION
DIVISION OF HIGHWAYS

**PROPOSED
HIGHWAY PLANS**

FOR INDEX OF SHEETS, SEE SHEET NO. 2

HIGHWAY CLASSIFICATION

F.A.P. Route 315 (US 136)
OTHER PRINCIPLE ARTERIAL

A.D.T.	- 1,850 (2008)	PV = 69.0%
A.D.T.	- 2,200 (2028)	SU = 6.0%
DESIGN SPEED	- 55 mph	MU = 25.0%
POSTED SPEED	- 55 mph	

F.A.P. ROUTE 315 (US 136)
SECTION D-6 SHLDR RUMBLE STRIPS 2008-2
PROJECT: ACHSIP-0315(052)
MASON COUNTY
C-96-107-07

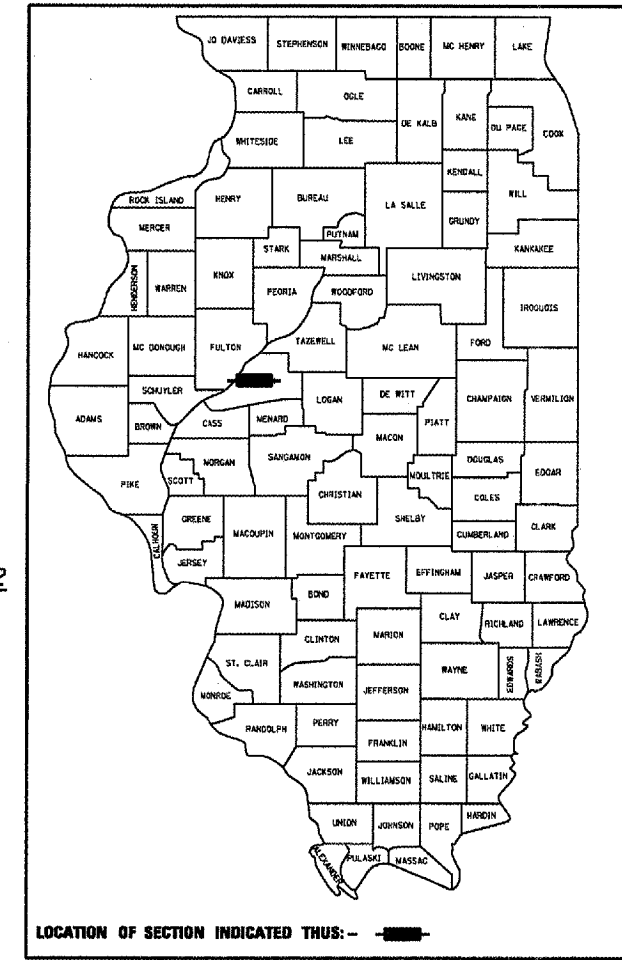

SECTION D-6 SHLDR RUMBLE STRIPS 2008-2
BEGINS AT STA. 572+65.00

SECTION D-6 SHLDR RUMBLE STRIPS 2008-2
ENDS AT STA. 641+68.50

SECTION D-6 SHLDR RUMBLE STRIPS 2008-2
BEGINS AT STA. 637+74.50

SIDE ROAD OMISSION (CH 4)
STA. 637+19.00 TO 637+74.50

SECTION D-6 SHLDR RUMBLE STRIPS 2008-2
ENDS AT STA. 637+19.00

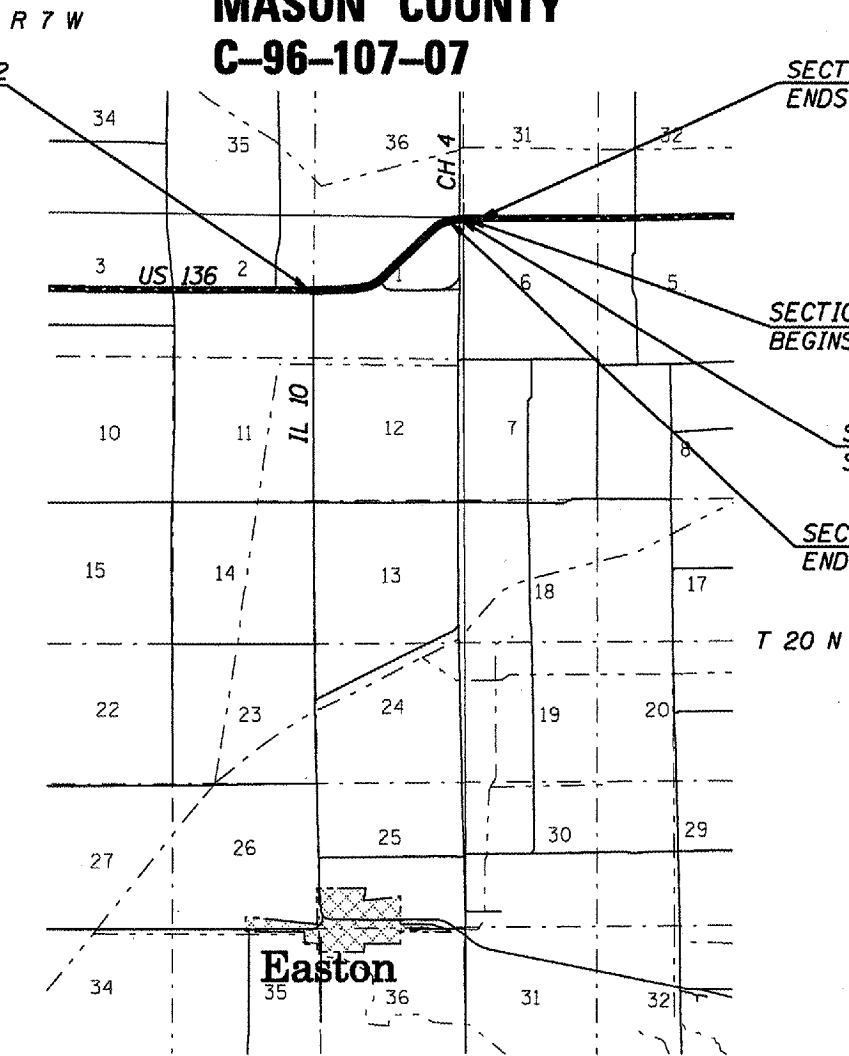

Easton

LOCATION MAP

GROSS LENGTH = 6,903.50 ft. = 1.31 mi.
NET LENGTH = 6,848.00 ft. = 1.30 mi.

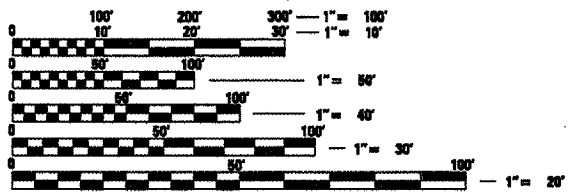

FULL SIZE PLANS HAVE BEEN PREPARED USING STANDARD
ENGINEERING SCALES. REDUCED SIZED PLANS WILL NOT
CONFORM TO STANDARD SCALES. IN MAKING MEASUREMENTS
ON REDUCED PLANS, THE ABOVE SCALES MAY BE USED.

J.U.L.I.E.
JOINT UTILITY LOCATION INFORMATION FOR EXCAVATION
1-800-892-0123

CONTRACT NO. 72B30

STATE OF ILLINOIS
DEPARTMENT OF TRANSPORTATION
DIVISION OF HIGHWAYS

SUBMITTED Dec 10 20 07

[Signature]
DEPUTY DIRECTOR OF HIGHWAYS, REGION ENGINEER

Dec 7 20 07
[Signature]
INTERIM ENGINEER OF DESIGN AND ENVIRONMENT

Dec 7 20 07
[Signature]
DIRECTOR OF HIGHWAYS, CHIEF ENGINEER

**PRINTED BY THE AUTHORITY
OF THE STATE OF ILLINOIS**

PROJECT ENGINEER: SAL MADONIA (217) 782-4761
SQUAD LEADER: RENE CABRERA (217) 557-9062
JONATHAN COX