

FAP RTE.	SECTION	COUNTY	TOTAL SHEETS	SHEET NO.
662	H(B-2)I	SANGAMON	5	1

STATE OF ILLINOIS  
DEPARTMENT OF TRANSPORTATION  
DIVISION OF HIGHWAYS

**PROPOSED  
HIGHWAY PLANS**

FAP 662 (IL RTE. 4)  
SECTION H(B-2)I

SANGAMON COUNTY  
C-96-107-08

**INDEX OF SHEETS:**

- 1 COVER SHEET
- 2 GENERAL NOTES
- 3 SUMMARY OF QUANTITIES
- 4, 5 STRUCTURAL PLANS

**HIGHWAY STANDARDS**

- 000001-05
- 701101-01
- 701106-01
- 701901

D-96-007-08



LOCATION OF SECTION INDICATED THUS: —

**PROJECT LOCATION**  
S.N. 084-0172  
IL RTE. 4 OVER POLECAT CREEK

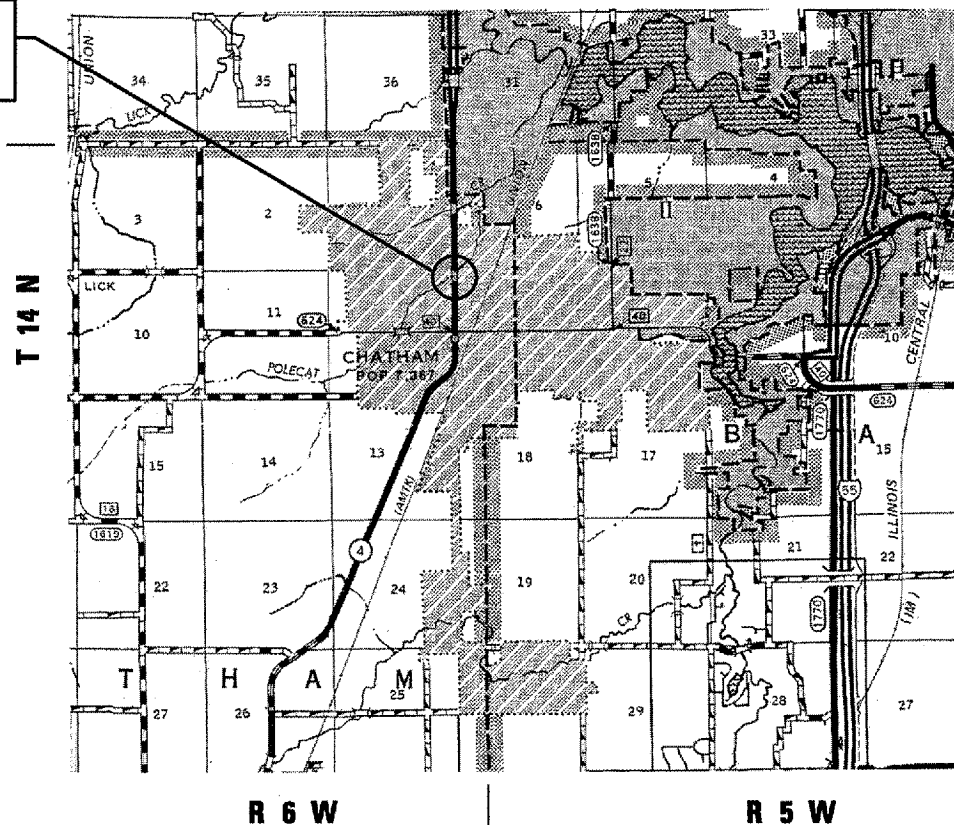

**LOCATION MAP**

A.D.T. = 15,800 (YEAR 2007)

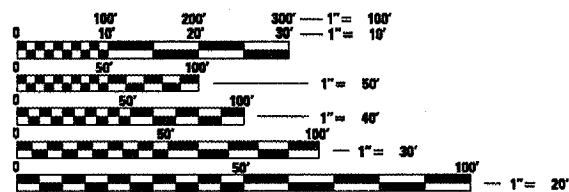

FULL SIZE PLANS HAVE BEEN PREPARED USING STANDARD ENGINEERING SCALES. REDUCED SIZED PLANS WILL NOT CONFORM TO STANDARD SCALES. IN MAKING MEASUREMENTS ON REDUCED PLANS, THE ABOVE SCALES MAY BE USED.

J.U.L.I.E.  
JOINT UTILITY LOCATION INFORMATION FOR EXCAVATION  
1-800-892-0123

CONTRACT NO. 72B51

STATE OF ILLINOIS  
DEPARTMENT OF TRANSPORTATION  
DIVISION OF HIGHWAYS

SUBMITTED *Oct 3, 2007*

*Christine M. Reed*  
DEPUTY DIRECTOR OF HIGHWAYS, REGION ENGINEER

*Dec 7, 2007*  
*Eric E. Hamm*  
INTERIM ENGINEER OF DESIGN AND ENVIRONMENT

*Dec 7, 2007*  
*Christine M. Reed*  
DIRECTOR OF HIGHWAYS, CHIEF ENGINEER

**PRINTED BY THE AUTHORITY  
OF THE STATE OF ILLINOIS**

PROJECT ENGINEER: SAL MADONIA (217) 782-4761  
SQUAD LEADER: MARCUS BRUCE (217) 524-0946

Rev.