

FOR INDEX OF SHEETS AND HIGHWAY
STANDARDS, SEE SHEET 2.

STATE OF ILLINOIS
DEPARTMENT OF TRANSPORTATION
DIVISION OF HIGHWAYS
**PLANS FOR PROPOSED
D.E. MISCELLANEOUS
FAP ROUTE 310 (U.S. 67)
SECTION 69-12I
MORGAN COUNTY
C96-017-08 / D96-017-08**

CONTRACT: 72B59
SHEET 1 OF 9

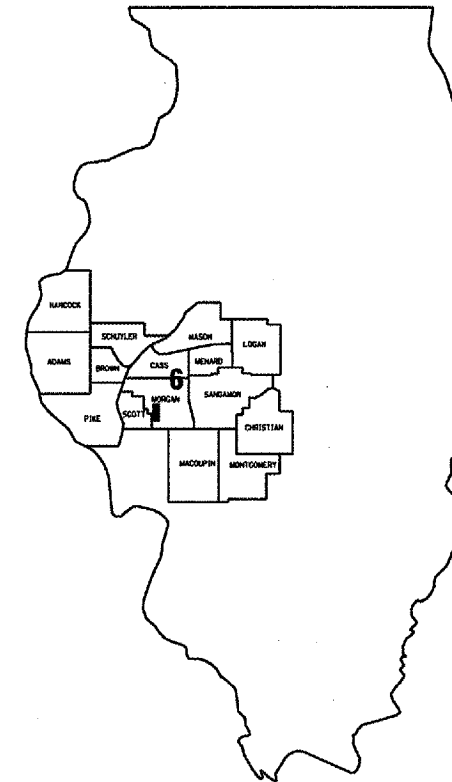

LOCATION OF SECTION INDICATED THUS: ■

PROJECT LOCATION
U.S. 67 & BIRDSSELL RD.

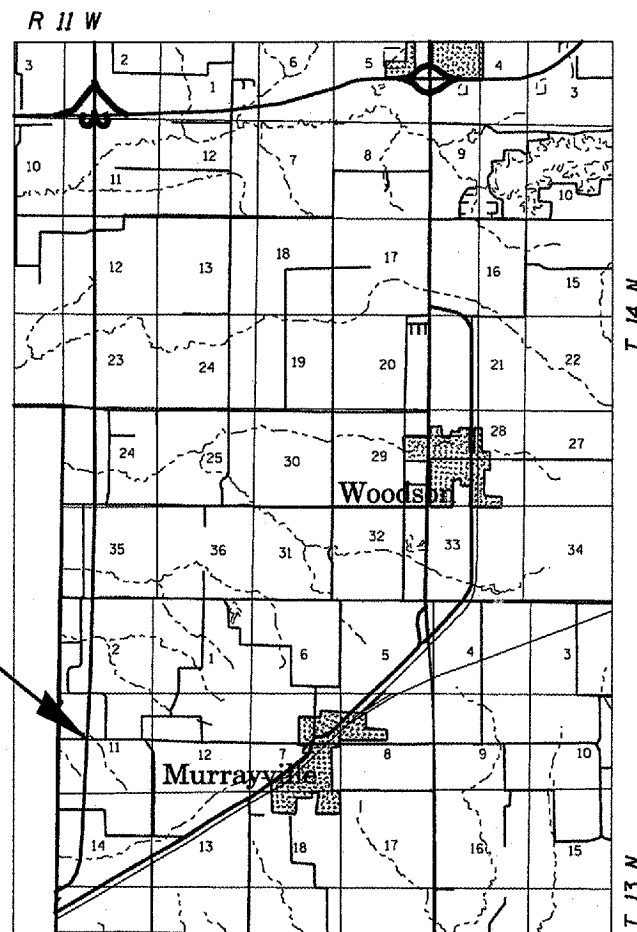

J. U. L. I. E.
JOINT UTILITY LOCATION INFORMATION FOR EXCAVATION
1-800-892-0123

PLANS & CONTRACT TECHNICIAN: TIMOTHY SHARP
PHONE: (217) 782-7743

NET LTH OF SEC 761.00 FT = 0.144 MILE



SCALE: 1" = 2 MILES

STATE OF ILLINOIS
DEPARTMENT OF TRANSPORTATION
DIVISION OF HIGHWAYS

SUBMITTED Oct 3 20 07

W. M. Beedum
DEPUTY DIRECTOR OF HIGHWAYS, REGION FOUR ENGINEER

December 7, 20 07
Eric E. Harrel
Interim ENGINEER OF DESIGN AND ENVIRONMENT

December 7, 20 07
Christine M. Reed
DIRECTOR, DIVISION OF HIGHWAYS

CONTRACT NO. 72B59

PRINTED BY AUTHORITY OF THE STATE OF ILLINOIS