

F.A.U. R.T.E.	SECTION	COUNTY	TOTAL SHEETS	SHEET NO.
9269	65BR	MONROE	22	20
STA. 26+50.00		TO STA. 26+84.31		
FED. ROAD DIST. NO. 8 ILLINOIS FED. AID PROJECT				

FINAL SURVEY	DATE
SURVEY	BY
NOTE BOOK	
AREAS CHECKED	

ORIGINAL SURVEY	DATE
SURVEY	BY
NOTE BOOK	
AREAS CHECKED	

PLOT DATE = #DATE#  
 FILE NAME = #FILE#  
 PLOT SCALE = #SCALE#  
 USER NAME = #USER#

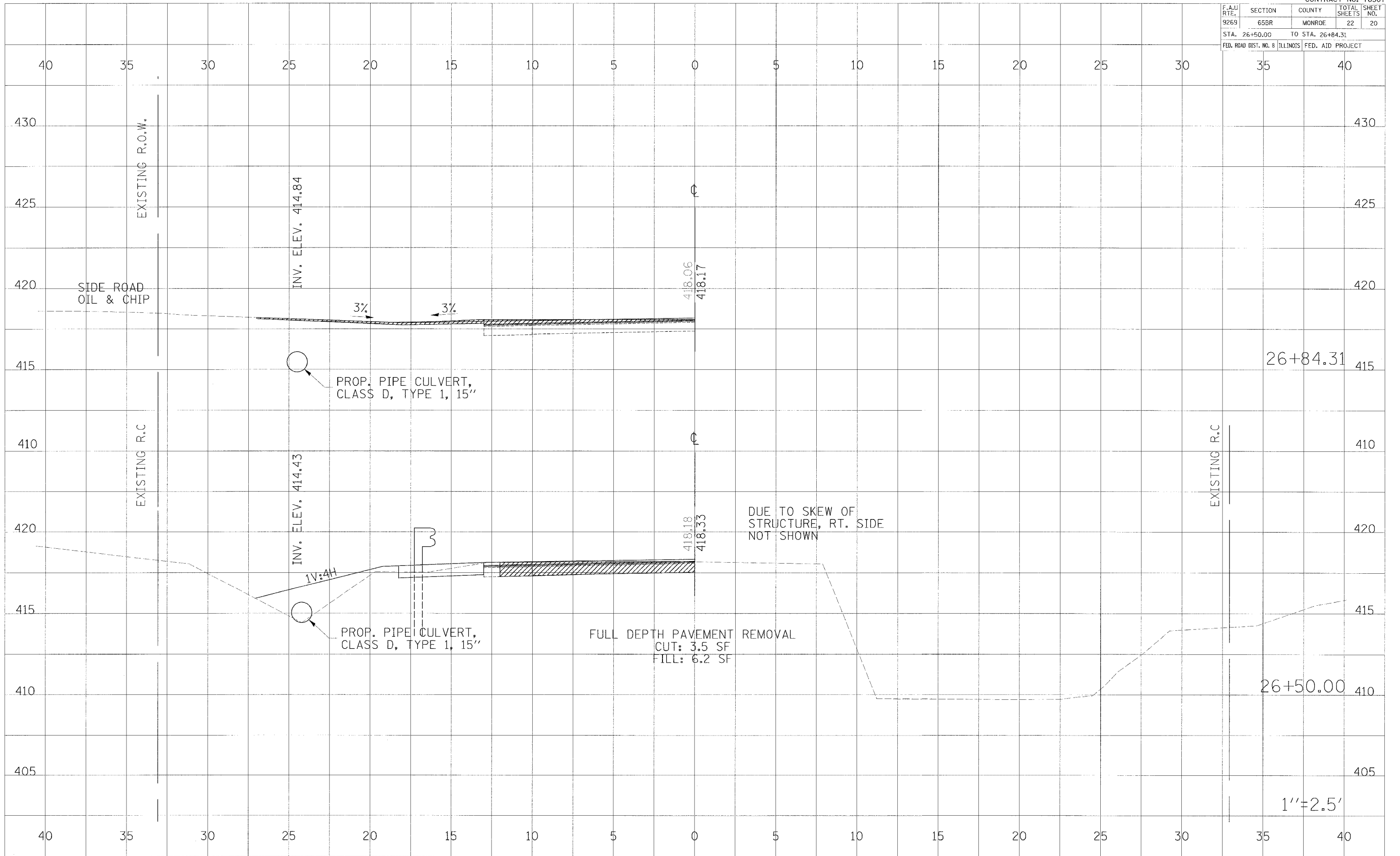

1"=2.5'