

SE 1/4, SEC. 24, T 6 N, R 10 W, 3RD P.M.

F.A.P. RTE.	SECTION	COUNTY	TOTAL SHEETS	SHEET NO.
310	60-15HB	MADISON	185	58
STA. 10+250		TO STA. 10+564.500		
FED. ROAD DIST. NO. 8		ILLINOIS FED. AID PROJECT		
CONTRACT NO. 76626				

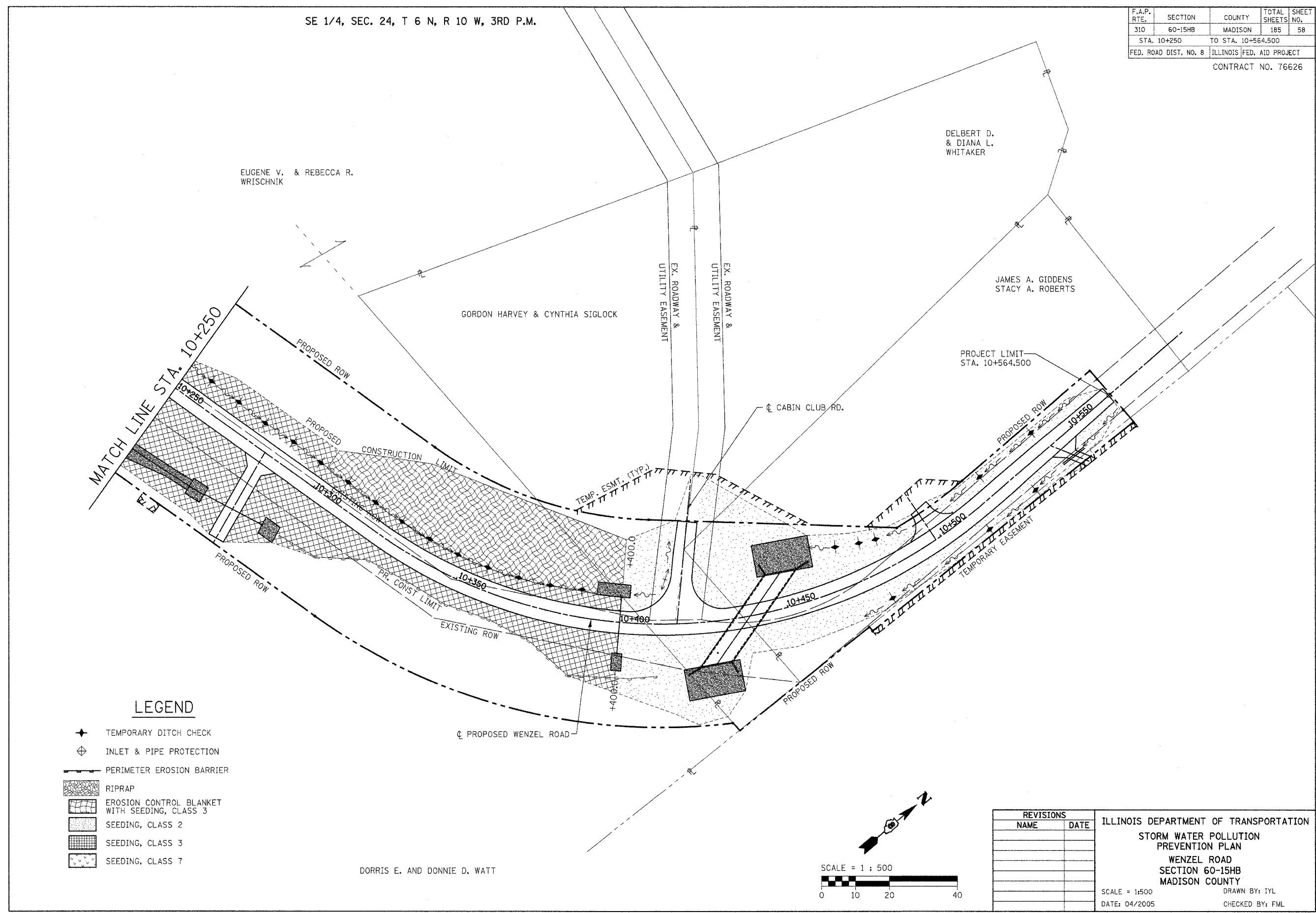

**LEGEND**

- ◆ TEMPORARY DITCH CHECK
- ⊕ INLET & PIPE PROTECTION
- PERIMETER EROSION BARRIER
- ▨ RIPRAP
- ▩ EROSION CONTROL BLANKET WITH SEEDING, CLASS 3
- ▧ SEEDING, CLASS 2
- ▦ SEEDING, CLASS 3
- ▥ SEEDING, CLASS 7

DORRIS E. AND DONNIE D. WATT

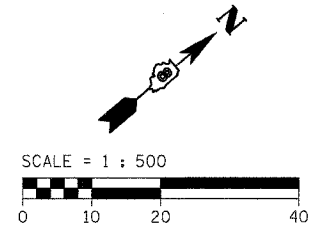

REVISIONS	
NAME	DATE

ILLINOIS DEPARTMENT OF TRANSPORTATION  
 STORM WATER POLLUTION PREVENTION PLAN  
 WENZEL ROAD  
 SECTION 60-15HB  
 MADISON COUNTY  
 SCALE = 1:500  
 DATE: 04/2005  
 DRAWN BY: IYL  
 CHECKED BY: FML

STORM WATER POLLUTION PREVENTION PLAN - WENZEL ROAD - STA. 10+250 TO STA. 10+564.500