

STATE OF ILLINOIS
DEPARTMENT OF TRANSPORTATION

ROUTE NO.	SECTION	COUNTY	STATE	SHEET NO.	SHEET NO. 9 25 SHEETS
F.A.P. 776	(116BR-1)	HAMILTON	140	28	
FED. ROAD DIST. NO. 7	ILLINOIS	FED. AID PROJECT			

Contract #78006

EAST CURB LINE

Location	Station	Offset	Theoretical Grade Elevations	Theoretical Grade Elevations Adjusted For Dead Load Deflection
End of N. Approach Pvmt.	515+89.21	-16.000	373.062	
A	515+99.21	-16.000	373.118	
B	516+09.21	-16.000	373.168	
Bk. N. Abutment	516+19.21	-16.000	373.210	

EAST EDGE OF PAVEMENT

Location	Station	Offset	Theoretical Grade Elevations	Theoretical Grade Elevations Adjusted For Dead Load Deflection
End of N. Approach Pvmt.	515+87.47	-12.000	373.134	
A	515+97.47	-12.000	373.192	
B	516+07.47	-12.000	373.243	
Bk. N. Abutment	516+17.47	-12.000	373.287	

☉ ROADWAY & P.G.

Location	Station	Offset	Theoretical Grade Elevations	Theoretical Grade Elevations Adjusted For Dead Load Deflection
End of N. Approach Pvmt.	515+82.25	0.000	373.289	
A	515+92.25	0.000	373.350	
B	516+02.25	0.000	373.405	
Bk. N. Abutment	516+12.25	0.000	373.452	

WEST EDGE OF PAVEMENT

Location	Station	Offset	Theoretical Grade Elevations	Theoretical Grade Elevations Adjusted For Dead Load Deflection
End of N. Approach Pvmt.	515+77.03	12.000	373.067	
A	515+87.03	12.000	373.132	
B	515+97.03	12.000	373.190	
Bk. N. Abutment	516+07.03	12.000	373.241	

WEST CURB LINE

Location	Station	Offset	Theoretical Grade Elevations	Theoretical Grade Elevations Adjusted For Dead Load Deflection
End of N. Approach Pvmt.	515+75.29	16.000	372.971	
A	515+85.29	16.000	373.038	
B	515+95.29	16.000	373.097	
Bk. N. Abutment	516+05.29	16.000	373.149	

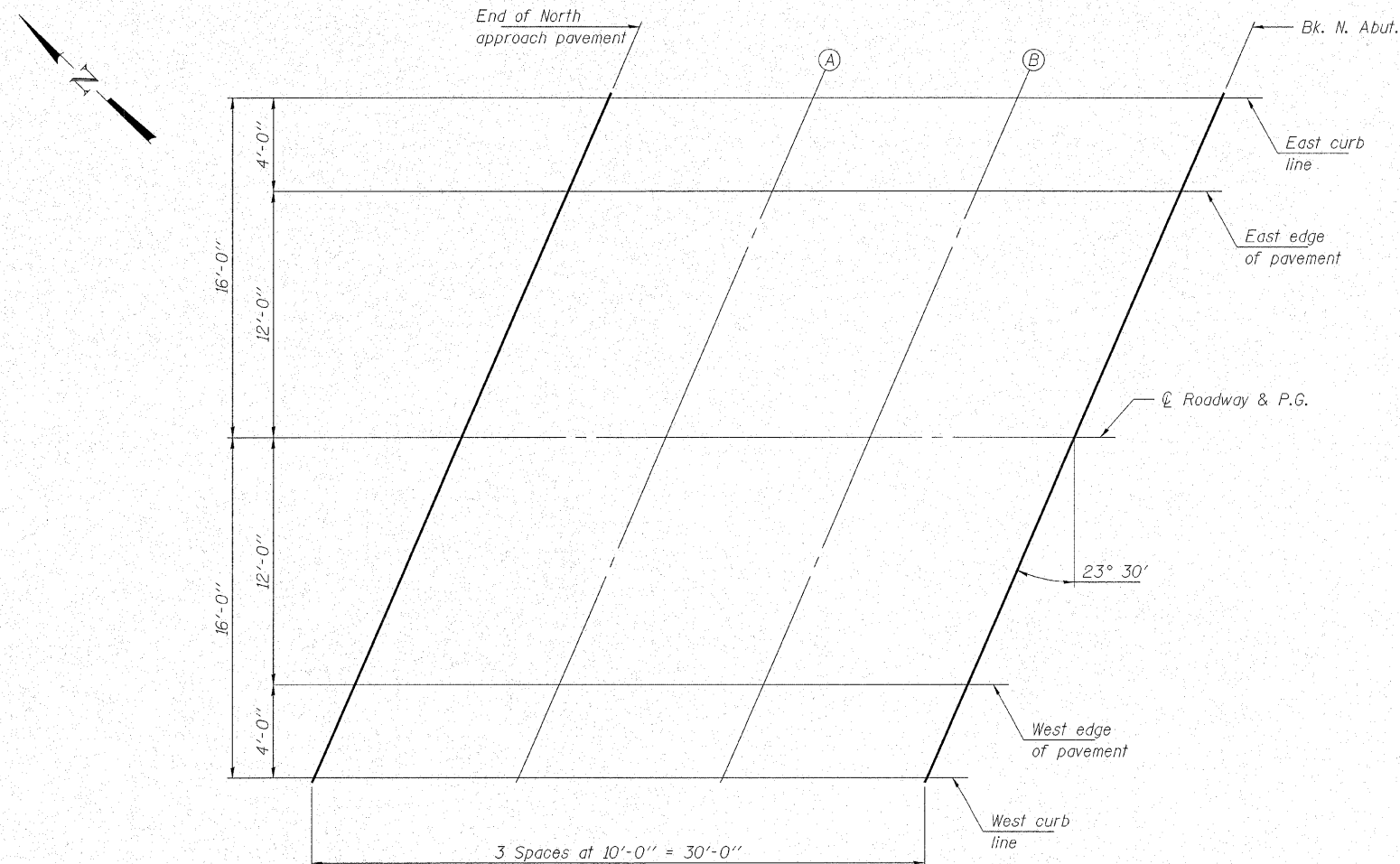

PLAN

PLOT DATE: 10/26/2007 FILE NAME: 0330051-78006-41021br1dgn0050.dgn

HAMPTON, LENZINI & RENWICK, INC.
CIVIL & STRUCTURAL ENGINEERS
LAND SURVEYORS

3085 STEVENSON DRIVE, SUITE 201
SPRINGFIELD, ILLINOIS 62703
(217) 546-3400

ELGIN • SPRINGFIELD

PROJECT NUMBER: 12-41-0021-1 DATE: 10/25/07
DESIGNED: P.L. CHECKED: S.W.M. DRAWN: D.T.M.

**TOP OF NORTH APPROACH
SLAB ELEVATIONS**
IL ROUTE 142 OVER CONTRARY CREEK
F.A.P. ROUTE 776 - SECTION (116BR-1)B-1
HAMILTON COUNTY
STRUCTURE NO. 033-0050 / STATION 516+75