

F.A.P.	SECTION	COUNTY	TOTAL SHEETS	SHEET NO.
776	(116BR-3)B-1	HAMILTON	140	134
STA. 539+50.00		TO STA. 540+00.00		
FED. ROAD DIST. NO.	ILLINOIS	FED. AID PROJECT		
65	70	75	80	

BY	DATE
FINAL SURVEY	
SURVEYED	
PLOTTED	
NOTE BOOK	
AREAS CHECKED	
NO.	

BY	DATE
ORIGINAL SURVEY	
SURVEYED	
PLOTTED	
NOTE BOOK	
AREAS CHECKED	
NO.	

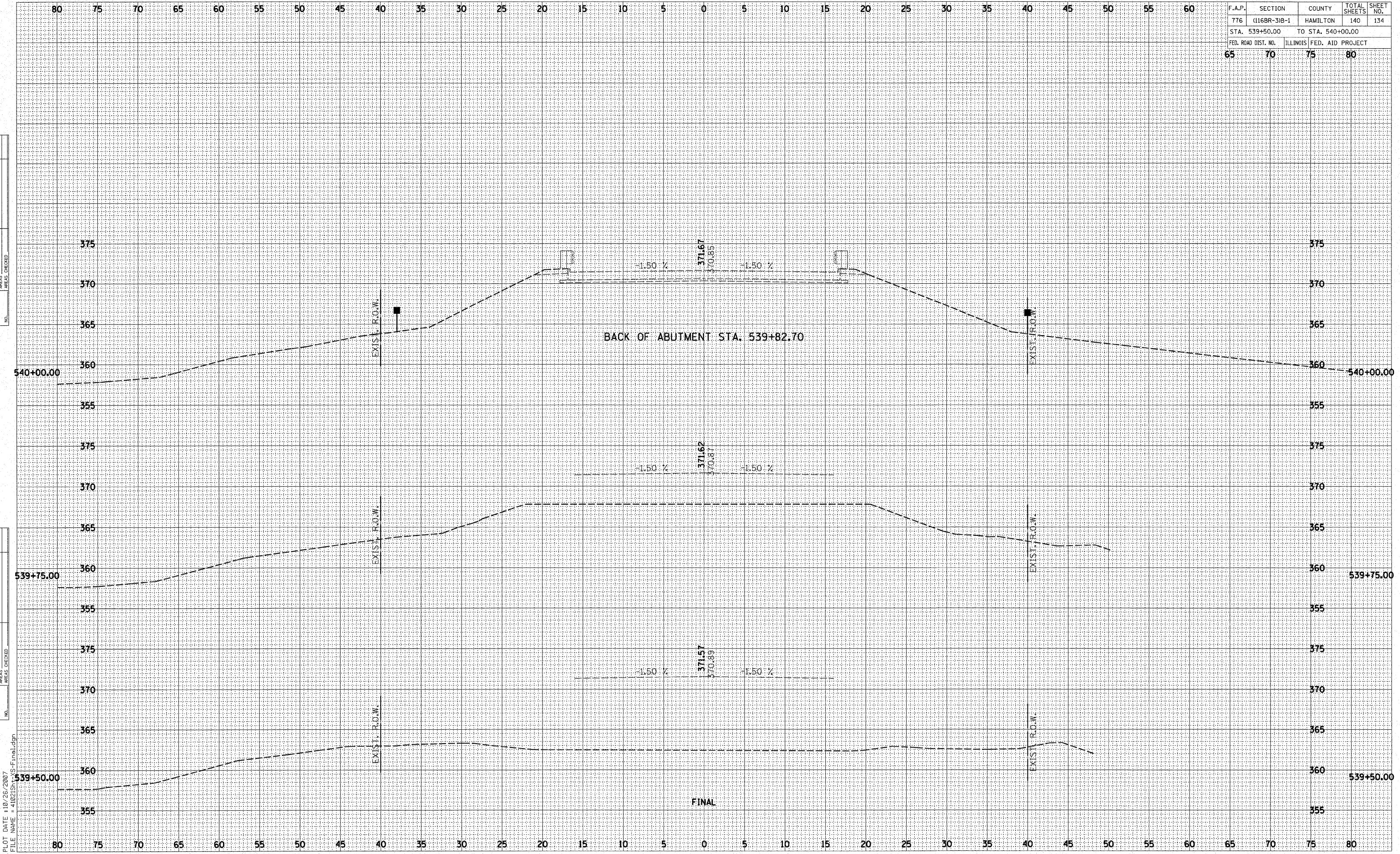

PLOT DATE: 10/26/2007  
 FILE NAME: 41021SH134S-Final.dgn