

STATE OF ILLINOIS
DEPARTMENT OF TRANSPORTATION

ROUTE NO.	SECTION	COUNTY	POST MILE	SHEET NO.
F.A.P. 778	3BR-1	HARDIN	69	22
FED. ROAD DIST. NO. 7		ILLINOIS	FED. AID PROJECT	

Contract #78023

SHEET NO. 12

14 SHEETS

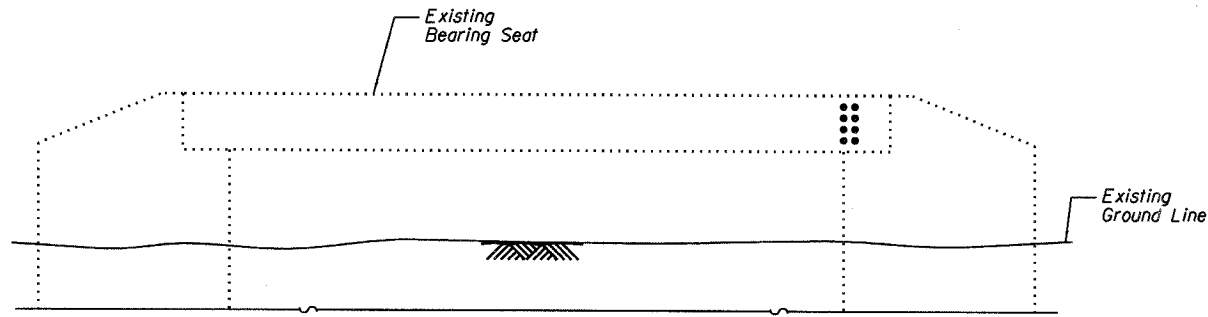

ELEVATION - WEST ABUTMENT
(Looking Northwest)

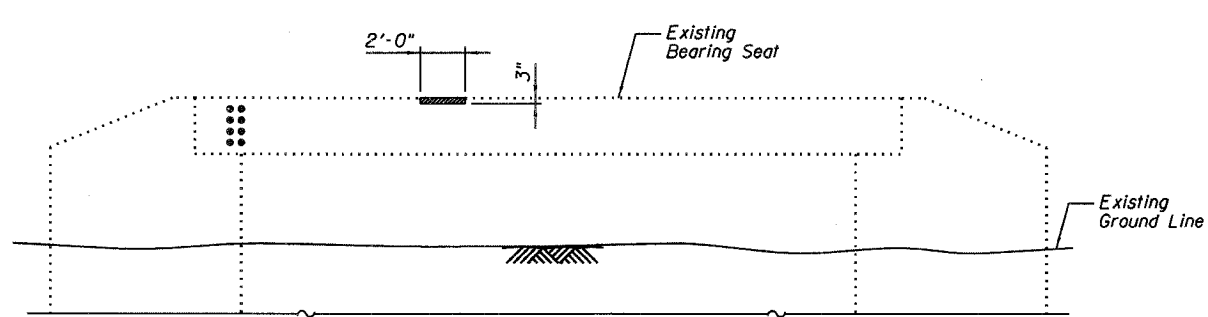

ELEVATION - EAST ABUTMENT
(Looking Southeast)

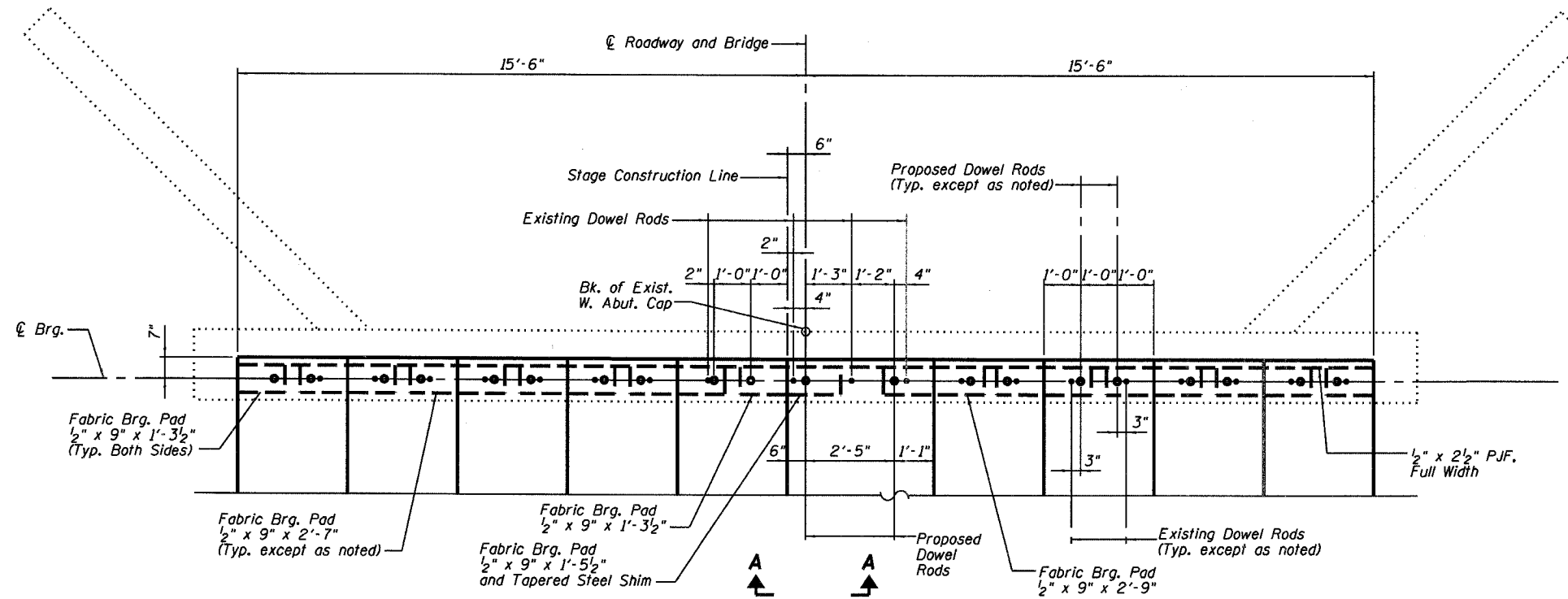

PLAN - WEST ABUTMENT BEARING SEAT
(West Abutment shown, East Abutment similar)

Concrete wearing surface and existing approach pavement not shown for clarity.

LEGEND

- ▨ Structural Repair of Concrete (Depth equal to or less than 5")
- Existing Dowel Rod/Pre-stage I Shoring Dowel Rods
- Proposed Dowel Rod

Notes:
Existing and Pre-stage I dowel bars shall be burned off flush with the existing concrete face, ground smooth, and sealed with epoxy. Cost is included with Removal of Existing Superstructures. Concrete sealer shall be applied to concrete repair areas. See Sheet No. 13 of 14 for Substructure Repair Bill of Material.

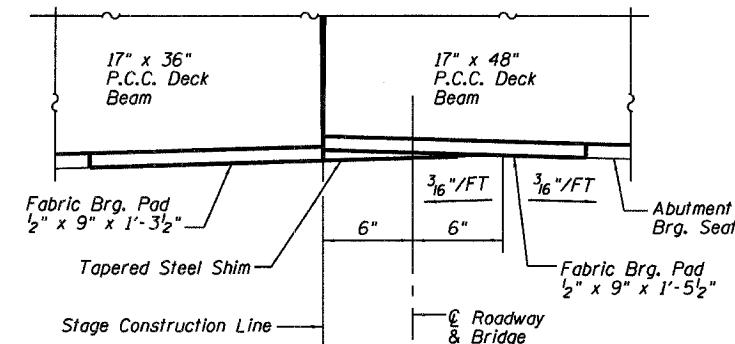

SECTION A-A

ABUTMENT REPAIRS
ILL. ROUTE 34 OVER PINHOOK CREEK
F.A.P. ROUTE 778 SECTION 3BR-1
HARDIN COUNTY
STATION 806+15.00
STRUCTURE NO. 035-0005



DESIGNED	RLM
CHECKED	MEL
DRAWN	AEC
CHECKED	RLM

10/04/07