

Bench Mark 3507538: Existing railroad spike in power pole. Station 1025+22, right of centerline. Elevation 425.70

Bench Mark #1: Chiseled square in bridge deck, southwest corner of SN 035-0008. Elevation 421.42

Existing Structure: The original single span structure was built in 1923 with a reinforced concrete through girder on reinforced concrete closed abutments with a length of 38'-0" back-to-back of abutments. The structure was widened in 1978. The superstructure was replaced with P.P.C. deck beams with a total width of 31'-0" out-to-out of superstructure and the substructure was modified accordingly.

Proposed Improvements: The existing superstructure is to be replaced with P.P.C. deck beams and a 5" concrete overlay. Minor substructure repairs are required. Traffic to be maintained at all times utilizing stage construction.

Salvage: Shoring material is to be stockpiled according to the Special Provisions after removal.

STATE OF ILLINOIS
DEPARTMENT OF TRANSPORTATION

ROUTE NO.	SECTION	COUNTY	DATE SHEETS	SHEET NO.	SHEET NO. 1
F.A.P. 778	4BR-1	HARDIN	69	46	12 SHEETS
FED. ROAD DIST. NO. 7	ILLINOIS	FED. AID PROJECT			

Contract #78023

STATION 1021+80.00
REBUILT 200_ BY
STATE OF ILLINOIS
F.A.P. RT. 778 SEC. 4BR-1
LOADING HS20
STR. NO. 035-0008

NAME PLATE
See Std. 515001

Note: Locate name plate at outside face of top steel railing tube at northwest corner of bridge.

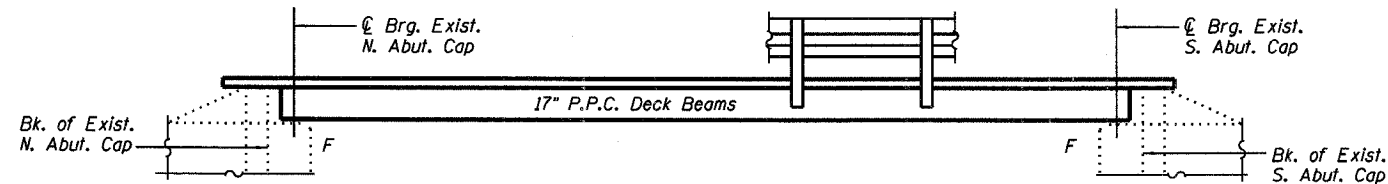

ELEVATION

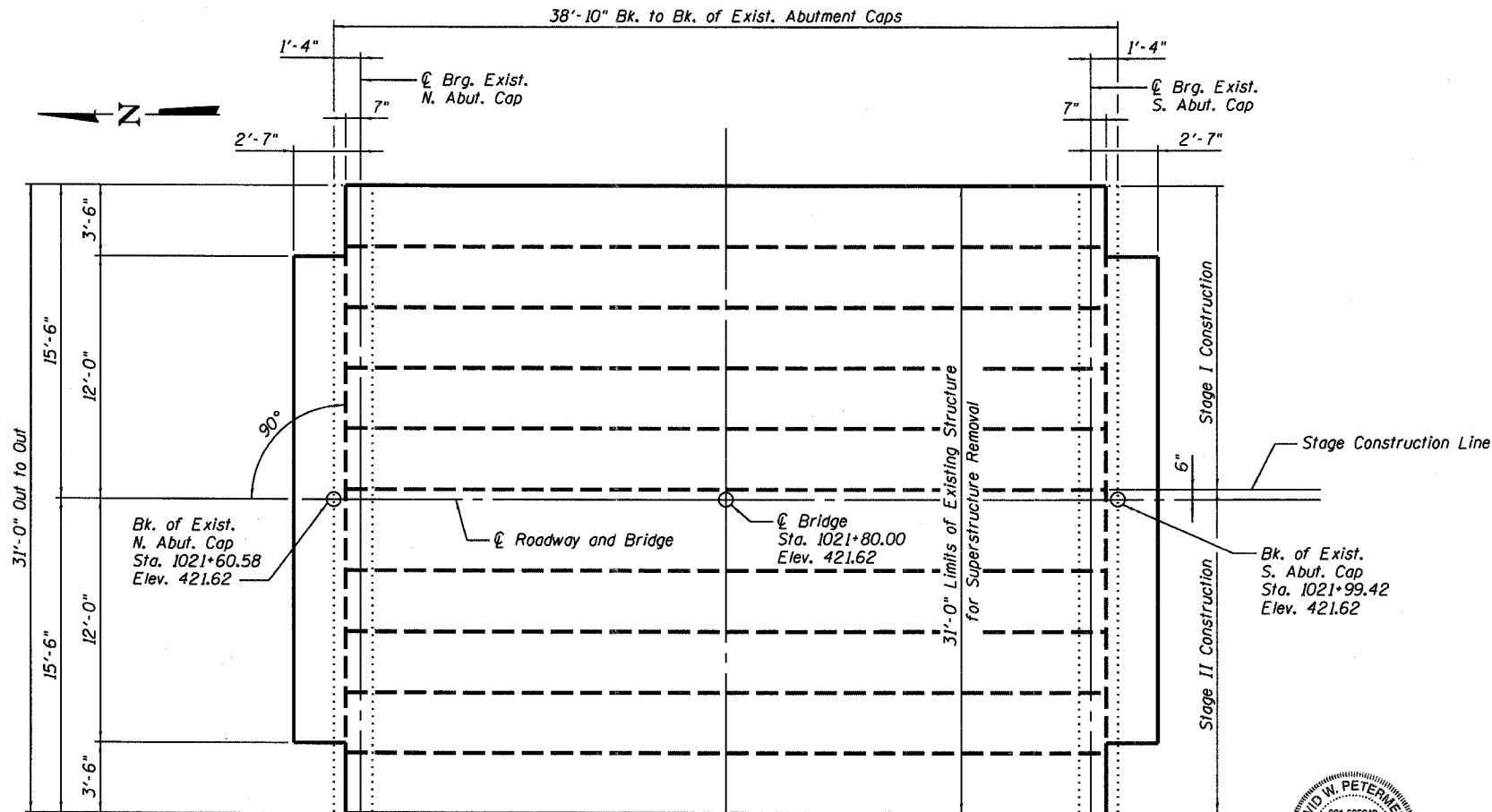

PLAN

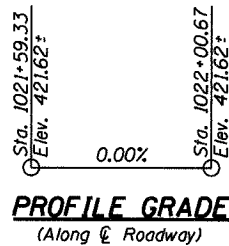

PROFILE GRADE
(Along \bar{C} Roadway)

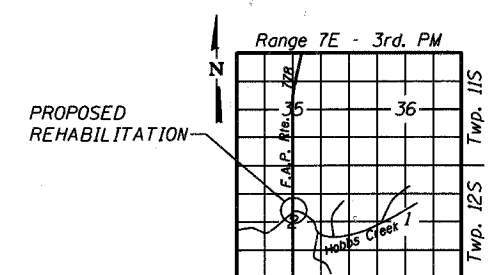

LOCATION SKETCH

DESIGN SPECIFICATIONS
2002 AASHTO Standard Specifications
for Highway Bridges

LOADING HS20-44
No allowance for Future Wearing Surface.

DESIGN STRESSES

FIELD UNITS

$f'_c = 5,000$ psi (Concrete Wearing Surface)
 $f'_c = 3,500$ psi (All concrete except CWS)
 $f_y = 60,000$ psi (reinforcement)

PRECAST PRESTRESSED UNITS

$f'_c = 5,000$ psi
 $f'_{ci} = 4,000$ psi
 $f'_s = 270,000$ psi ($\frac{1}{2}$ " ϕ low lax. strands)
 $f_{si} = 201,960$ psi ($\frac{1}{2}$ " ϕ low lax strands)



DESIGNED	RLM
CHECKED	MEL
DRAWN	AEC
CHECKED	RLM

10/04/07

APPROVED
FOR STRUCTURAL ADEQUACY ONLY

Ralph E. Anderson
ENGINEER OF BRIDGES AND STRUCTURES



David W. Petermeier
DAVID W. PETERMEIER
EDWARDSVILLE, ILLINOIS
ILLINOIS LICENSED STRUCTURAL
ENGINEER NO. 081-005642
EXPIRES NOV. 30, 2008

GENERAL PLAN & ELEVATION
ILL. ROUTE 34 OVER HOBBS CREEK
F.A.P. ROUTE 778 SECTION 4BR-1
HARDIN COUNTY
STATION 1021+80.00
STRUCTURE NO. 035-0008