

ROUTE NO.	SECTION	DISTRICT	SHEET	TOTAL SHEETS
F.A.U. 361	06-00214-08-BR	KANE	50	7

CONTRACT NO. 83978

CURVE WEST6
 PI STA. 589+36.38
 $\Delta = 20^\circ 44' 34''$ (RT)
 $D = 2^\circ 36' 15.67''$
 $T = 402.64'$
 $R = 2,200.00'$
 $L = 796.47'$
 $E = 36.54'$
 PC STA. 585+33.74
 PT STA. 593+30.20
 SE = 2.8%

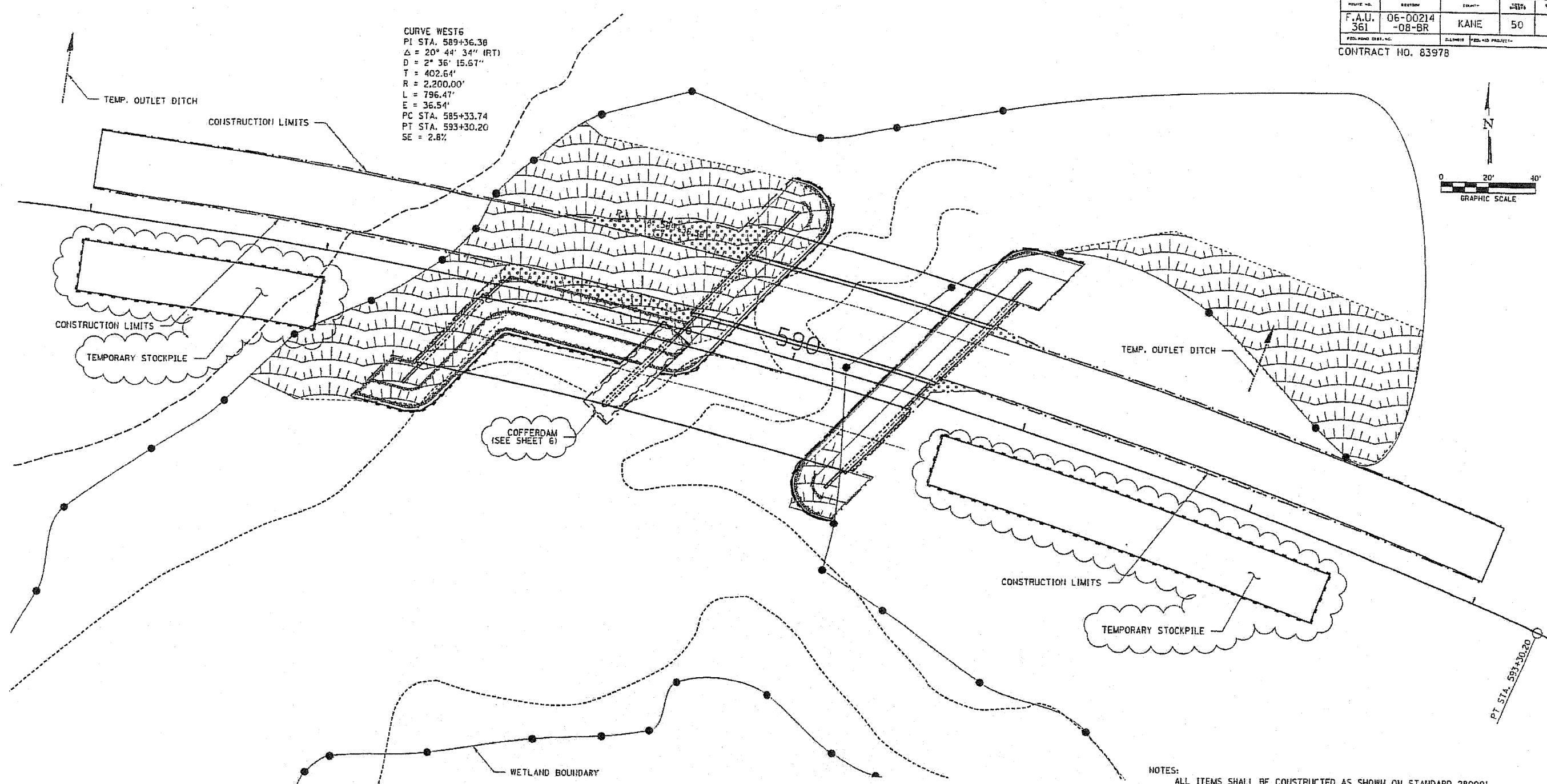
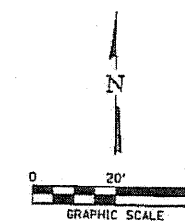

- LEGEND**
- PERIMETER EROSION BARRIER
 - COFFERDAM (SEE SHEET 6)
 - SEEDING CLASS 2A, SPECIAL
 - RIPRAP (SEE SHEET _ FOR LAYOUT)
 - EXISTING EMBANKMENT PLACED IN WETLANDS

NOTES:
 ALL ITEMS SHALL BE CONSTRUCTED AS SHOWN ON STANDARD 280001 AND AS DIRECTED BY THE ENGINEER. MAINTENANCE AND CLEANING OF THE EROSION CONTROL ITEMS SHALL BE INCLUDED IN THE RESPECTIVE EROSION CONTROL PAY ITEM.
 EROSION CONTROL BLANKET SHOULD BE UTILIZED ON THE CREEK BANKS AND SLOPES EQUAL TO OR STEEPER THAN 4H:1V.

REV. 12/17/07

Kane-DuPage
 Soil and Water Conservation District
 Project Number: 07e133
 Drawings Meet Technical Standards
 Signed By: *Kelsey Musich*
 Date: 12-7-07

HAMPTON, LENZINI & RENWICK, INC.
 CIVIL & STRUCTURAL ENGINEERS
 LAND SURVEYORS

HLR

3085 STEVENSON DRIVE, SUITE 201
 SPRINGFIELD, ILLINOIS 62703
 (217) 548-3400

ELGIN SPRINGFIELD

EROSION CONTROL PLAN
 SECTION 06-00214-08-BR
 F.A.U. ROUTE 361 / NEW STEARNS ROAD
 OVER THE NORTH ARM OF BREWSTER CREEK
 KANE COUNTY

STRUCTURE NO. 045-3167 (E.B.) / STATION 590+50.50
 STRUCTURE NO. 045-3165 (W.B.) / STATION 590+18.15