

as directed by the Engineer.

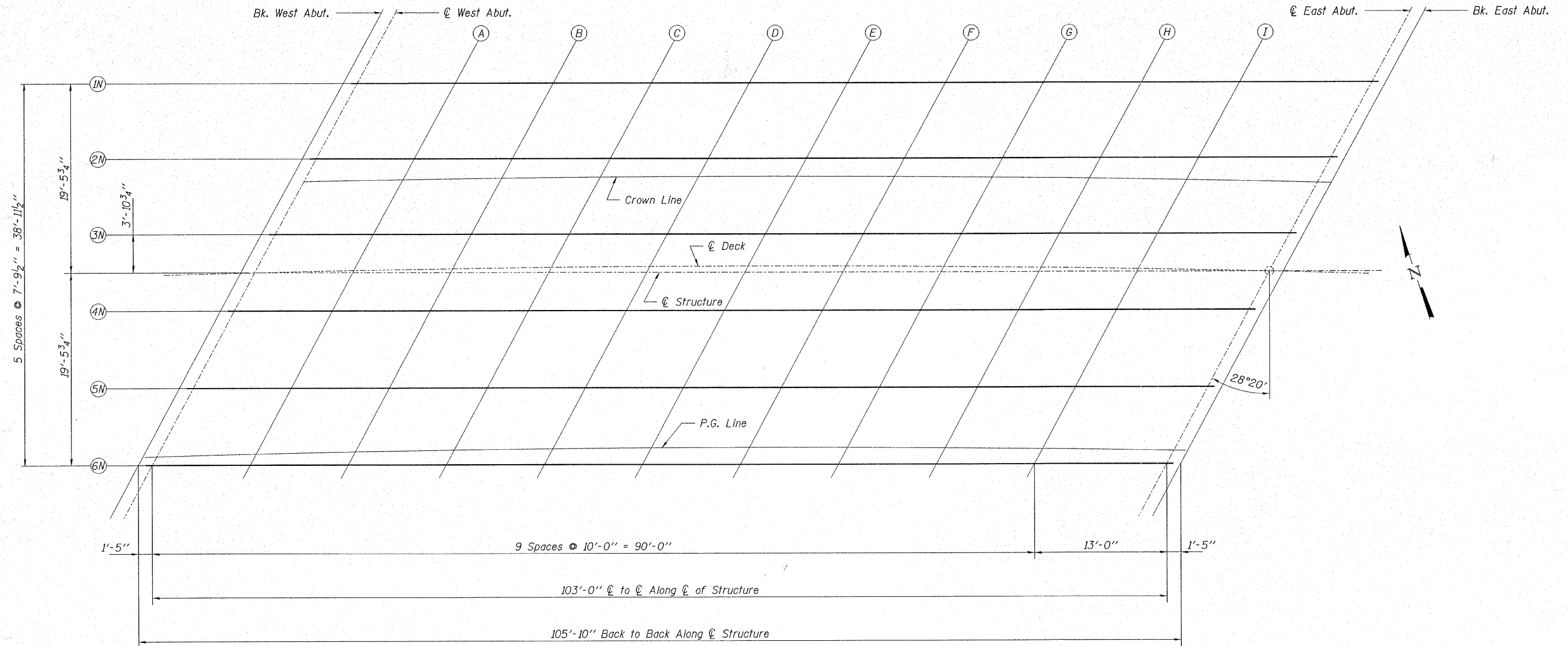

PLAN - WESTBOUND

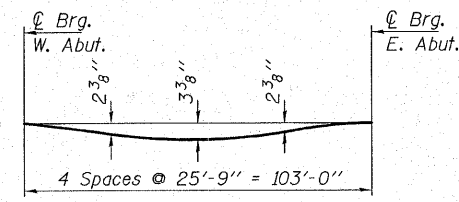

DEAD LOAD DEFLECTION DIAGRAM  
(Includes weight of concrete only)

Note: The above deflections are not to be used in the field if the engineer is working from the Theoretical Grade Elevations Adjusted for Dead Load Deflection as shown on Sheets 4 through 5.

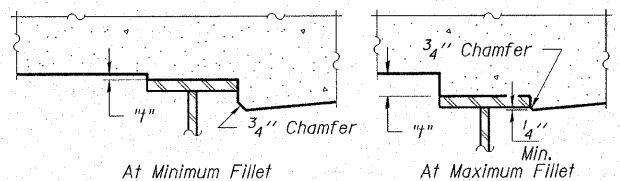

To determine "4": After all structural steel has been erected, elevations of the top flanges of the beams shall be taken at intervals shown above. These elevations, subtracted from the "Theoretical Grade Elevations Adjusted for Dead Load Deflection" shown on this sheet, minus slab thickness, equals the fillet heights "4" above top flange of beams.

FILLET HEIGHTS

**HAMPTON, LENZINI & RENWICK, INC.**  
 CIVIL & STRUCTURAL ENGINEERS  
 LAND SURVEYORS  
 3085 STEVENSON DRIVE, SUITE 201  
 SPRINGFIELD, ILLINOIS 62703  
 (217) 546-3400

**ELGIN • SPRINGFIELD**

PROJECT NUMBER: 12-05-0077-1    DATE: 09/20/07  
 DESIGNED: T.P.L.    CHECKED: J.L.B.    DRAWN: P.J.L.

**TOP OF SLAB ELEVATIONS**  
 SECTION 06-00214-08-BR  
 F.A.U. ROUTE 361 / NEW STEARNS ROAD  
 OVER THE NORTH ARM OF BREWSTER CREEK  
 KANE COUNTY

STRUCTURE NO. 045-3165 (W.B.) / STATION 590+18.15