

*109W-1,RS-2;110W,RS-1

F.A. RTE.	SECTION	COUNTY	TOTAL SHEETS	SHEET NO.
315		FULTON	324	31
STA.		TO STA.		
FED. ROAD DIST. NO. 4		ILLINOIS FED. AID PROJECT		

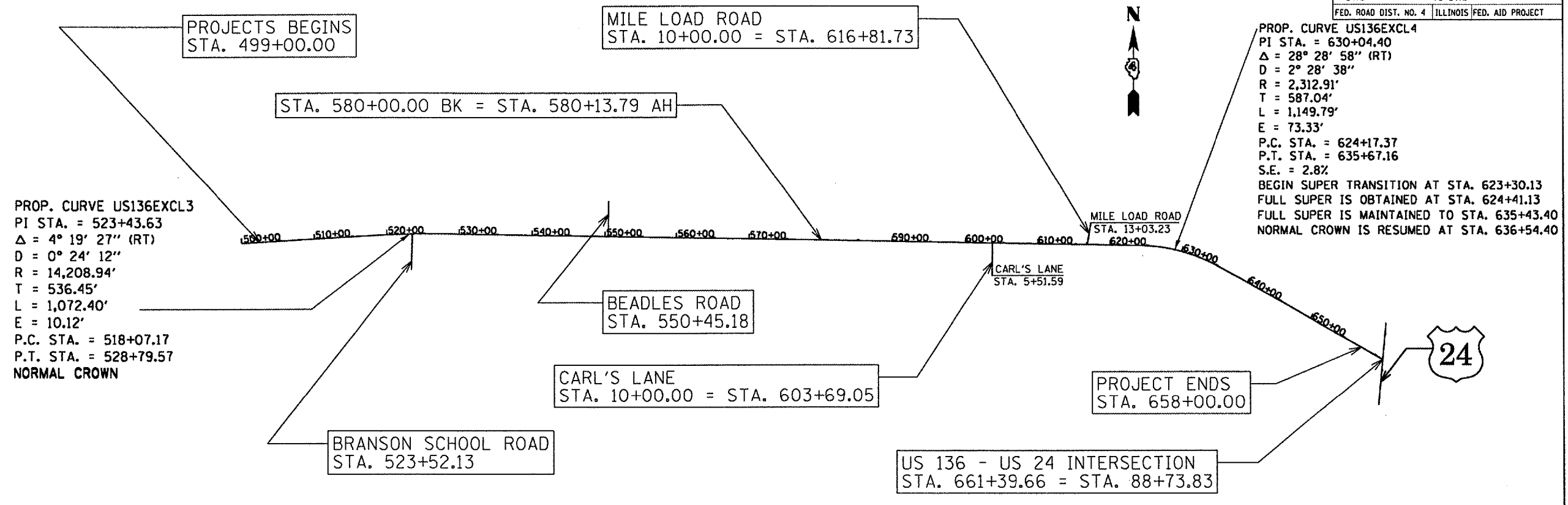

Benchmarks

- | | |
|---|--|
| <p>BM Brass Disk 6" +/- below ground level west of TWP Hall Building, East side of Drive on East side of Bush. Elevation = 480.370</p> <p>TBM#1 Chiseled "square" on west end of (south headwall) Rt. of Sta. 643+25 +/- Elevation = 548.86</p> <p>TBM#2 Chiseled "square" on east end of (south headwall) Rt. of Sta. 626+13 +/- Elevation = 569.01</p> <p>TBM#3 Chiseled "square" on east end of (south headwall) Rt. of Sta. 603+89 +/- Elevation = 469.03</p> <p>TBM#4 APEX of ROW Marker Lt. of (question mark) Sta. 507+05 +/- Elevation = 552.18</p> | <p>TBM#5 Chiseled "square" on south end of east headwall Lt. of Sta. 575+47 +/- Elevation = 564.83</p> <p>TBM#6 Chiseled "square" on corner of east headwall Lt. of Sta. 552+50 +/- (NE quad of Route 136 & Beadles Rd) Elevation = 561.35</p> <p>TBM#7 Chiseled "U" on corner of east headwall Lt. of Sta. 525+62 +/- (N quad of Route 136 & Branson School Rd) Elevation = 585.68</p> <p>TBM#8 Chiseled "L" on east end of north headwall @ Sta. 511+62 +/- Elevation = 592.76</p> <p>TBM#9 APEX of ROW Marker N.W. quad of Route 136 & Summom Rd @ Sta. 473+75 +/- Elevation = 611.72</p> |
|---|--|

c:\projects\us136\sum\us136cover.dgn

REVISIONS		ILLINOIS DEPARTMENT OF TRANSPORTATION
NAME	DATE	
		<p align="center">LINE DIAGRAM BENCHMARKS REFERENCE TIES</p> <p align="right">DRAWN BY CEM CHECKED BY</p> <p align="left">DATE 02/14/06</p>