

F.A.P. RTE.	SECTION	COUNTY	TOTAL SHEETS	SHEET NO.
315		EFFLON	324	44
STA. 630+00.00 TO STA. 645+00.00.		ILLINOIS FED. AID PROJECT		
FED. ROAD DIST. NO.		*109W-1,RS-2,110W,RS-1		

PLAN	DATE
BY	
REVISIONS	
NO.	DESCRIPTION
1	AS SHOWN

PROFILE	DATE
BY	
REVISIONS	
NO.	DESCRIPTION
1	AS SHOWN

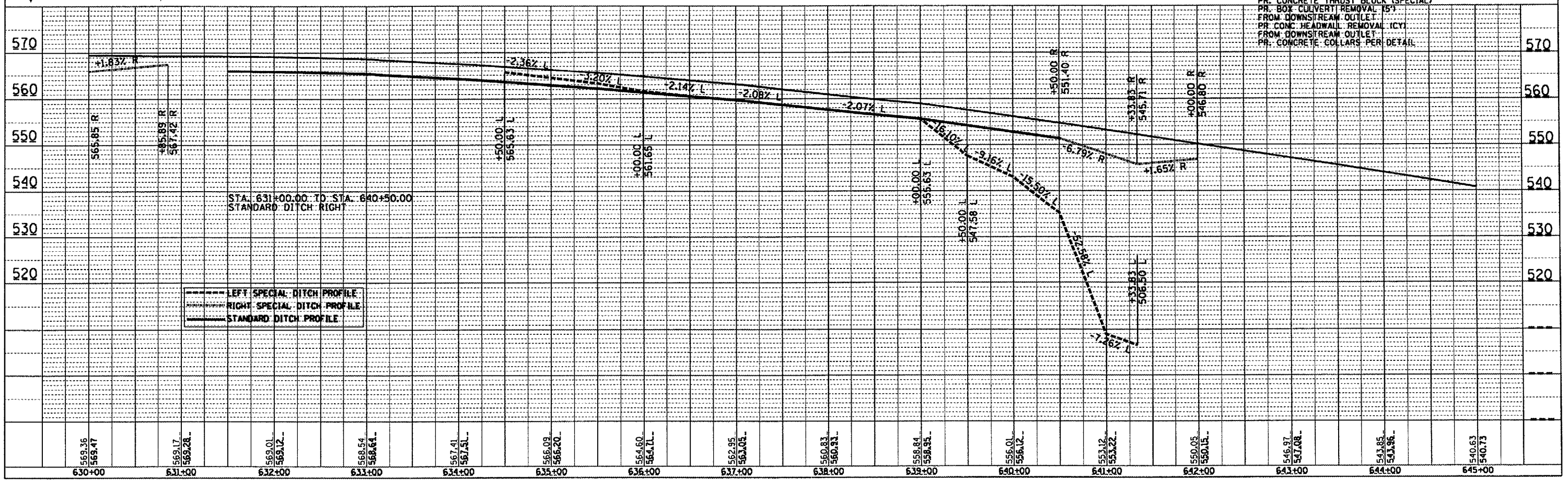
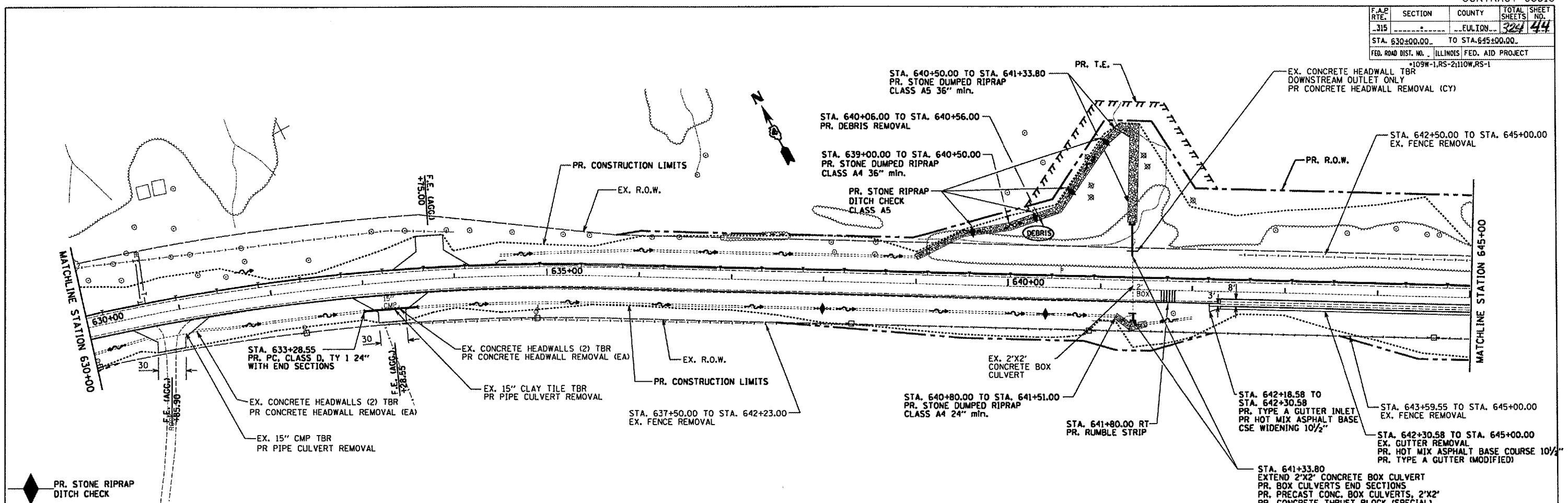

US136SUM/PP13.DGN