

ROUTE NO. 242	SECTION 06-06109-00-BR	COUNTY CLARK	TOTAL SHEETS 18	SHEET NO. 13
FED. ROAD DIST. NO.		ILLINOIS	CONTRACT NO. 95529	

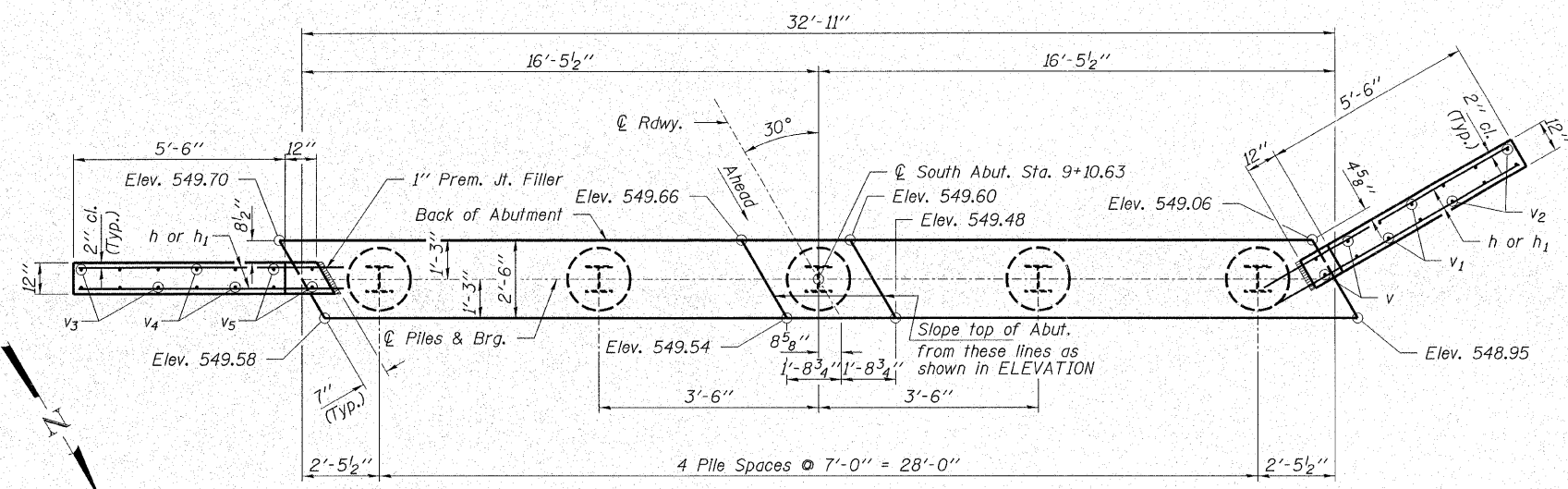

PLAN

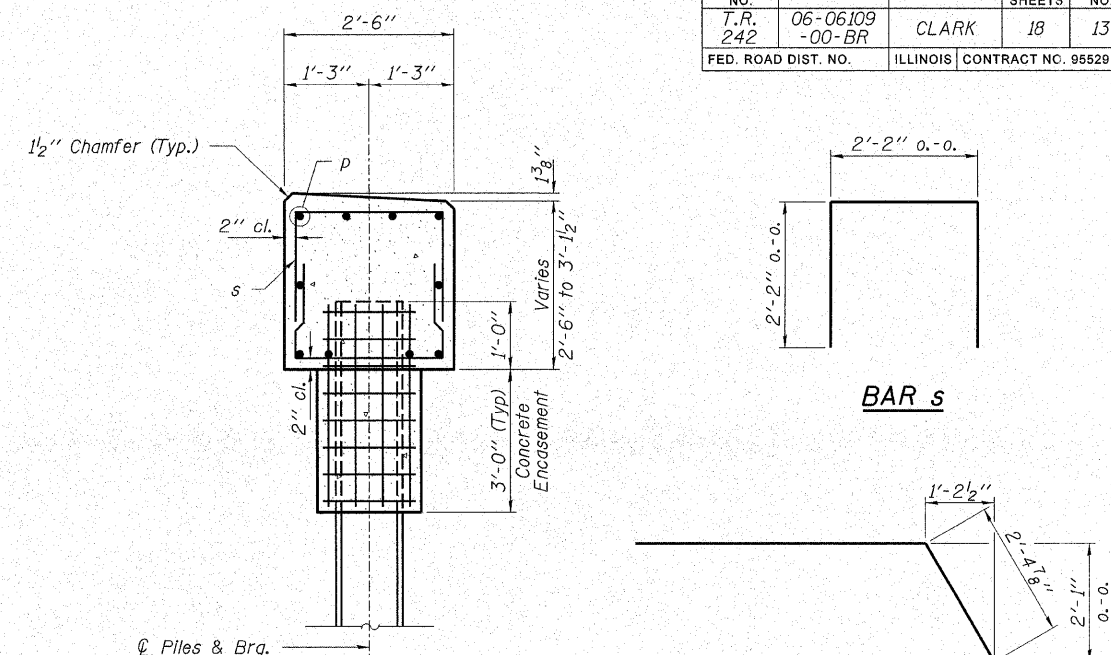

SECTION A-A

BAR u

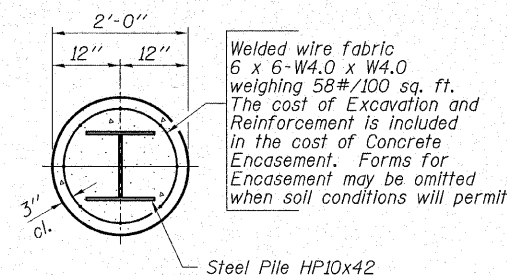

SECTION B-B

Welded wire fabric
6 x 6-W4.0 x W4.0
weighing 58#/100 sq. ft.
The cost of Excavation and
Reinforcement is included
in the cost of Concrete
Encasement. Forms for
Encasement may be omitted
when soil conditions will permit.

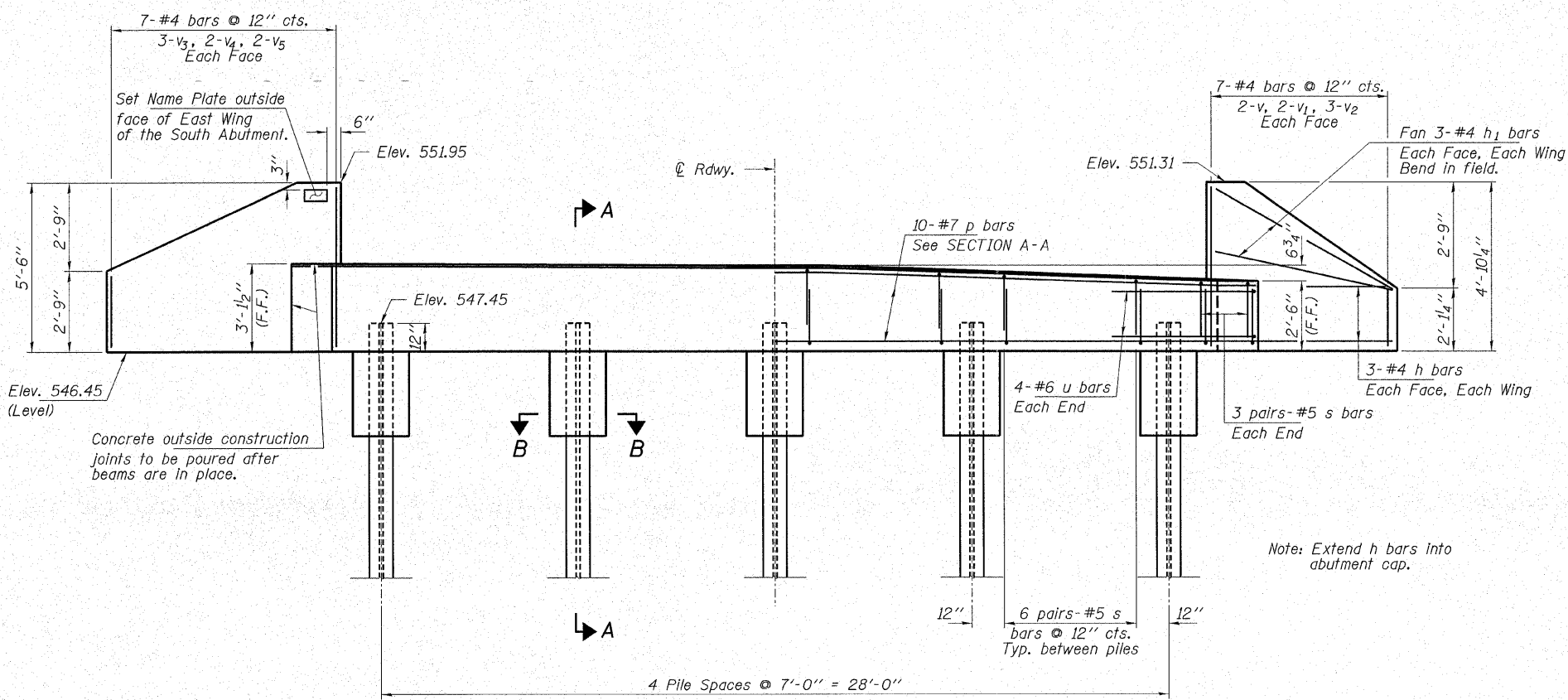

ELEVATION
(Looking South)

BILL OF MATERIAL - S. ABUT.

BAR	NO.	SIZE	LENGTH	SHAPE
h	12	#4	7'-9"	—
h ₁	12	#4	6'-0"	—
p	10	#7	32'-7"	—
s	60	#5	6'-6"	U
u	8	#6	12'-5"	—
v	4	#4	4'-6"	—
v ₁	4	#4	3'-6"	—
v ₂	6	#4	2'-0"	—
v ₃	6	#4	2'-6"	—
v ₄	4	#4	4'-0"	—
v ₅	4	#4	5'-0"	—
Concrete Structures			Cu. Yd.	11.0
Concrete Encasement			Cu. Yd.	1.7
Reinforcement Bars			Pound	1,400
Steel Piles HP10x42			Foot	100
Name Plates			Each	1

PILE DATA

Type.....Steel HP10x42
 No. Req'd.....5
 Allowable Resistance Available.....112 Kips/Pile
 Nominal Req'd Bearing.....336 Kips/Pile
 Est. Length.....20 Ft/Pile

Notes: The Steel H-Piles shall be according to AASHTO M270 Grade 50.
 See Sheet 17 for pile details.

HAMPTON, LENZINI & RENWICK, INC.
 CIVIL & STRUCTURAL ENGINEERS
 LAND SURVEYORS
 3085 STEVENSON DRIVE, SUITE 201
 SPRINGFIELD, ILLINOIS 62703
 (217) 546-3400

ELGIN • SPRINGFIELD

PROJECT NUMBER: 12-23-0026-1 DATE: 10/30/07
 DESIGNED: R.J.P. CHECKED: S.W.M. DRAWN: D.T.M.

SOUTH ABUTMENT
SECTION 06-06109-00-BR
DOUGLAS ROAD DISTRICT
CLARK COUNTY
STRUCTURE NO. 012-3329 / STATION 10+00