

**PROPOSED STATE STREET  
 TANGENT SECTION**  
 - TO APPLY -  
 STA 28+18.52 TO STA 29+00.00  
 STA 31+00.00 TO STA 31+76.54

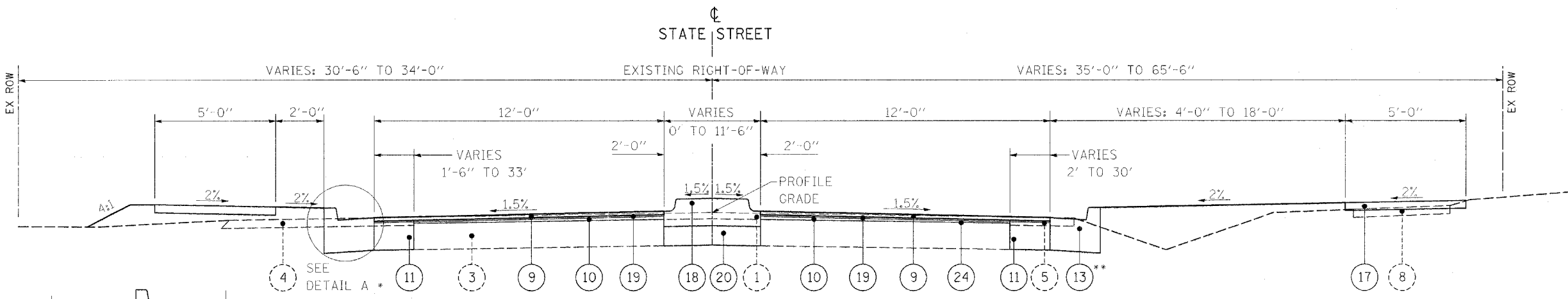

**PROPOSED STATE STREET  
 TANGENT SECTION**  
 - TO APPLY -  
 STA 29+00.00 TO STA 30+00.00  
 STA 30+00.00 TO STA 31+00.00

\*\* STA 30+34.73 TO STA 31+07.24 - COMB CONC C & G, TYPE B-6.18  
 STA 31+07.24 TO STA 31+76.54 - HOT-MIX ASPHALT SHOULDER

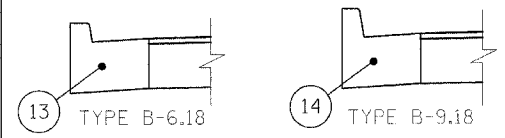

\* STA 29+08.09 TO STA 29+64.55 - COMB CONC C & G, TYPE B-9.18  
 STA 30+35.13 TO STA 31+05.78 - COMB CONC C & G, TYPE B-6.18

**LEGEND**

- |  |  |
|--|--|
| ① EXISTING HOT-MIX ASPHALT OVERLAY                   | ⑨ PROPOSED POLYMERIZED HOT-MIX ASPHALT SURFACE COURSE, MIX "D", N90 (1-3/4")         |
| ② EXISTING HOT-MIX ASPHALT PAVEMENT (VARIABLE DEPTH) | ⑩ PROPOSED HOT-MIX ASPHALT BINDER COURSE, IL-19.0, N90 (VARIABLE DEPTH)              |
| ③ EXISTING PCC PAVEMENT (VARIABLE DEPTH)             | ⑪ PROPOSED HOT-MIX ASPHALT BASE COURSE (9")  |
| ④ EXISTING AGGREGATE SHOULDER                        | ⑫ PROPOSED HOT-MIX ASPHALT SHOULDERS (6")  |
| ⑤ EXISTING HOT-MIX ASPHALT SHOULDER                  | ⑬ PROPOSED COMBINATION CONCRETE CURB & GUTTER, TYPE B-6.18                           |
| ⑥ EXISTING MOUNTABLE CONCRETE CURB AND GUTTER        | ⑭ PROPOSED COMBINATION CONCRETE CURB & GUTTER, TYPE B-9.18                           |
| ⑦ EXISTING BARRIER CONCRETE CURB AND GUTTER          | ⑮ PROPOSED COMBINATION CONCRETE CURB & GUTTER, TYPE M-2.06                           |
| ⑧ EXISTING CONCRETE SIDEWALK                         | ⑯ PROPOSED COMBINATION CONCRETE CURB & GUTTER, TYPE B-9.18 (SPECIAL)                 |
|  | ⑰ PROPOSED PORTLAND CEMENT CONCRETE SIDEWALK, 4"                                     |
|  | ⑱ PROPOSED LEVELING BINDER (MACHINE METHOD), N90 (3/4")                              |
|  | ⑲ PROPOSED HOT-MIX ASPHALT SURFACE REMOVAL, VARIABLE DEPTH (DUE TO SLOPE CORRECTION) |
|  | ⑳ PROPOSED SUB-BASE GRANULAR MATERIAL, TYPE A, (VARIABLE DEPTH)                      |
|  | ㉑ PROPOSED PC CONCRETE PAVEMENT, 7.5"  |
|  | ㉒ PROPOSED PAVEMENT FABRIC   |
|  | ㉓ TOPSOIL FURNISH AND PLACE, (VARIABLE DEPTH)  |

CITY OF O'FALLON, ILLINOIS

**STATE STREET &  
 OBERNUEFEMANN ROAD**

TYPICAL SECTIONS

SCALE: NONE  
 DATE: 10/05/06

DRAWN BY: SSM  
 CHECKED BY: TJM

Plot Date: 10/27/2006  
 Plot Time: 10:50:47 AM  
 Plotted By: r01dndrph  
 Filename: R:\0306\0311\Construction\Plans\Typical.dgn