

Bench Mark: Square cut in N.W. wingwall of 028-0046, Elevation 442.486
 Square cut in the center of west edge of east pier base under S.N. 028-0046, Elevation 422.576.

STATE OF ILLINOIS
 DEPARTMENT OF TRANSPORTATION

ROUTE NO.	SECTION	COUNTY	SHEET NO.	SHEET	SHEET NO. 1
FAP 869	(10IVB) B-1	FRANKLIN	48	30	18 SHEETS

Contract No. 98821

Existing Structure: S.N. 028-0046 Built in 1934 as S.B.I. Rt. 143, Sec. 101-VB NRS at Sta. 176+73.87 as a 4 span steel plate girder structure 196'-8" Bk.-Bk. abutments supported on spread footing. Superstructure replacement and widening with PPC deck beam in 1972 - new bridge length = 117'-11 5/8" Bk.-Bk. abutments. Existing bridge to be removed and replaced. Traffic to be maintained utilizing temporary runaround.

No salvage

INDEX OF SHEETS

- 1 General Plan & Elevation
- 2 General Data
- 3-5 Top of Slab Elevations
- 6 Top of West Approach Pavement Elevations
- 7 Top of East Approach Pavement Elevations
- 8 Superstructure
- 9 Superstructure Details
- 10 Diaphragm Details
- 11 Structural Steel
- 12 Bearing Details
- 13 West Abutment
- 14 East Abutment
- 15 Pier 1
- 16 Pier 2
- 17 Bar Splicer Assembly Details
- 18 Steel H Pile Details

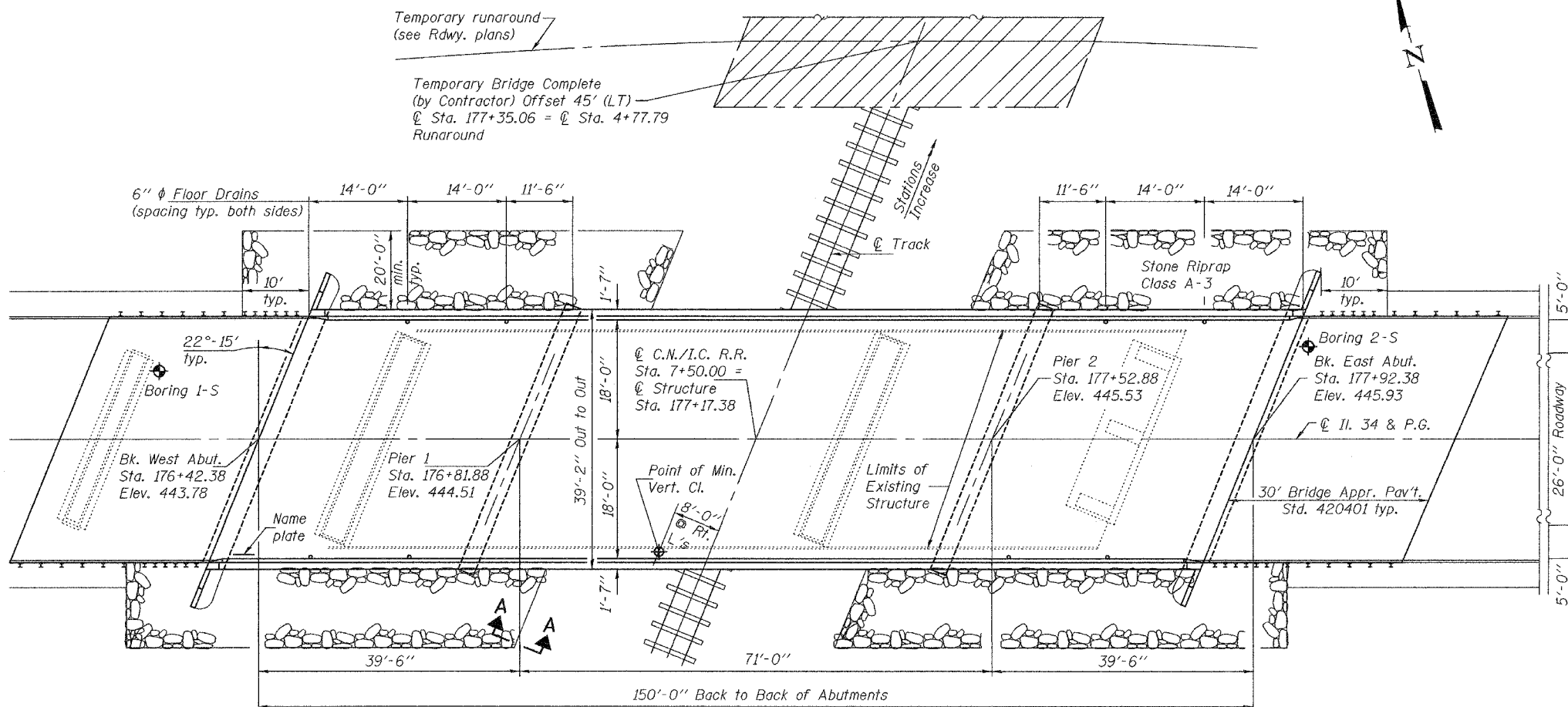
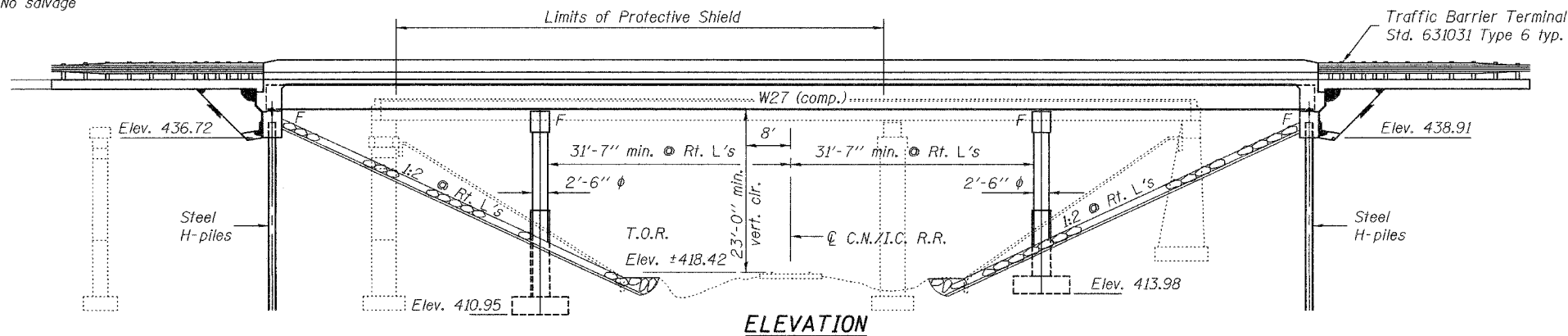

STATION 177+17.38
 BUILT 20 BY
 STATE OF ILLINOIS
 F.A.P. RTE. 869 SEC. (10IVB)B-1
 LOADING HL-93
 STRUCTURE NO. 028-0077

NAME PLATE
 See Std. 515001

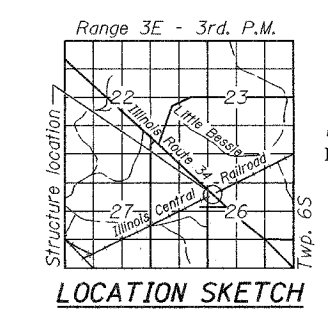
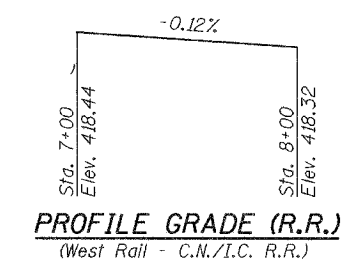
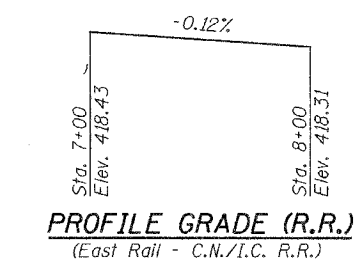
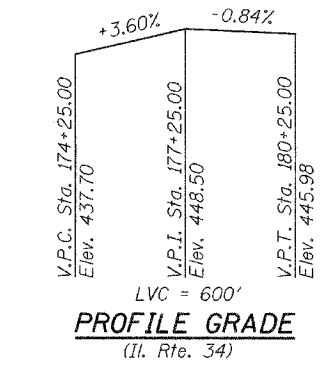

GENERAL PLAN & ELEVATION
 ILLINOIS ROUTE 34 OVER
 C.N./I.C. RAILROAD
 F.A.P. RTE. 869 - SEC. (10IVB)B-1
 FRANKLIN COUNTY
 STATION 177+17.38
 STRUCTURE NO. 028-0077

DESIGNED	Danny H. Culltan
CHECKED	Roy Abonchi
DRAWN	h.t. duong
CHECKED	DHC/KRA

November 30, 2007

EXAMINED *[Signature]*
 ENGINEER OF BRIDGE DESIGN

PASSED *[Signature]*
 ENGINEER OF BRIDGES AND STRUCTURES



Notes: See sheet 2 of 18 for Section A-A.

LOADING HL-93
 Allow 50#/sq. ft. for future wearing surface.

DESIGN SPECIFICATIONS
 2004 LRFD AASHTO w/2005 & 2006 Interims

DESIGN STRESSES

FIELD UNITS

f_c = 3,500 psi
 f_y = 60,000 psi (reinforcement)
 f_y = 50,000 psi (structural steel M270 Gr. 50W)

SEISMIC DATA

Seismic Performance Zone (SPZ) = 2
 Bedrock Acceleration Coefficient (A) = .12g
 Site Coefficient (S) = 1.0