

INDEX

SUMMARY OF QUANTITIES, GENERAL NOTES AND UTILITY REFERENCES \_\_\_\_\_2  
 NAME PLATE, CONSTRUCTION SIGN AND BENCH MARK \_\_\_\_\_3  
 GENERAL PLAN, REFERENCE NOTES, R.O.W. AND RIPRAP \_\_\_\_\_4  
 PROPOSED ROADSIDE DITCH IMPROVEMENT, PLAN-PROFILE \_\_\_\_\_5-6  
 3 MILE LANE, GENERAL PLAN AND CULVERT DETAILS \_\_\_\_\_7  
 ILL. ROUTE 125, GENERAL PLAN AND CULVERT DETAILS \_\_\_\_\_8  
 ILL. ROUTE 125, 3 MILE LANE, FREMONT ST., CEM. RD., TRAFFIC CONTROL \_\_\_\_\_9  
 ILL. ROUTE 125, CULVERT END SECTION DETAILS (UPSTREAM END) \_\_\_\_\_10  
 ILL. ROUTE 125, CULVERT END SECTION DETAILS (DOWNSTREAM END) \_\_\_\_\_11  
 FREMONT STREET, GENERAL PLAN AND CULVERT DETAILS \_\_\_\_\_12  
 ABANDONED R.R. CROSSING GENERAL PLAN \_\_\_\_\_13  
 CEMETERY ROAD GENERAL PLAN AND CULVERT DETAILS \_\_\_\_\_14  
 CEMETERY ROAD CULVERT HEADWALL DETAILS \_\_\_\_\_15  
 CEMETERY ROAD CULVERT HEADWALL DETAILS \_\_\_\_\_16  
 DETAILS \_\_\_\_\_17-19  
 EROSION CONTROL PLAN \_\_\_\_\_20  
 EROSION CONTROL GENERAL NOTES \_\_\_\_\_20A  
 ROADSIDE DITCH CHANNEL CROSS SECTIONS (ALONG ILL. RTE. 125) \_\_\_\_\_21-22  
 CHANNEL CROSS SECTIONS (SOUTH OF FREMONT STREET) \_\_\_\_\_23

D.O.T. STANDARDS

000001 Standard Symbols, Abbreviations, and Patterns  
 280001 Temporary Erosion Control Systems  
 442201 Class C And D Patches  
 515001 Name Plate For Bridges  
 542301 Precast Reinforced Concrete Flared End Section  
 601101 Concrete Headwall For Pipe Drain  
 666001 Right Of Way Markers  
 701001 Off-Rd Operations 2L, 2W, More Than 15' (4.5 m) Away  
 701006 Off-Rd Operations 2L, 2W, 15' (4.5 M) To 24" (600 mm) to Pavement Edge  
 701901 Traffic Control Devices  
 B.L.R. 21-5 Typical Application Of Traffic Control Devices For Construction On Rural Local Highways  
 701201 Lane Closure 2L, 2W Day Only Speeds ≥ 45 MPH  
 701311 Lane Closure 2L, 2W Moving Operations - Day Only

**STATE OF ILLINOIS**  
**DEPARTMENT OF NATURAL RESOURCES**  
**OFFICE OF WATER RESOURCES**

**ASHLAND FLOOD CONTROL PROJECT**  
**ASHLAND, ILLINOIS**  
**CASS COUNTY**

**FR-399**

**2013**

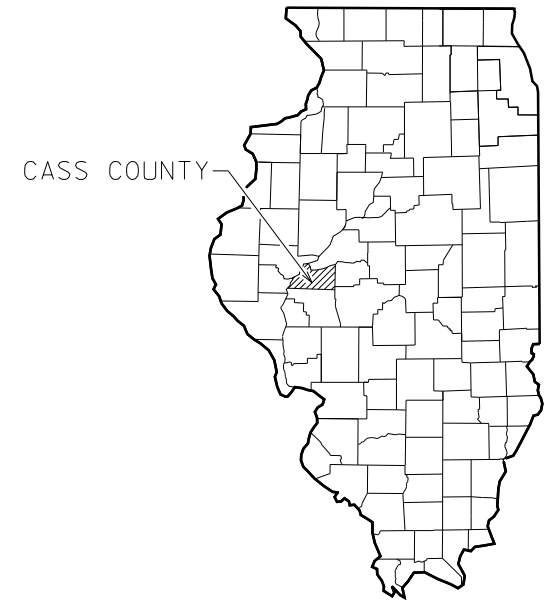

CASS COUNTY

REGIONAL MAP

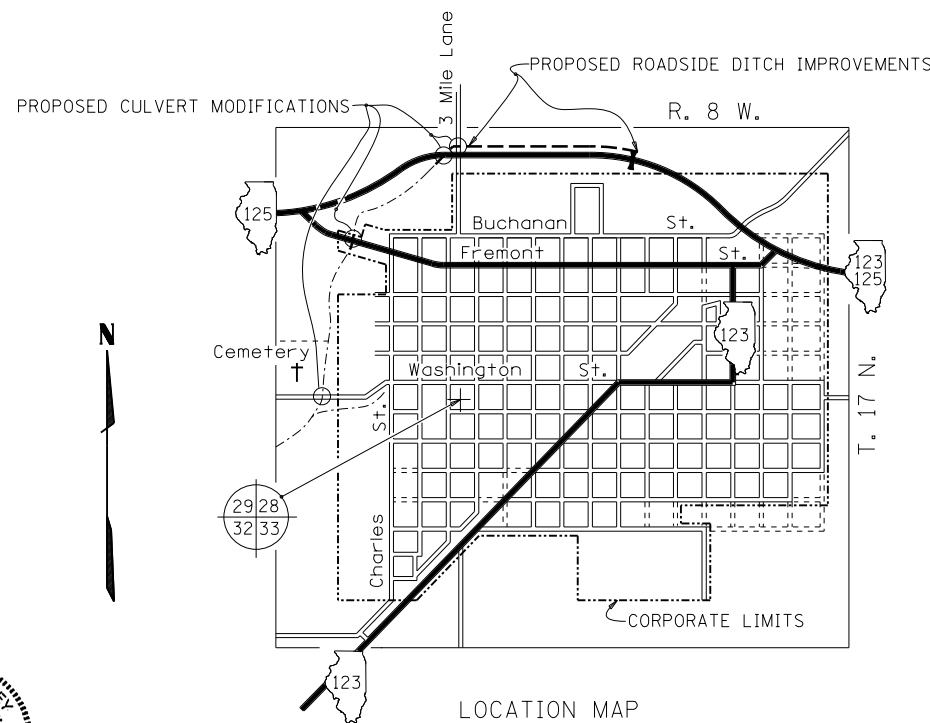

LOCATION MAP

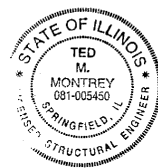
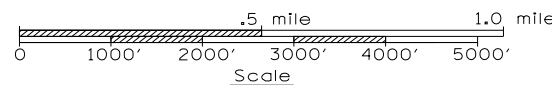

*Ted Montrey* 12/11/12

ILLINOIS LICENSED STRUCTURAL ENGINEER NO. 081-005450  
 LICENSE EXPIRES 11-30-14



*Ted Montrey* 12/11/12

ILLINOIS REGISTERED PROFESSIONAL ENGINEER NO. 062-049591  
 LICENSE EXPIRES 11-30-13

APPROVED BY *Chris R. [Signature]* DATE 12-13-12

DIRECTOR