

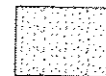



REMOVAL LEGEND

-  HOT-MIX ASPHALT SURFACE REMOVAL, 2"
-  MEDIAN SURFACE REMOVAL
-  COMBINATION CURB AND GUTTER REMOVAL

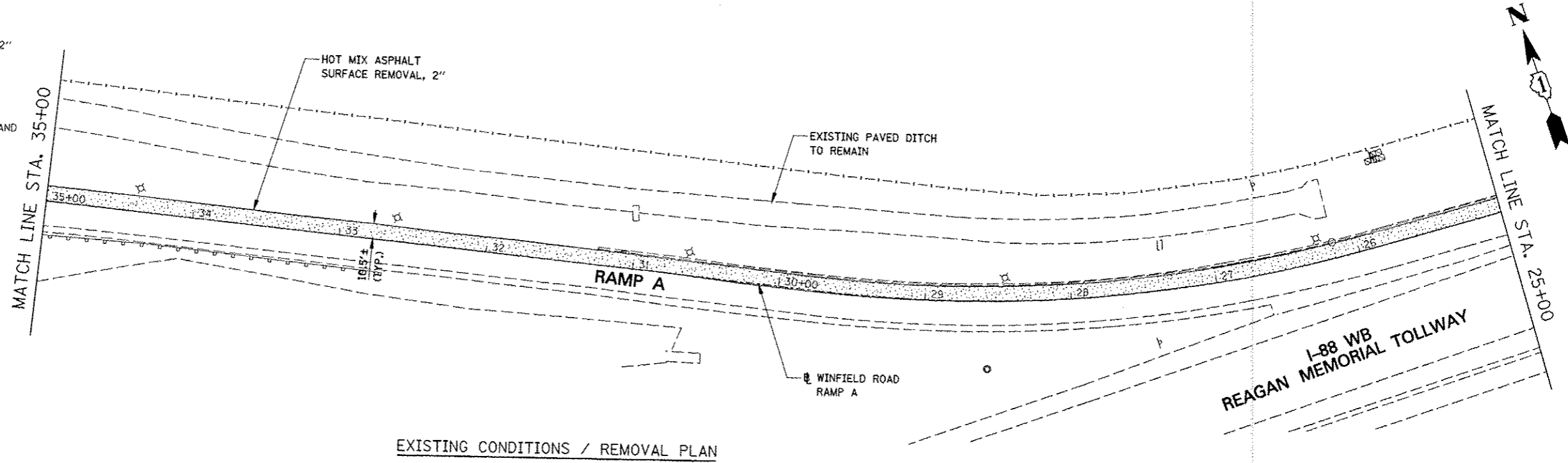

EXISTING CONDITIONS / REMOVAL PLAN

LEGEND

-  HOT-MIX ASPHALT SURFACE COURSE, MIX "D", N70

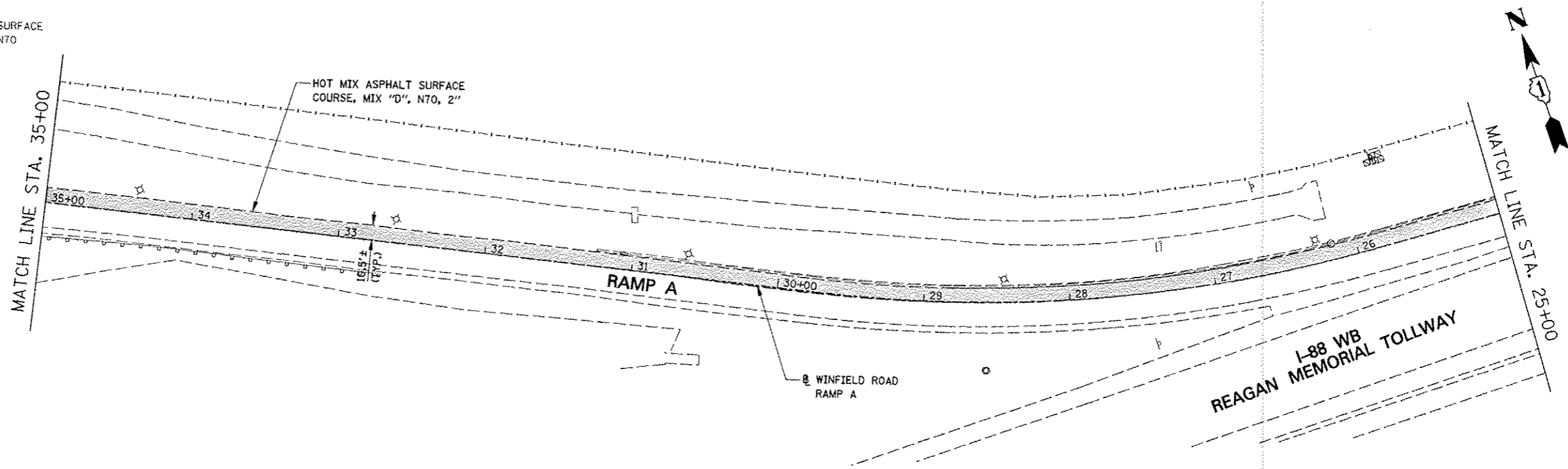

PROPOSED PLAN

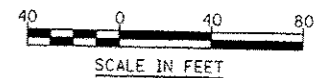

FILE NAME *	USER NAME * #USER#	DESIGNED <i>PJO</i>	REVISED - ADDENDUM A 12/17/2012
#FILE#		DRAWN <i>KES</i>	REVISED -
		CHECKED <i>JCM</i>	REVISED -
		DATE <i>12/17/2012</i>	REVISED -

**STATE OF ILLINOIS
DEPARTMENT OF TRANSPORTATION**

**REMOVAL AND PROPOSED PLAN
WINFIELD ROAD RAMP A**

F.A.P. RTE.	SECTION	COUNTY	TOTAL SHEETS	SHEET NO.
338	(112 & 113) WRS-5	DUPAGE	263	2628
CONTRACT NO. 60131				

SCALE: 1" = 40' SHEET NO. 2 OF 4 SHEETS STA. 35+00 TO STA. 25+00

ILLINOIS FED. AID PROJECT