

MATCH LINE STA. 1014+00
SEE DRAWING DE-08

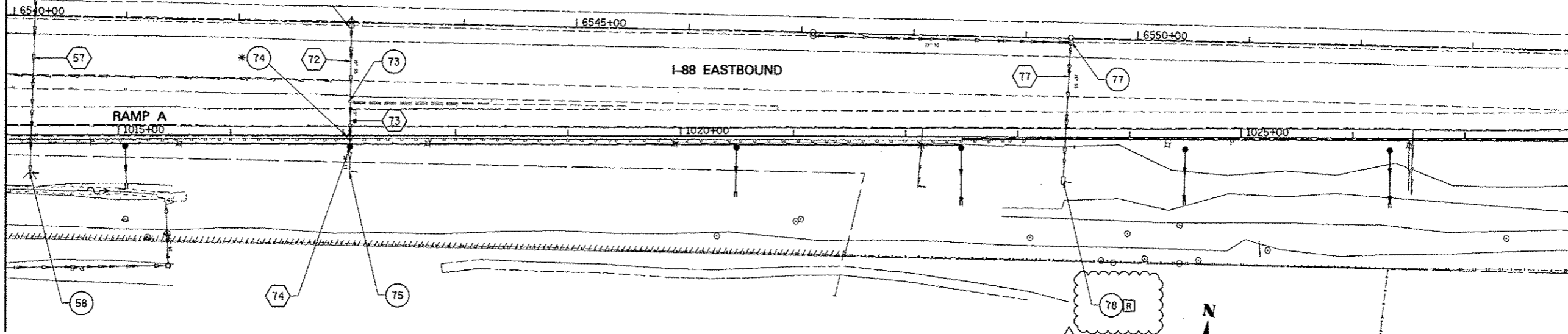

* REMOVE CATCH BASIN TO MAINTAIN FLOW.

NOTE:
1. SEE DRAWING DN-01 FOR EXISTING DRAINAGE LEGEND.

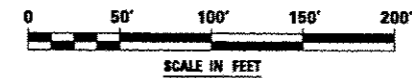

MATCH LINE STA. 1028+00
SEE BELOW

MATCH LINE STA. 1028+00
SEE ABOVE

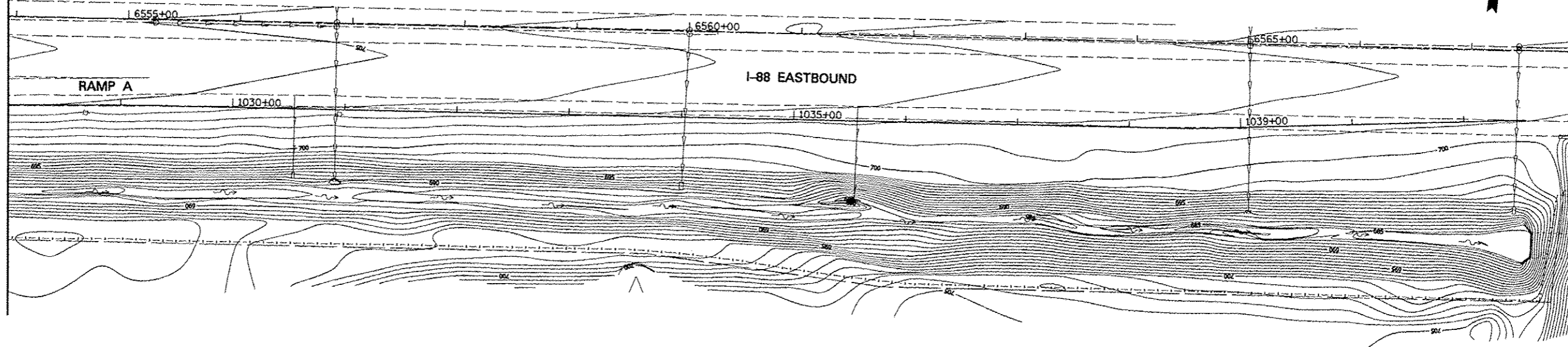

FILE NAME :	USER NAME : #USER#	DESIGNED <i>PJO</i>	REVISED ADDENDUM A 12/17/2012
#FILE#		DRAWN <i>KES</i>	REVISED -
	PLOT SCALE : #SCALE#	CHECKED <i>JCM</i>	REVISED -
	PLOT DATE : #DATE#	DATE <i>10/15/2012</i>	REVISED -

STATE OF ILLINOIS
DEPARTMENT OF TRANSPORTATION

EXISTING DRAINAGE PLAN - RAMP A

SCALE: 1"=50' SHEET NO. 9 OF 10 SHEETS STA. 1014+00 TO STA. 1028+00

F.A.P. RTE.	SECTION	COUNTY	TOTAL SHEETS	SHEET NO.
338	(112 & 113) WRS-5	DUPAGE	963	336
DE-09			CONTRACT NO. 60131	
ILLINOIS FED. AID PROJECT				