

DESIGN SPECIFICATIONS
 2012 AASHTO LRFD Bridge Design
 Specifications 6th Edition with 2012 Interims

DESIGN STRESSES

FIELD UNITS
 $f'_c = 3,500$ psi
 $f_y = 60,000$ psi (reinforcement)
 $f_y = 36,000$ psi (M270 Grade 36)

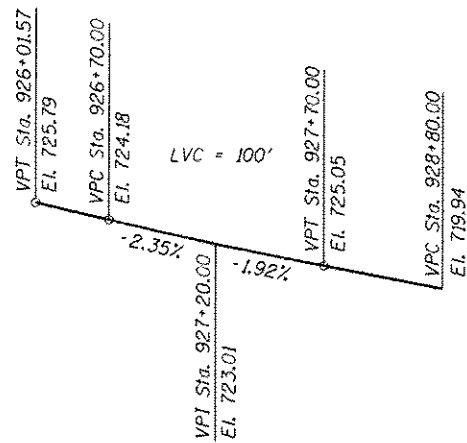

ⓑ NB IL ROUTE 59 - PROPOSED PROFILE GRADE LINE
 (along edge of pavement proposed NB IL Route 59)

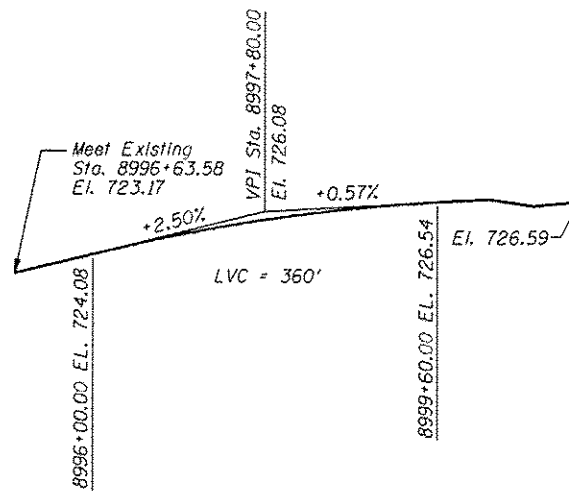

ⓑ RAMP B - PROPOSED PROFILE GRADE LINE
 (along ⓑ proposed Ramp B)

GENERAL NOTES

1. Reinforcement bars designated (E) shall be epoxy coated.
2. The Contractor is responsible for the design and performance of the lagging using no less than 3" nominal rough-sawn thickness and timber with a minimum allowable bending stress of 1000 psi.



TOTAL BILL OF MATERIAL

ITEM	UNIT	TOTAL
Structure Excavation	Cu. Yd.	177
Concrete Structures	Cu. Yd.	105.8
Stud Shear Connectors	Each	345
Reinforcement Bars, Epoxy Coated	Pound	14,760
Geocomposite Wall Drain	Sq. Yd.	137
Untreated Timber Lagging	Sq. Ft.	1,828
Furnishing Soldier Piles (W Section)	Foot	1,084
Pipe Underdrains for Structures, 4"	Foot	300
Drilling and Setting Soldier Piles (In Soil)	Cu. Ft.	6,119
Form Liner Textured Surface	Sq. Ft.	1,197
Granular Backfill for Structures	Cu. Yd.	215

FILE NAME: ... \B131-W066-022-Cor-Cor.dwg



USER NAME = SAW	DESIGNED - LAS	REVISED Δ 12/17/2012 L.A.S.
	CHECKED - DAZ	REVISED
PLOT SCALE = 38.00' / IN.	DRAWN - SAW	REVISED
PLOT DATE = 12/12/2012	CHECKED - JLA	REVISED

**STATE OF ILLINOIS
 DEPARTMENT OF TRANSPORTATION**

**GENERAL NOTES & BILL OF MATERIAL
 STRUCTURE NUMBER 022-W066**

SHEET NO. SE-2 OF SE-11 SHEETS

F.A.P. RTE.	SECTION	COUNTY	TOTAL SHEETS	SHEET NO.
338/IL 59	112 & 1131 WRS-5	DUPAGE	963	674
CONTRACT NO. 60131				

ILLINOIS FED. AID PROJECT