

ELEVATION - FORM LINER

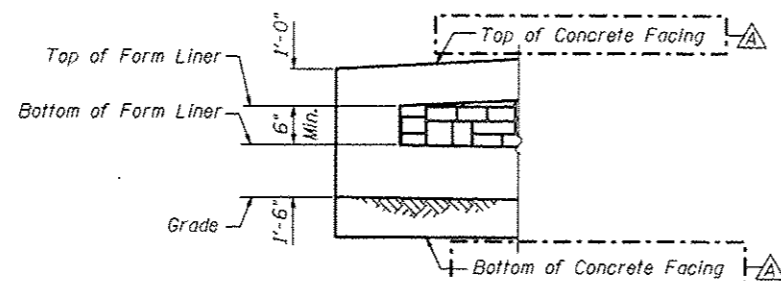

END FORM LINER FINISH

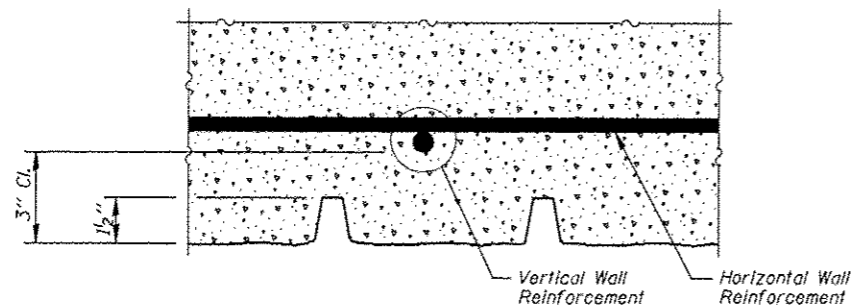

PLAN - FORM LINER

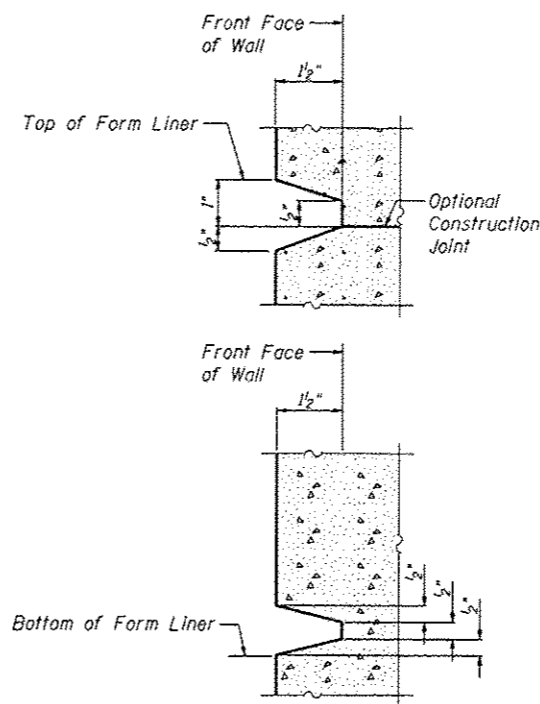

SECTION A-A

FORM LINER ELEVATION TABLE

Station	Form Liner Top Elevation	Form Liner Bottom Elevation
926+14.90	None	None
926+15.61	712.46	711.96
926+17.34	713.54	712.10
926+29.99	716.17	712.31
926+43.68	718.81	712.53
926+58.80	721.50	712.71
926+79.91	720.31	712.91
927+01.14	719.12	713.10
927+25.08	717.94	713.06
927+52.12	716.75	713.02
927+79.18	715.56	712.96
928+06.25	714.37	712.96
928+26.88	713.47	712.96
928+33.32	None	None
928+60.40	None	None

FILE NAME: \A\0171-W066-B10-Arch-Finish.dgn

**ZROKA**  
engineering  
Zroka Engineering, P.C.  
4216 North Hermitage  
Chicago, IL 60613

USER NAME = SAW	DESIGNED - LAS	REVISED $\Delta$ 12/17/2012 L.A.S.
	CHECKED - DAZ	REVISED
PLOT SCALE = 0.1667' / IN.	DRAWN - SAW	REVISED
PLOT DATE = 12/12/2012	CHECKED - JLA	REVISED

STATE OF ILLINOIS  
DEPARTMENT OF TRANSPORTATION

ARCHITECTURAL FINISH DETAILS  
STRUCTURE NUMBER 022-W066

SHEET NO. SE-10 OF SE-11 SHEETS

F.A.P. RTE.	SECTION	COUNTY	TOTAL SHEETS	SHEET NO.
338/IL 59	(112 & 113) WRS-5	DUPAGE	963	682
CONTRACT NO. 60131				

ILLINOIS FED. AID PROJECT