

08-06-400-008

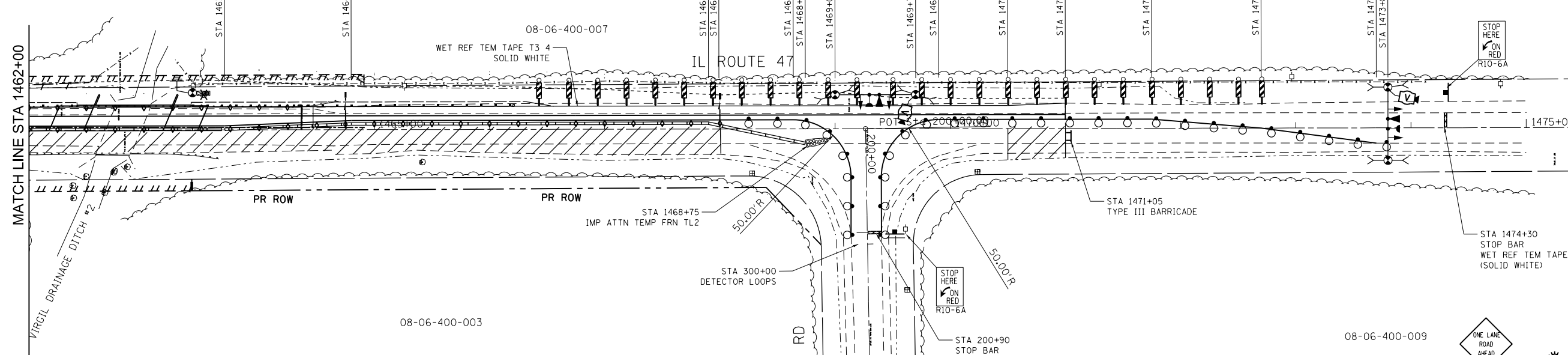
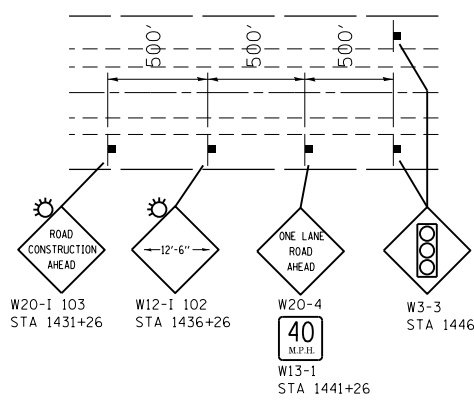
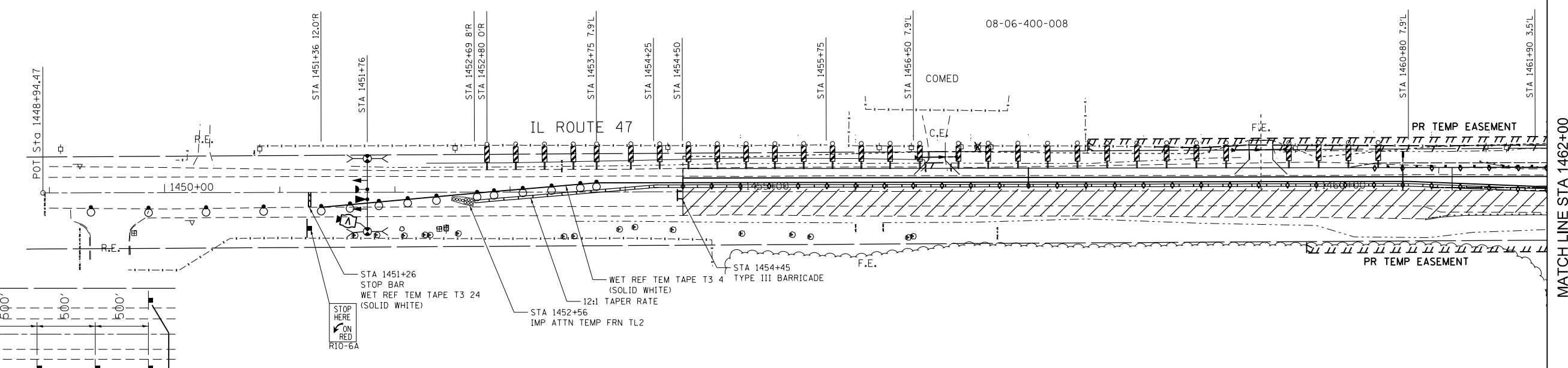

SYMBOL LEGEND

- WORK AREA
- SIGN
- TYPE III BARRICADE
- TRAFFIC SIGNAL
- IMPACT ATTENUATOR
- DRUM WITH STEADY BURNING BI-DIRECTIONAL LIGHT
- TEMPORARY CONCRETE BARRIER
- CRYSTAL, BI-DIRECTIONAL BARRIER WALL/GUARDRAIL MARKER
- DOUBLE VERTICAL PANEL W/ STEADY BURNING BI-DIRECTIONAL LIGHT

NOTE:
TRAFFIC CONTROL SHALL BE ERECTED AS SHOWN AND ACCORDING TO "TRAFFIC CONTROL AND PROTECTION, STANDARD 701321".
SEE TEMPORARY TRAFFIC SIGNAL AND LIGHTING PLAN FOR STAGE 2.

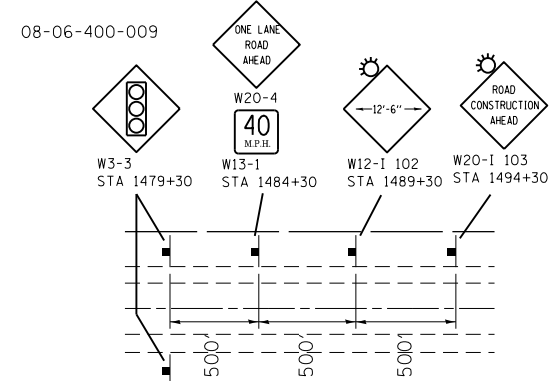
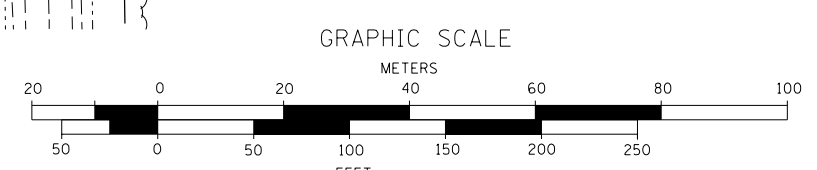

FILE NAME = D160N13-sht-staging3.dgn	USER NAME = mmann	DESIGNED - JTS	REVISED - 10-8-2012
	PLOT SCALE = 100.0000' / in.	DRAWN - DWS	REVISED -
	PLOT DATE = 10/24/2012	CHECKED - JAR	REVISED -
		DATE - 8-23-2011	REVISED -

**STATE OF ILLINOIS
DEPARTMENT OF TRANSPORTATION**

**IL ROUTE 77 OVER VIRGIL DITCH #2
SUGGESTED STAGE OF CONSTRUCTION & TRAFFIC CONTROL - STAGE 3**

SCALE: 1"=50' SHEET NO. OF SHEETS STA. TO STA.

F.A.P. RTE. 326	SECTION 106X-8	COUNTY KANE	TOTAL SHEETS 87	SHEET NO. 18
CONTRACT NO. 60N13				
FED. ROAD DIST. NO. ILLINOIS FED. AID PROJECT				