

FINAL SURVEY NOTE BOOK NO.	DATE

ORIGINAL SURVEY NOTE BOOK NO.	DATE

PLOT DRIVER = 08_05X-1117.dwg
 FILE NAME = S:\Projects\08_05X-1117.dwg
 PLOT DATE = 18/9/2012

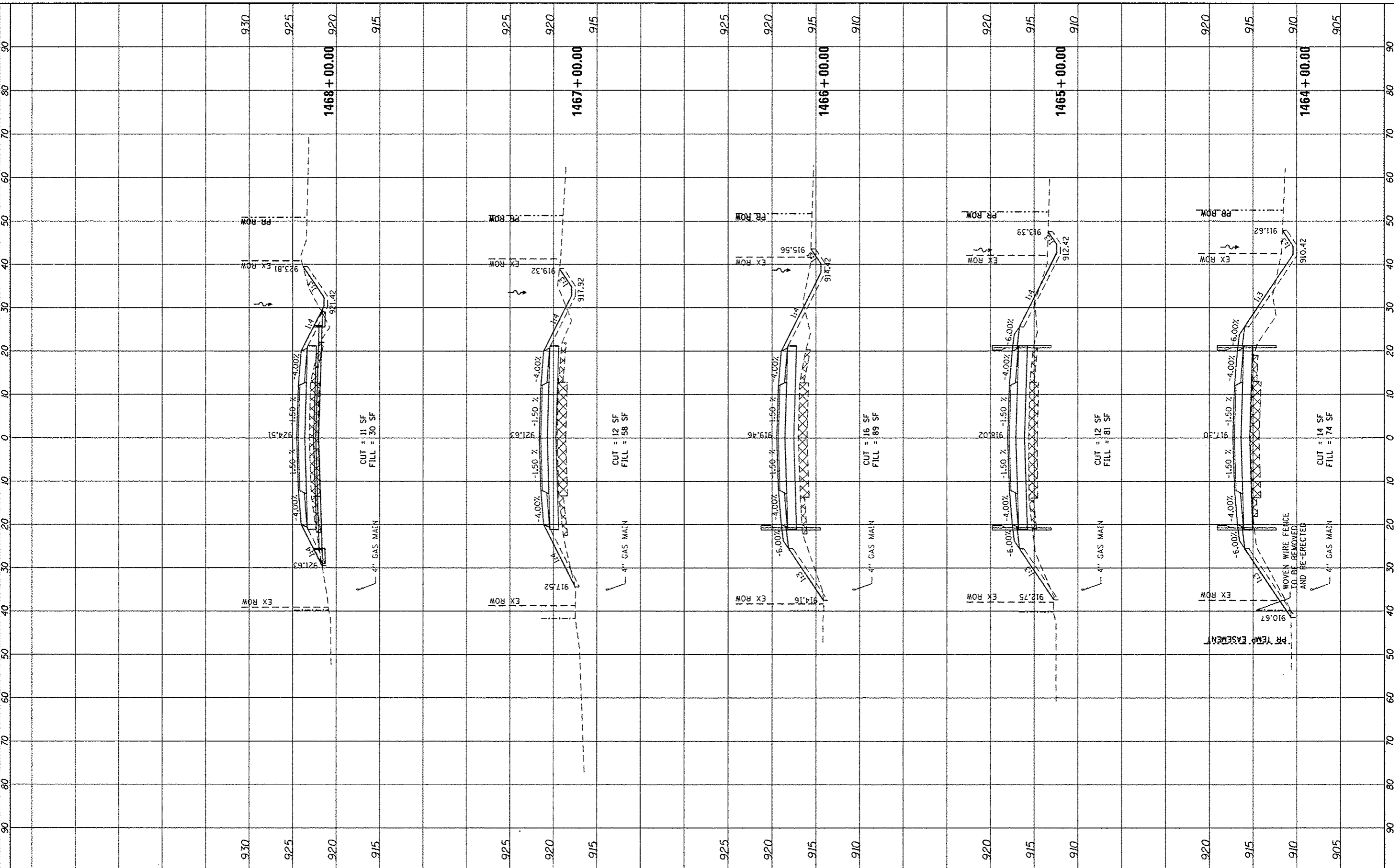

USER NAME	mmann
DESIGNED	MCV
DRAWN	CMM
CHECKED	MTM
DATE	10/12
REVISIONS	

STATE OF ILLINOIS
 DEPARTMENT OF TRANSPORTATION

IL ROUTE 47 OVER VIRGIL DITCH #2
 CROSS SECTIONS
 SCALE: 10H : 5V SHEET NO. 5 OF 7 SHEETS STA. 1464+00.00 TO STA. 1468+00.00

F.A.P. RTE.	SECTION	COUNTY	TOTAL SHEETS	SHEET NO.
326	106X-B	KANE	87	84
CONTRACT NO. 60N13			ILLINOIS FED. AID PROJECT	