

MAINTENANCE OF TRAFFIC LEGEND

- TEMPORARY PAVEMENT
- TEMPORARY CONCRETE BARRIER
- TYPE II BARRICADE OR DRUM W/ TYPE C STEADY BURN MONO-DIRECTIONAL LIGHT

- DOUBLE VERTICAL PANEL
- TRAFFIC DIRECTION

- ① PVT MK - LINE 4" WHITE
- ② PVT MK - LINE 4" YELLOW
- ③ PVT MK - DBL 4" YELLOW
- ④ PVT MK - LINE 4" WHITE (10' DASH- 30' SKIP)
- ⑤ PVT MK - LINE 6" WHITE
- ⑥ PVT MK - LINE 8" WHITE
- ⑦ EXISTING PAVEMENT MARKING

- Ⓣ TEMP PVT MK (SEE GENERAL NOTES SHT G-03)
- Ⓜ WET REF TEM TAPE T3 (SEE GENERAL NOTES SHT G-03)
- Ⓟ PERM PVT MK (SEE PVT MK PLANS)

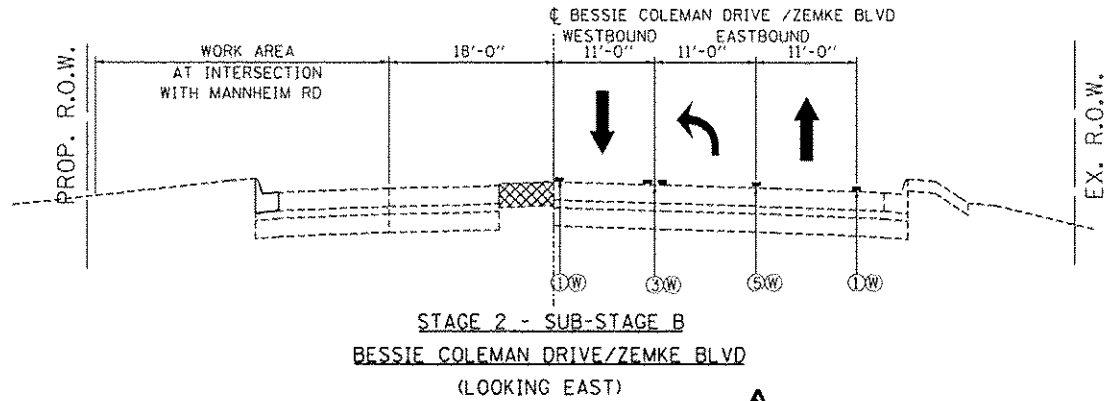
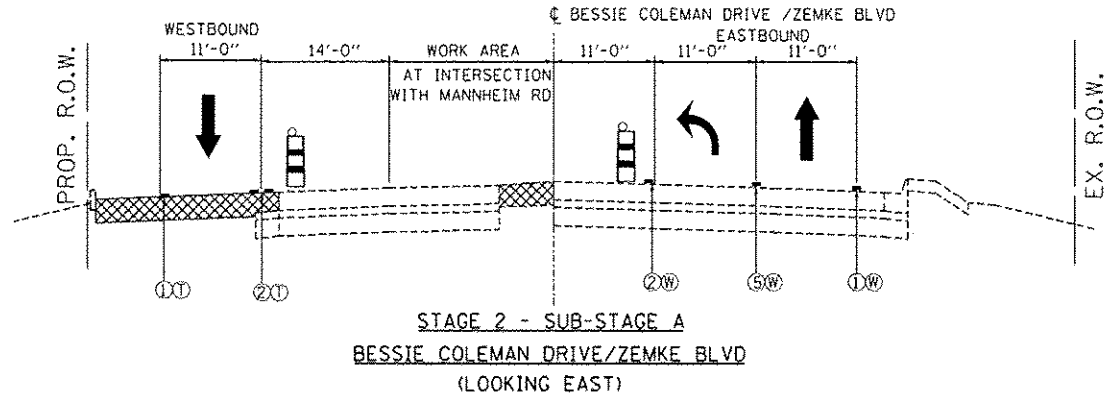
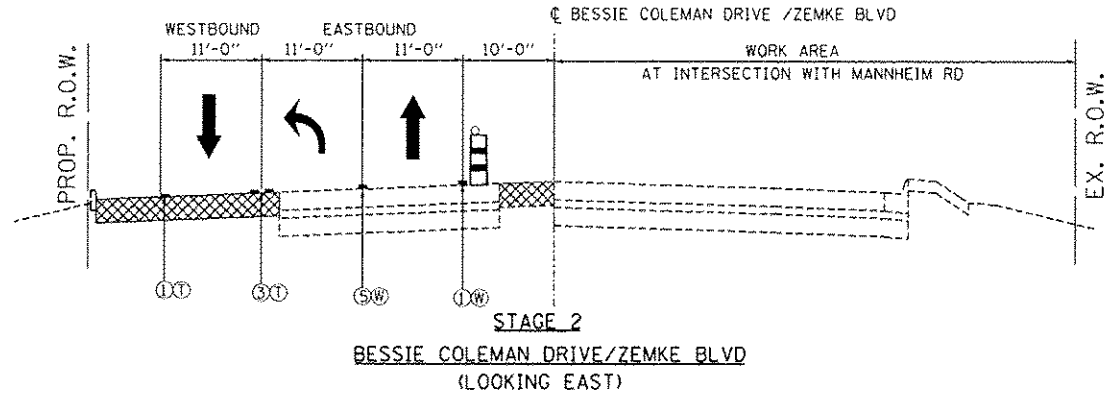

NOTES:

- 1) EPOXY OR POLYUREA PAVEMENT MARKING SHALL BE USED FOR TEMPORARY PAVEMENT MARKING WHEN CONSTRUCTION STAGING EXTENDS OVER THE WINTER PERIOD. EPOXY OR POLYUREA PAVEMENT MARKING WILL BE PAID AT THE CONTRACT UNIT PRICE OF TEMPORARY PAVEMENT MARKING OR WET REFLECTIVE TEMPORARY TAPE TYPE III AND NO ADDITIONAL COMPENSATION WILL BE ALLOWED FOR CHANGES IN QUANTITIES TO COMPLY WITH THIS REQUIREMENT.
- 2) REMOVAL OF EPOXY OR POLYUREA PAVEMENT MARKING THAT WAS PLACED FOR CONSTRUCTION STAGE DURING WINTER PERIOD, WILL BE PAID FOR AS PAVEMENT MARKING REMOVAL.

FILE NAME = USER NAME = #USCR# DESIGNED - JZP REVISED - 12/27/2012 MM
 DRAWN - JZP REVISED -
 CHECKED - KDA REVISED -
 DATE - 10/19/12 REVISED -
 PLOT SCALE = #SCALE# PLOT DATE = 12-26-2012
 TENG ENGINEERS & ARCHITECTS, P.C. CHICAGO, ILLINOIS

STATE OF ILLINOIS DEPARTMENT OF TRANSPORTATION

MAINTENANCE OF TRAFFIC TYPICAL SECTIONS		P.A. RTE.		SECTION		COUNTY		TOTAL SHEET NO.	
BESSIE COLEMAN DRIVE / ZEMKE ROAD		0105-WRS		COOK		537		89	
SCALE: 1"=10'		SHEET NO. OF SHEETS		STA. TO STA.		CONTRACT NO. 60P35			
						ILLINOIS FED. AID PROJECT			

MOT-07