

MAINTENANCE OF TRAFFIC LEGEND

	WORK AREA		TRAFFIC DIRECTION		ARROW BOARD		PVT MK - LINE 4" WHITE		PVT MK - LINE 24" WHITE
	TEMPORARY PAVEMENT (TO BE CONSTRUCTED IN CURRENT STAGE)		BARRICADE, TYPE III, W/ TYPE A BI-DIRECTIONAL FLASHING LIGHT		DOUBLE VERTICAL PANEL		PVT MK - LINE 4" YELLOW		PVT MK - LINE 8" WHITE
			TYPE II BARRICADES OR DRUMS W/ TYPE C STEADY BURN LIGHT		PROPOSED SIGN		PVT MK - DBL 4" YELLOW		TEMP PVT MK (SEE GENERAL NOTES SHT G-03)
			TYPE B MONO-DIRECTIONAL FLASHING LIGHT		TEMPORARY CONCRETE BARRIER		PVT MK - LINE 6" WHITE		WET REF TEM TAPE T3 (SEE GENERAL NOTES SHT G-03)
					RAMP CLOSED		PVT MK - LINE 12"		PERM PVT MK (SEE PVT MK PLANS)
							PVT MK - LTRS & SYMB		

COORDINATE MAINTENANCE OF TRAFFIC STAGING WITH ADJACENT CONTRACTOR. THE CONTRACTOR SHALL OBTAIN THE APPROVAL OF THE ENGINEER PRIOR TO A CHANGE TO THE MAINTENANCE OF TRAFFIC STAGING.

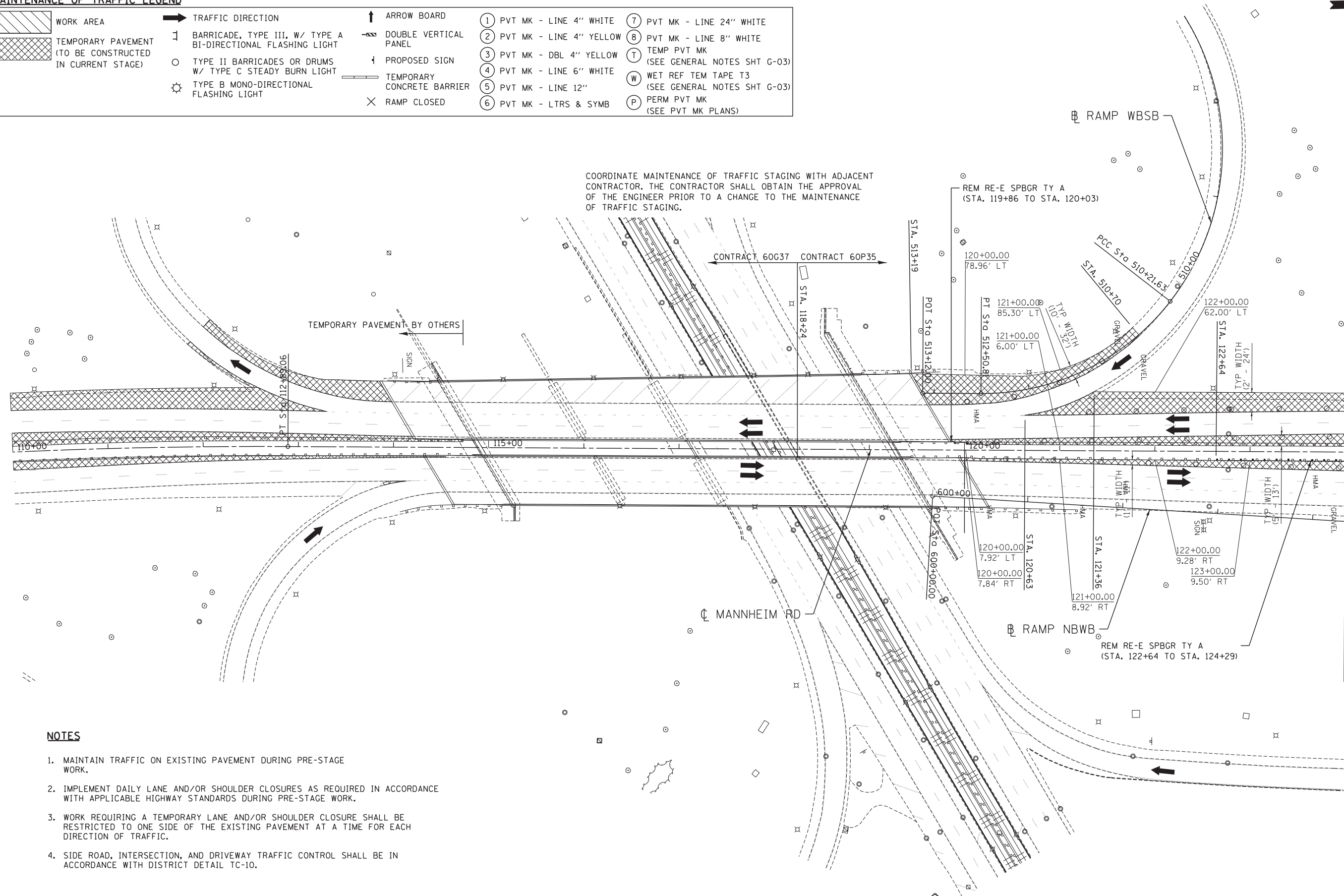

NOTES

1. MAINTAIN TRAFFIC ON EXISTING PAVEMENT DURING PRE-STAGE WORK.
2. IMPLEMENT DAILY LANE AND/OR SHOULDER CLOSURES AS REQUIRED IN ACCORDANCE WITH APPLICABLE HIGHWAY STANDARDS DURING PRE-STAGE WORK.
3. WORK REQUIRING A TEMPORARY LANE AND/OR SHOULDER CLOSURE SHALL BE RESTRICTED TO ONE SIDE OF THE EXISTING PAVEMENT AT A TIME FOR EACH DIRECTION OF TRAFFIC.
4. SIDE ROAD, INTERSECTION, AND DRIVEWAY TRAFFIC CONTROL SHALL BE IN ACCORDANCE WITH DISTRICT DETAIL TC-10.

MATCHLINE STA 124+00
SEE SHEET MOT-11

\\10-05-2012, 14:54:39 BAJZEKJ F:\DOC\EXP\CHI-00012584-02\COMMON\SET\TEMP\SHEET\LOT\DI60P35-SHT-STAGINGP_1.DGN
 \\10-05-2012, 14:54:39 BAJZEKJ F:\DOC\EXP\CHI-00012584-02\COMMON\SET\TEMP\SHEET\LOT\DI60P35-SHT-STAGINGP_1.DGN
 \\10-05-2012, 14:54:39 BAJZEKJ F:\DOC\EXP\CHI-00012584-02\COMMON\SET\TEMP\SHEET\LOT\DI60P35-SHT-STAGINGP_1.DGN

FILE NAME = *FILEL*	USER NAME = *USER*	DESIGNED - BRH	REVISED -	STATE OF ILLINOIS DEPARTMENT OF TRANSPORTATION	MAINTENANCE OF TRAFFIC PRE-STAGE			F.A. RTE.	SECTION	COUNTY	TOTAL SHEETS	SHEET NO.
		DRAWN - JZP	REVISED -		SCALE: 1"=50'	SHEET NO.	OF SHEETS	STA. 110+00	TO STA. 124+00	ILLINOIS	FED. AID PROJECT	
		CHECKED - KDA	REVISED -									91
		DATE - 10/19/12	REVISED -									537
					CONTRACT NO. 60P35							

MOT-10