

NOTE:
SEE HARLEM AVENUE MAINTENANCE OF TRAFFIC - DETOUR PLAN FOR ADVANCED SIGNING

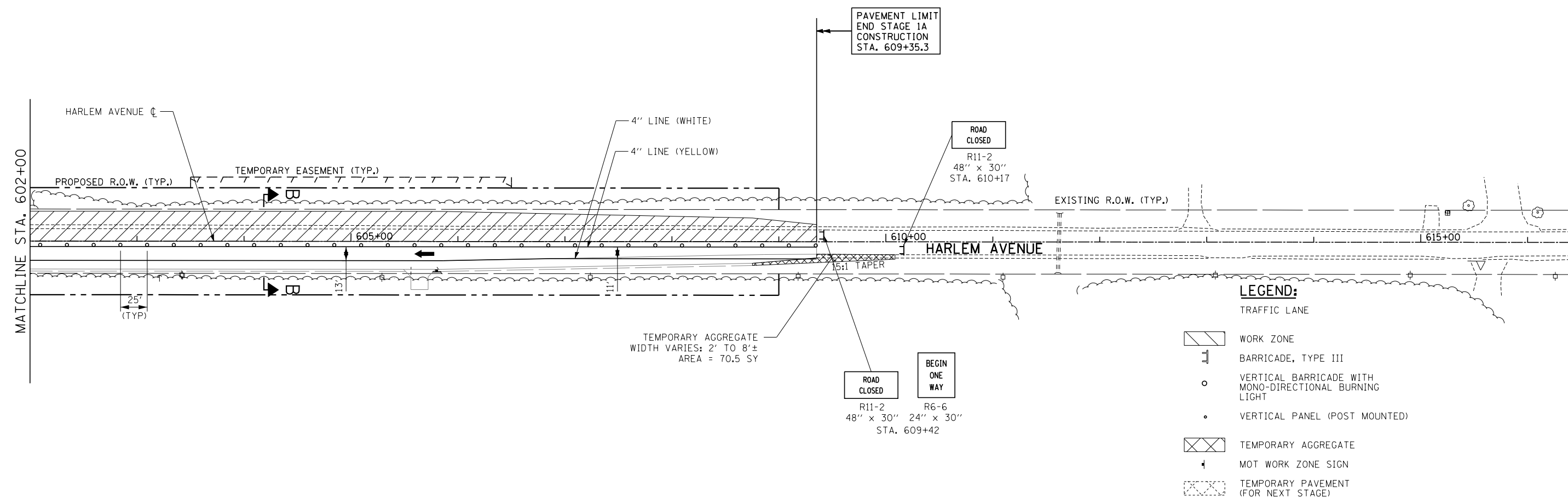

- LEGEND:**
- TRAFFIC LANE
 - WORK ZONE
 - BARRICADE, TYPE III
 - VERTICAL BARRICADE WITH MONO-DIRECTIONAL BURNING LIGHT
 - VERTICAL PANEL (POST MOUNTED)
 - TEMPORARY AGGREGATE
 - MOT WORK ZONE SIGN
 - TEMPORARY PAVEMENT (FOR NEXT STAGE)

| | | | |
|----------------------------|------------------|---------------------|-----------|
| TYLIN INTERNATIONAL | USER NAME = | DESIGNED - JTP | REVISED - |
| | PLOT SCALE = | DRAWN - JTP | REVISED - |
| | PLOT DATE = | CHECKED - JPM | REVISED - |
| | DATE - 9/19/2012 | REVISED - 11/2/2012 | |

**STATE OF ILLINOIS
DEPARTMENT OF TRANSPORTATION**

**STUENKEL ROAD AT I-57 (HARLEM AVENUE TO RIDGELAND AVENUE)
MAINTENANCE OF TRAFFIC PLAN - STAGE 1A - HARLEM AVENUE**

SCALE: 1" = 50' SHEET 2 OF 2 SHEETS STA. 590+00 TO STA. 609+35

| | | | | |
|--------------------|-----------|--------|---------------------------|-----------|
| F.A. RTE. | SECTION | COUNTY | TOTAL SHEETS | SHEET NO. |
| 57 | 2012-048R | WILL | 206 | 48 |
| CONTRACT NO. 60V41 | | | ILLINOIS FED. AID PROJECT | |