

SEE RIDGELAND AVENUE
PROPOSED PAVEMENT MARKING
AND SIGNING SHEETS

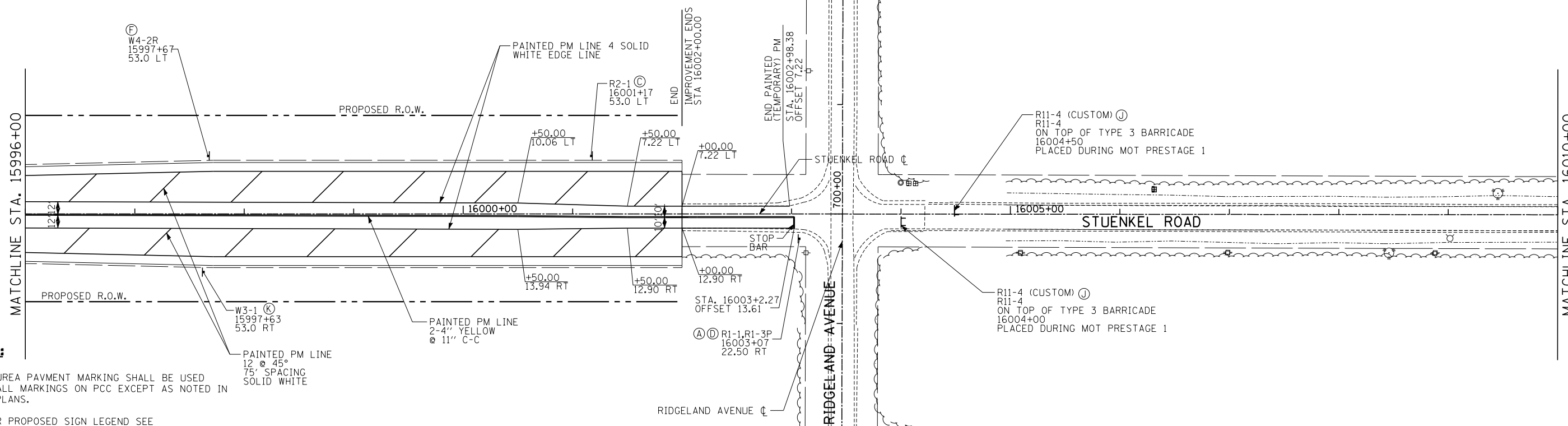

NOTES:

1. POLYUREA PAVMENT MARKING SHALL BE USED FOR ALL MARKINGS ON PCC EXCEPT AS NOTED IN THE PLANS.
2. (X) FOR PROPOSED SIGN LEGEND SEE "SIGNING PLAN DETAILS"
3. THERMOPLASTIC PAVEMENT MARKINGS WILL BE USED OUTSIDE THE PAVEMENT LIMIT TO CONNECT THE EXISTING PAVEMENT MARKING LINES

SEE RIDGELAND AVENUE
PROPOSED PAVEMENT MARKING
AND SIGNING SHEETS

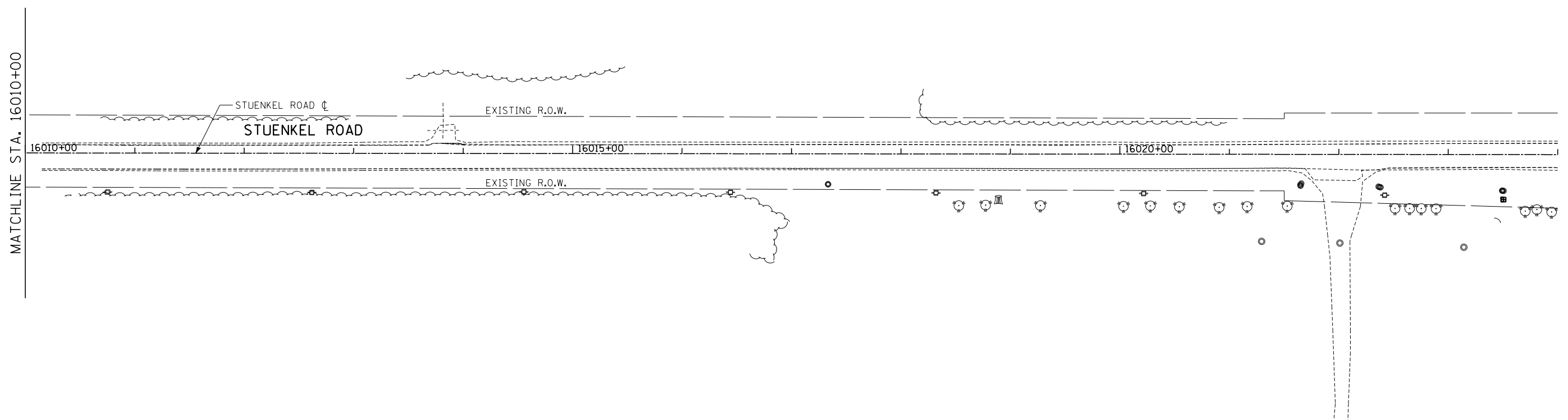

TYLIN INTERNATIONAL	USER NAME =	DESIGNED - JTP	REVISED -
	PLOT SCALE =	DRAWN - JTP	REVISED -
	PLOT DATE =	CHECKED - JPM	REVISED -
		DATE - 9/19/2012	REVISED - 11/2/2012

**STATE OF ILLINOIS
DEPARTMENT OF TRANSPORTATION**

STUENKEL ROAD AT I-57 (HARLEM AVENUE TO RIDGELAND AVENUE)		F.A. RTE.	SECTION	COUNTY	TOTAL SHEETS	SHEET NO.
PROPOSED PAVEMENT MARKING AND SIGNING PLAN - STUENKEL ROAD		57	2012-048R	WILL	206	98
SCALE: 1" = 50'		SHEET 3 OF 4 SHEETS		STA. 15996+00 TO STA. 16010+15		CONTRACT NO. 60V41

ILLINOIS FED. AID PROJECT	
---------------------------	--