

DATE	
BY	
SURVEYED	
PLOTTED	
TEMPLATE	
AREAS	
CHECKED	
NO.	

DATE	
BY	
SURVEYED	
PLOTTED	
TEMPLATE	
AREAS	
CHECKED	
NO.	

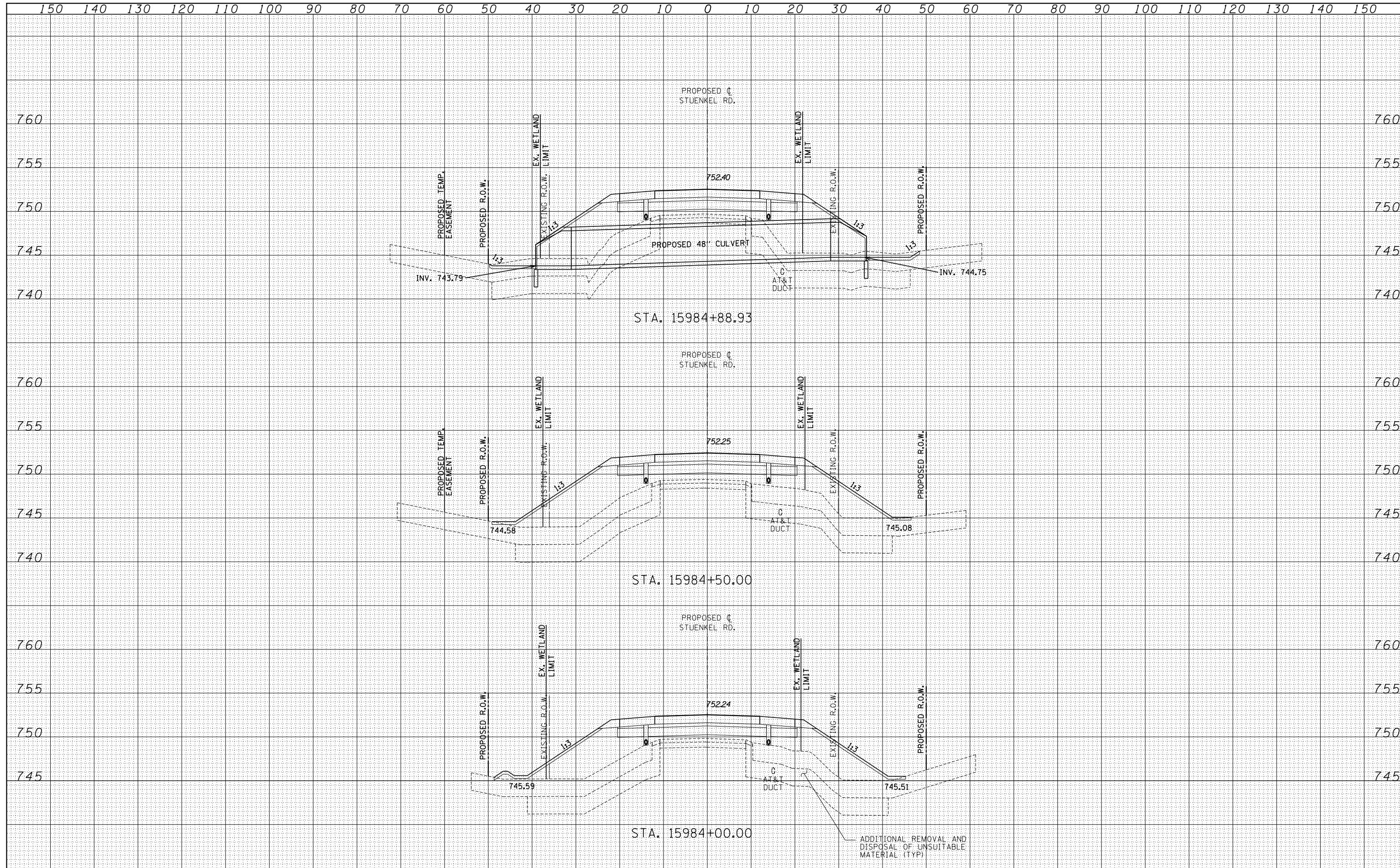

TYLINT INTERNATIONAL USER NAME = PLOT SCALE = PLOT DATE =	DESIGNED - JDF	REVISD -	STATE OF ILLINOIS DEPARTMENT OF TRANSPORTATION STUENKEL ROAD AT I-57 (HARLEM AVE. TO RIDGELAND AVE.) PROPOSED STUENKEL ROAD CROSS SECTIONS	F.A.I. RTE. = 57	SECTION = 2012-048R	COUNTY = WILL	TOTAL SHEETS = 206	SHEET NO. = 157
	DRAWN - JDF	REVISD -		SCALE: 1" = 100' H	SHEET NO. OF SHEETS		CONTRACT NO. 60V41	
	CHECKED - JPM	REVISD -		STA. 15984+00.00 TO STA. 15984+88.93	FED. ROAD DIST. NO.		ILLINOIS FED. AID PROJECT	
	DATE - 9/19/2012	REVISD -						

P:\602612(I-57_e.Stuenkel)\Road\C_2(Interchange)\C2.Stuenkel.50XS.F_SHT.dgn