

NOTES:
 1. SEE MOT LEGENDS.
 2. IDOT STANDARDS 701101, 701606, AND 701701 SHALL BE UTILIZED TO PROVIDE TRAFFIC CONTROL AND PROTECTION FOR THE CONSTRUCTION OF TEMPORARY PAVEMENT AND OTHER CONSTRUCTION ACTIVITIES DURING THIS CONSTRUCTION STAGE.

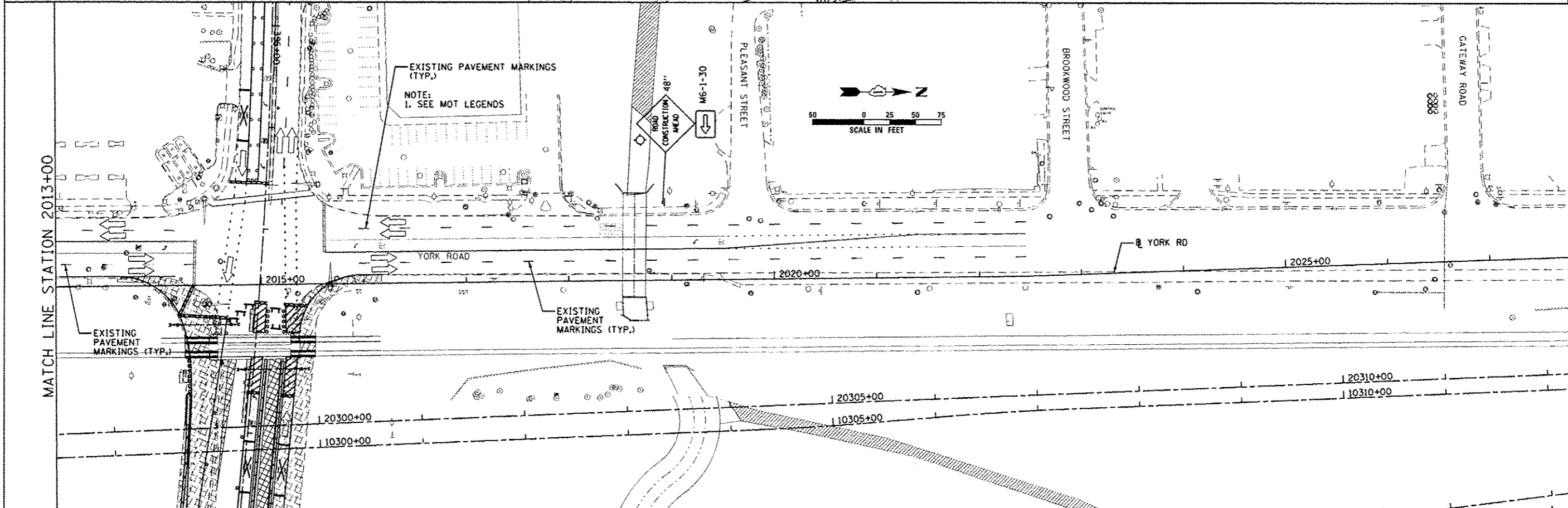

EXISTING PAVEMENT MARKINGS (TYP.)
 NOTE:
 1. SEE MOT LEGENDS



USER NAME: * user *
 PLOT SCALE: * SCALE *
 PLOT DATE: * 12/28/2012

DESIGNED - JJS	REVISED - 12-28-2012 BJZ
DRAWN - TT	REVISED -
CHECKED - LGP	REVISED -
DATE - 11-20-2012	REVISED -

STATE OF ILLINOIS
 DEPARTMENT OF TRANSPORTATION

MAINTENANCE OF TRAFFIC STAGE 1A
 YORK RD.
 SCALE: 1" = 50' SHEET NO. 11 OF 29 SHEETS STA. 2000+00 TO STA. 2028+00

F.A.U. RTE. 1321	SECTION 32VB	COUNTY DUPAGE	TOTAL SHEETS 388	SHEET NO. 60
CONTRACT NO. 60W01			ILLINOIS FED. AID PROJECT	