

UPDATED SIGNS AND PAVEMENT MARKINGS.

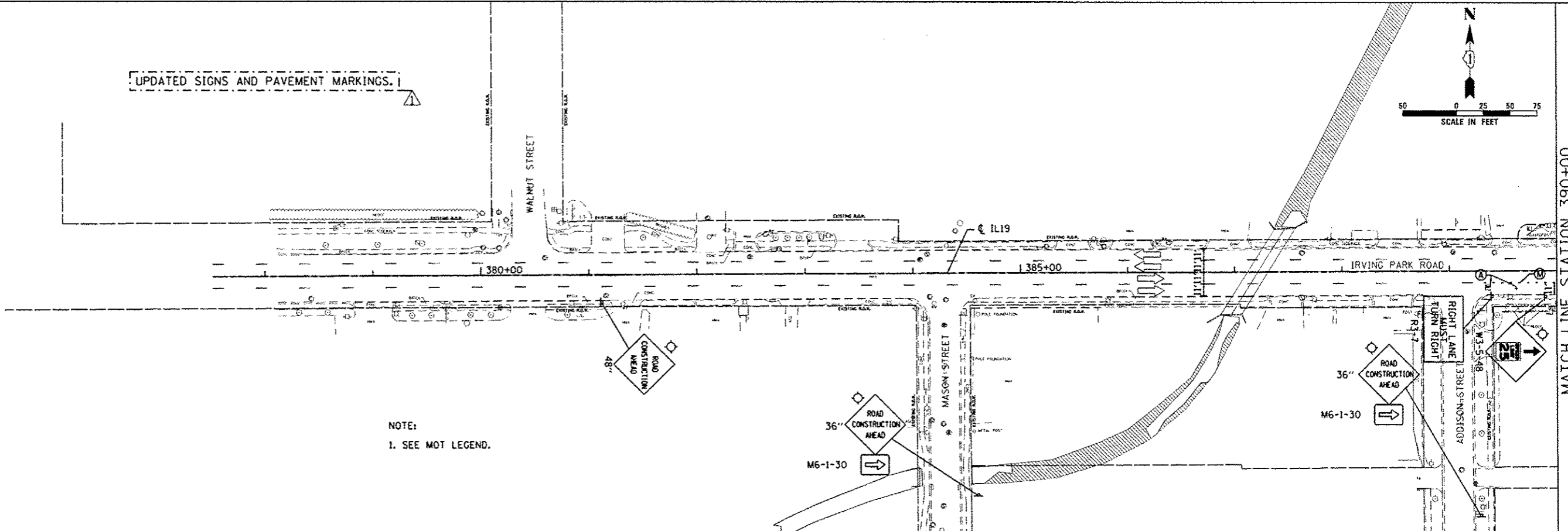

NOTE:
1. SEE MOT LEGEND.

NOTE:
1. SEE MOT LEGEND.
2. IDOT STANDARDS 701101, 701606, AND 701701 SHALL BE UTILIZED TO PROVIDE TRAFFIC CONTROL AND PROTECTION FOR CONSTRUCTION OF TEMPORARY PAVEMENT AND OTHER CONSTRUCTION ACTIVITIES DURING THIS CONSTRUCTION STAGE.

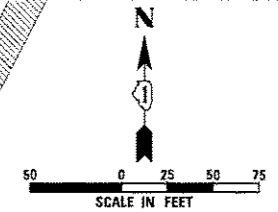
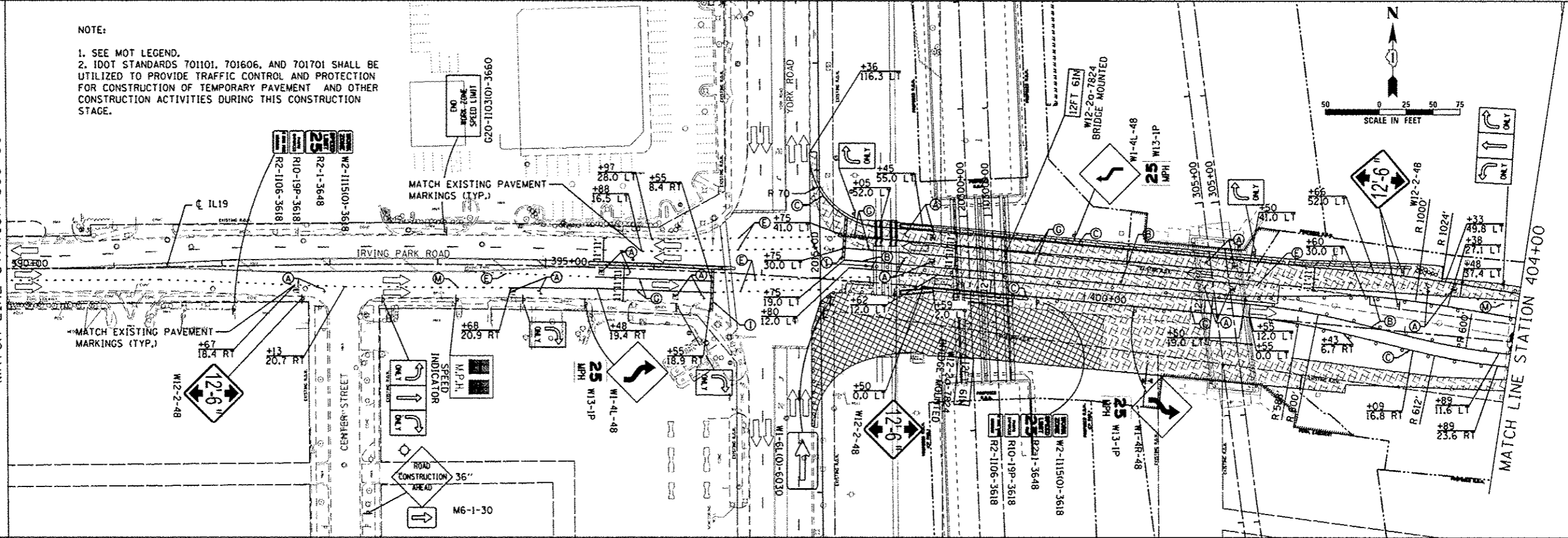
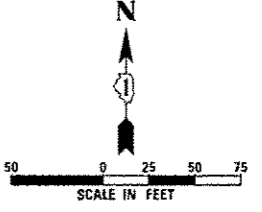

MATCH LINE STATION 390+00

MATCH LINE STATION 404+00



USER NAME: JUS	DESIGNED: JUS
PLOT SCALE: 1/4" = 10'	DRAWN: TT
PLOT DATE: 12/28/2012	CHECKED: LQP
	DATE: 11-20-2012

REVISION 1: 12-28-2012 BJJ
REVISION 2: -
REVISION 3: -
REVISION 4: -

STATE OF ILLINOIS
DEPARTMENT OF TRANSPORTATION

MAINTENANCE OF TRAFFIC STAGE 3
IL ROUTE 19 (IRVING PARK RD.)
SCALE: 1" = 50' SHEET NO. 15 OF 29 SHEETS STA. 377+51.75 TO STA. 404+00

F.A.U. RTE. 1321	SECTION 32VB	COUNTY DUPAGE	TOTAL SHEETS 388	SHEET NO. 64
CONTRACT NO. GOW01				ILLINOIS FED. AID PROJECT