

SPAN 2 CENTER THROUGH GIRDER ELEVATION
(Looking West)

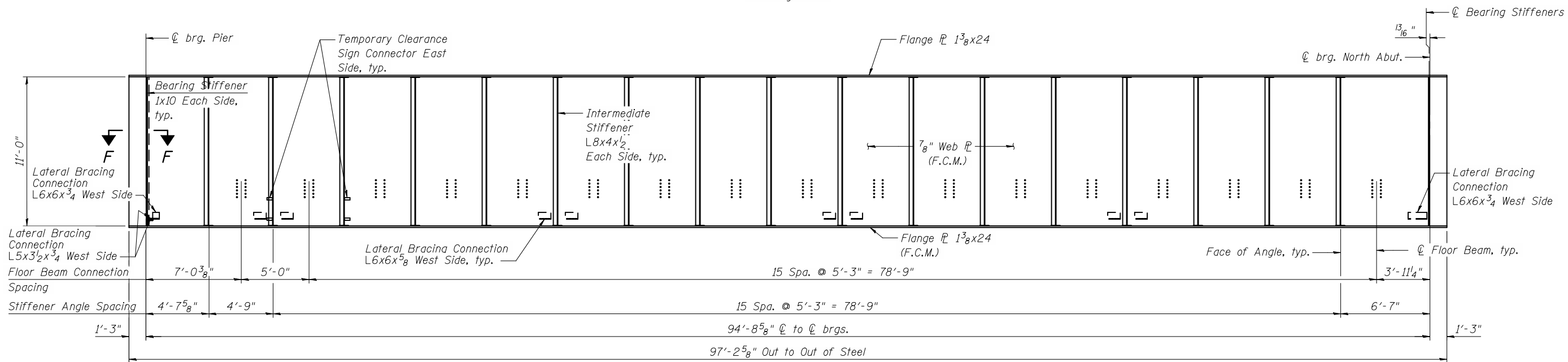

SPAN 2 EAST THROUGH GIRDER OUTSIDE ELEVATION
(Looking West)

- Notes:
1. For Sections E-E and F-F, see Sheet No. 10.
 2. F.C.M. denotes fracture critical member.

c:\pwworking\oma\0463409\0220226-60842-011-GDE.DGN jmlgus

11/2/2012 11:22:57 AM



USER NAME = jmlgus	DESIGNED - AMM	REVISED -
FILE NAME = 0220226-60842-011-GDE.DGN	CHECKED - LAG	REVISED -
PLOT SCALE = NONE	DRAWN - RMA	REVISED -
PLOT DATE = 11/2/2012	CHECKED - AMM	REVISED -

**STATE OF ILLINOIS
DEPARTMENT OF TRANSPORTATION**

**THROUGH GIRDER ELEVATIONS 3
STRUCTURE NO. 022-0226**

SHEET NO. 11 OF 43 SHEETS

F.A.U. RTE.	SECTION	COUNTY	TOTAL SHEETS	SHEET NO.
1321	32VB		388	152
CONTRACT NO. 60W01				
ILLINOIS FED. AID PROJECT				