

**PIER
BILL OF MATERIAL**

Bar	No.	Size	Length	Shape
h(E)	30	#5	54'-6"	—
n(E)	180	#9	12'-5"	L
p(E)	15	#8	55'-2"	—
p ₁ (E)	4	#6	55'-2"	—
s(E)	87	#6	8'-0"	┌
s ₁ (E)	87	#6	14'-8"	└
t(E)	108	#6	13'-4"	┐
u(E)	4	#6	10'-2"	┌
u ₁ (E)	30	#5	8'-2"	┌
u ₂ (E)	4	#6	9'-10"	┌
v(E)	180	#9	18'-2"	—
w(E)	13	#8	55'-6"	—
w ₁ (E)	4	#6	55'-6"	—
Structural Excavation		Cu. Yd.	252	
Reinforcing Bars, Epoxy Coated		Pounds	30,730	
Furnishing Steel Piles HP14X89		Foot	1,242	
Driving Piles		Foot	1,242	
Test Pile Steel HP14x89		Each	1	
Anchor Bolts 1/2"		Each	24	
Concrete Sealer		Sq. Ft.	2,237	
Concrete Structure CPR Special		Cu. Yd.	241.3	

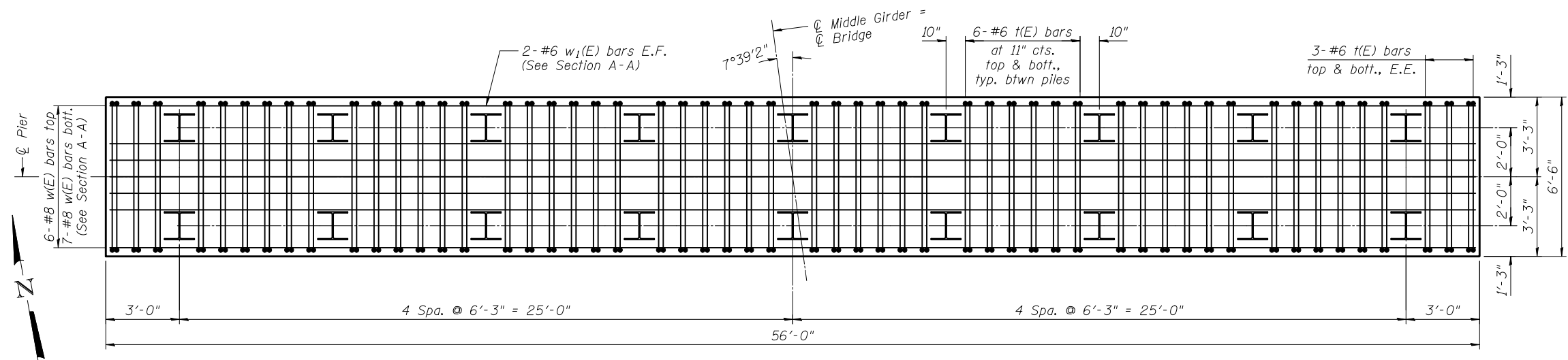

FOOTING PLAN

Top and side longitudinal reinforcing steel not shown.

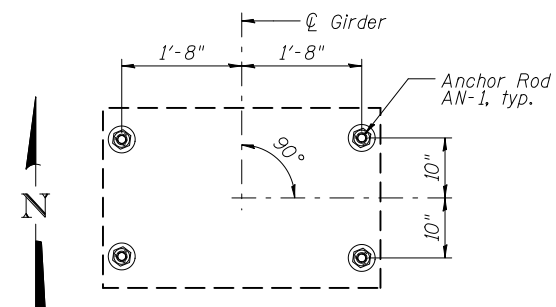

ANCHOR ROD LAYOUT 1

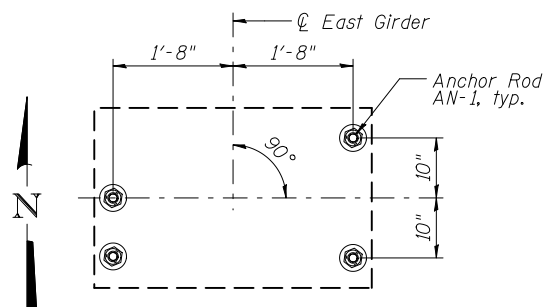

ANCHOR ROD LAYOUT 2

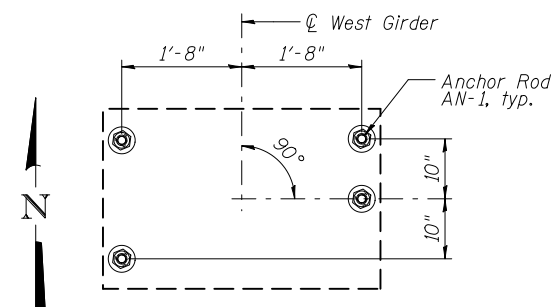

ANCHOR ROD LAYOUT 3

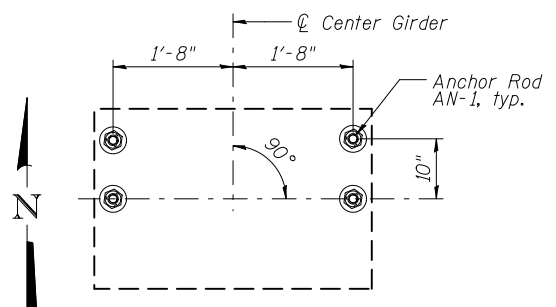

ANCHOR ROD LAYOUT 4

PILE DATA

Type: HP14x89
 Pile Cutoff Elev.: 657.92
 Min. Pile Tip Elev.: 588.92
 Est. Pile Length: 69'
 Required Resistance: 206 kips
 Allowable Resistance: 103 kips
 Available: 103 kips
 No. Piles: 17+1 Test Pile

- Notes:
- All piles must be driven to the minimum tip elevation shown. At the minimum tip elevation, driving shall be continued until the required resistance is achieved. "Required resistance" is equivalent to "nominal required bearing" in the IDOT Standard Specifications. The nominal driven bearing, as determined by the pile driving formula specified in Art. 512.14 of the IDOT Standard Specifications and modified by the Special Provisions, must be greater than or equal to the required resistance shown.
 - In addition to meeting the minimum tip elevation requirements of Note 1, piles shall be driven to fractured rock. If fractured rock is encountered above the minimum tip elevation, the piles may be terminated after driving 2'-0" into the fractured rock.

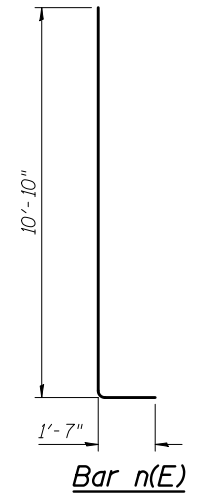

Bar n(E)

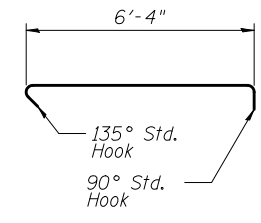

Bar s(E)

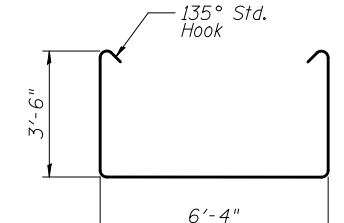

Bar s₁(E)

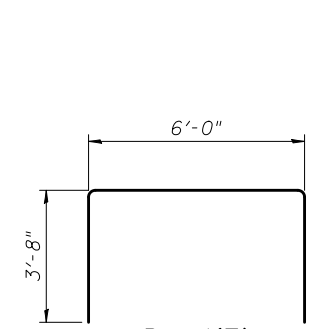

Bar t(E)

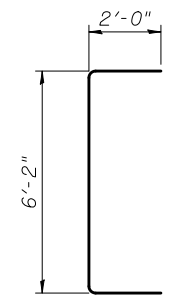

Bar u(E)

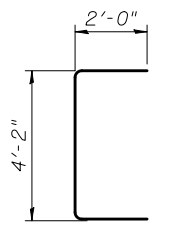

Bar u₁(E)

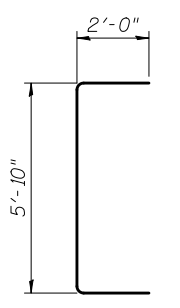

Bar u₂(E)

11/2/2012 11:26:39 AM c:\pwworking\oma\0220226-60B42-037-PRD.DGN jmlgus



USER NAME = jmlgus	DESIGNED - AMM	REVISED -
FILE NAME = 0220226-60B42-037-PRD.DGN	CHECKED - LAG	REVISED -
PLOT SCALE = NONE	DRAWN - RMA	REVISED -
PLOT DATE = 11/2/2012	CHECKED - AMM	REVISED -

**STATE OF ILLINOIS
DEPARTMENT OF TRANSPORTATION**

**PIER FOOTING PLAN AND BILL OF MATERIAL
STRUCTURE NO. 022-0226**

SHEET NO. 37 OF 43 SHEETS

F.A.U. RTE.	SECTION	COUNTY	TOTAL SHEETS	SHEET NO.
1321	32VB	DU PAGE	388	178
CONTRACT NO. 60W01				
ILLINOIS FED. AID PROJECT				