

LONGITUDINAL SECTION

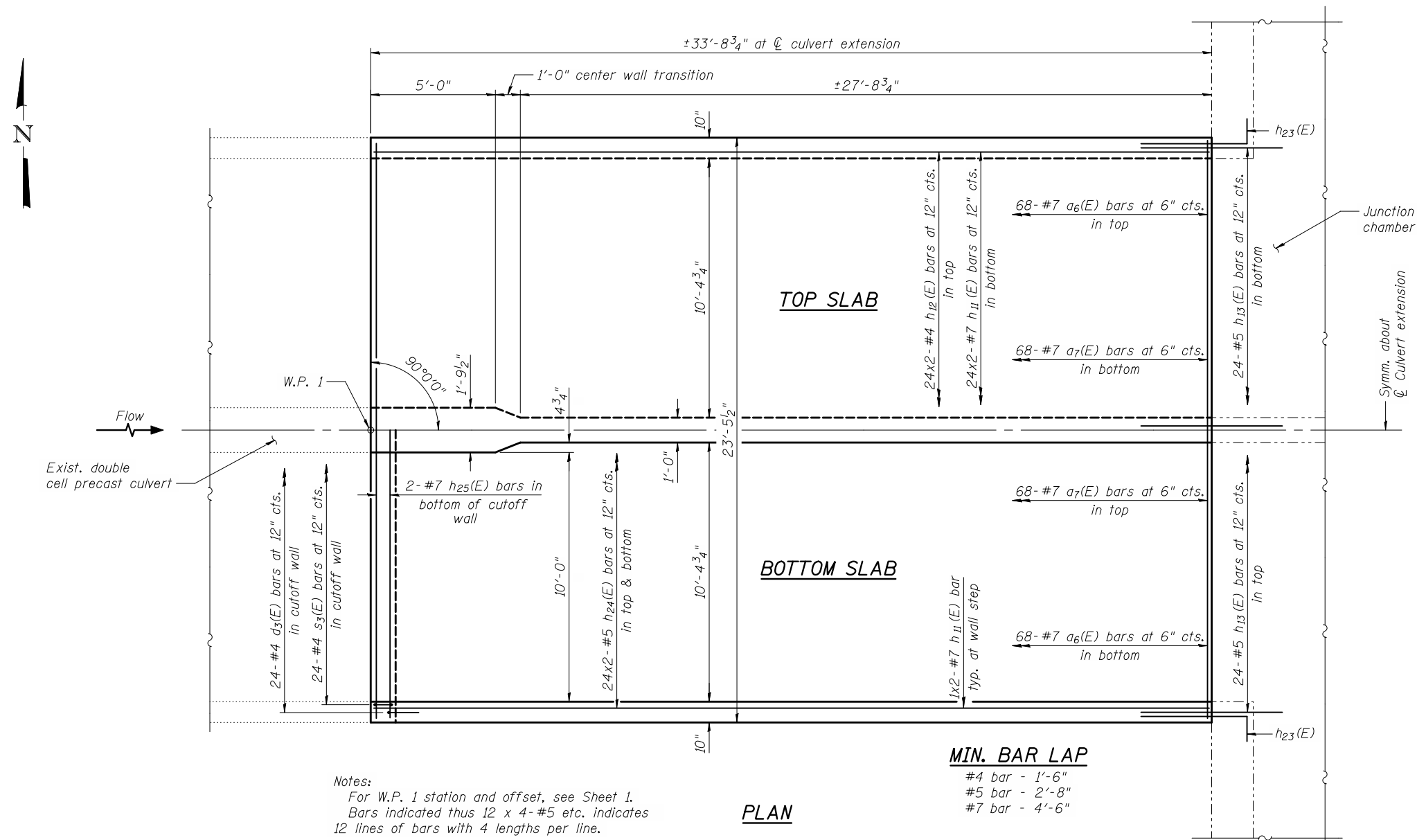

TOP SLAB

BOTTOM SLAB

MIN. BAR LAP

- #4 bar - 1'-6"
- #5 bar - 2'-8"
- #7 bar - 4'-6"

Notes:
 For W.P. 1 station and offset, see Sheet 1.
 Bars indicated thus 12 x 4-#5 etc. indicates
 12 lines of bars with 4 lengths per line.

PLAN

ca:\pwworking\oma\0464045\0223125-60842-004-EDT.DGN
 jmlgus

11/2/2012
 11:28:46 AM



USER NAME = jmlgus	DESIGNED - DLO	REVISED -
FILE NAME = 0223125-60842-004-EDT.DGN	CHECKED - LJC	REVISED -
PLOT SCALE = NONE	DRAWN - RMA	REVISED -
PLOT DATE = 11/2/2012	CHECKED - LGP	REVISED -

**STATE OF ILLINOIS
 DEPARTMENT OF TRANSPORTATION**

**DOUBLE CELL BOX CULVERT EXTENSION DETAILS
 STRUCTURE NO. 022-3125**

F.A.P. RTE.	SECTION	COUNTY	TOTAL SHEETS	SHEET NO.
345A	32VB		388	193
CONTRACT NO. 60W01				

SHEET NO. 4 OF 13 SHEETS

ILLINOIS FED. AID PROJECT