

SECTION THRU JUNCTION CHAMBER

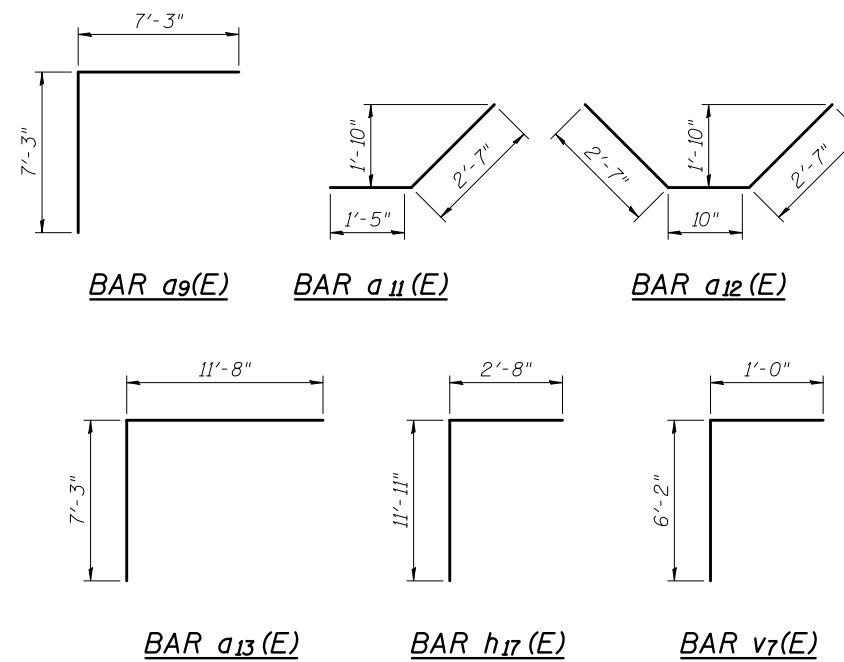

BILL OF MATERIAL

Bar	No.	Size	Length	Shape
a ₈ (E)	50	#8	37'-9"	—
a ₉ (E)	100	#6	14'-6"	┌
a ₁₀ (E)	100	#7	25'-9"	—
a ₁₁ (E)	100	#4	4'-0"	↘
a ₁₂ (E)	50	#4	6'-0"	↘
a ₁₃ (E)	52	#6	18'-11"	┌
h ₁₄ (E)	236	#5	5'-8"	—
h ₁₅ (E)	217	#7	11'-8"	—
h ₁₆ (E)	16	#6	11'-11"	—
h ₁₇ (E)	16	#6	14'-7"	┌
h ₁₈ (E)	64	#6	5'-8"	—
v ₇ (E)	52	#5	7'-2"	┌
v ₈ (E)	48	#5	10'-3"	—
Concrete Box Culverts CPR Special			Cu. Yd.	93.4
Reinforcement Bars, Epoxy Coated			Pound	23,080

c:\pwworking\oma\0464045\0223125-60842-007-JDT.DGN
jmgus

11/2/2012 11:29:09 AM



USER NAME = jmgus	DESIGNED - DLO	REVISED -
FILE NAME = 0223125-60842-007-JDT.DGN	CHECKED - LJC	REVISED -
PLOT SCALE = NONE	DRAWN - RMA	REVISED -
PLOT DATE = 11/2/2012	CHECKED - LGP	REVISED -

STATE OF ILLINOIS
DEPARTMENT OF TRANSPORTATION

JUNCTION CHAMBER DETAILS
STRUCTURE NO. 022-3125

SHEET NO. 7 OF 13 SHEETS

F.A.P. RTE.	SECTION	COUNTY	TOTAL SHEETS	SHEET NO.
345A	32VB	DU PAGE	388	196
CONTRACT NO. 60W01				
ILLINOIS FED. AID PROJECT				