

[Symbol] DENOTES ITEM OR WORK NOT PAID FOR SEPARATELY.
NOTE:
 AN IN-STREAM WORK PLAN SHALL BE PROVIDED BY THE CONTRACTOR TO THE US ARMY CORPS OF ENGINEERS (USACE) FOR APPROVAL. NO WORK IN THE STREAM WILL BE ALLOWED TO START WITHOUT THE WRITTEN APPROVAL OF USACE. THE IN-STREAM WORK PLAN AND ANY BMP'S REQUIRED WILL NOT BE MEASURED FOR PAYMENT SEPARATELY BUT WILL BE INCLUDED IN THE UNIT PRICE OF THE PAY ITEM 'CONCRETE BOX CULVERTS CPR SPECIAL.' NO ADDITIONAL COMPENSATION WILL BE ALLOWED.

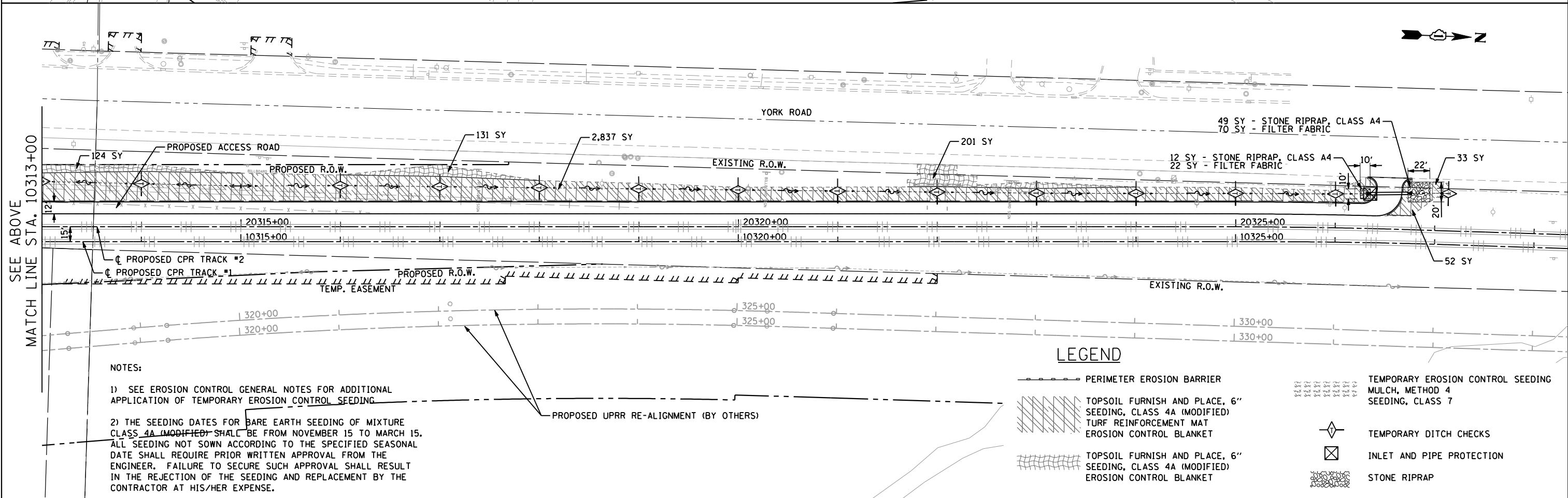

NOTES:
 1) SEE EROSION CONTROL GENERAL NOTES FOR ADDITIONAL APPLICATION OF TEMPORARY EROSION CONTROL SEEDING.
 2) THE SEEDING DATES FOR BARE EARTH SEEDING OF MIXTURE CLASS 4A (MODIFIED) SHALL BE FROM NOVEMBER 15 TO MARCH 15. ALL SEEDING NOT SOWN ACCORDING TO THE SPECIFIED SEASONAL DATE SHALL REQUIRE PRIOR WRITTEN APPROVAL FROM THE ENGINEER. FAILURE TO SECURE SUCH APPROVAL SHALL RESULT IN THE REJECTION OF THE SEEDING AND REPLACEMENT BY THE CONTRACTOR AT HIS/HER EXPENSE.

LEGEND

	PERIMETER EROSION BARRIER		TEMPORARY EROSION CONTROL SEEDING
	TOPSOIL FURNISH AND PLACE, 6" SEEDING, CLASS 4A (MODIFIED)		TEMPORARY DITCH CHECKS
	TURF REINFORCEMENT MAT		INLET AND PIPE PROTECTION
	EROSION CONTROL BLANKET		STONE RIPRAP

FILE NAME = ...\\DIB6001-SHT-EROS3-RR02.DGN



USER NAME = nraterrm	DESIGNED - NMR	REVISED -
PLOT SCALE = 100.0000' / IN.	DRAWN - NMR	REVISED -
PLOT DATE = 11/2/2012	CHECKED - MPH	REVISED -
	DATE - 11-02-2012	REVISED -

**STATE OF ILLINOIS
DEPARTMENT OF TRANSPORTATION**

**CANADIAN PACIFIC RAILWAY
EROSION CONTROL PLAN STAGE RR-3 (RAILROAD)**
 SCALE: 1"=50' SHEET NO. 6 OF 6 SHEETS STA. 10298+00 TO STA. 10326+99.52

F.A.U. RTE.	SECTION	COUNTY	TOTAL SHEETS	SHEET NO.
1321	32VB		388	353
ILLINOIS FED. AID PROJECT			CONTRACT NO. 60W01	