

BY	DATE

BY	DATE

FILE NAME : ...\\060801-SHT-VSC-Rail.dwg

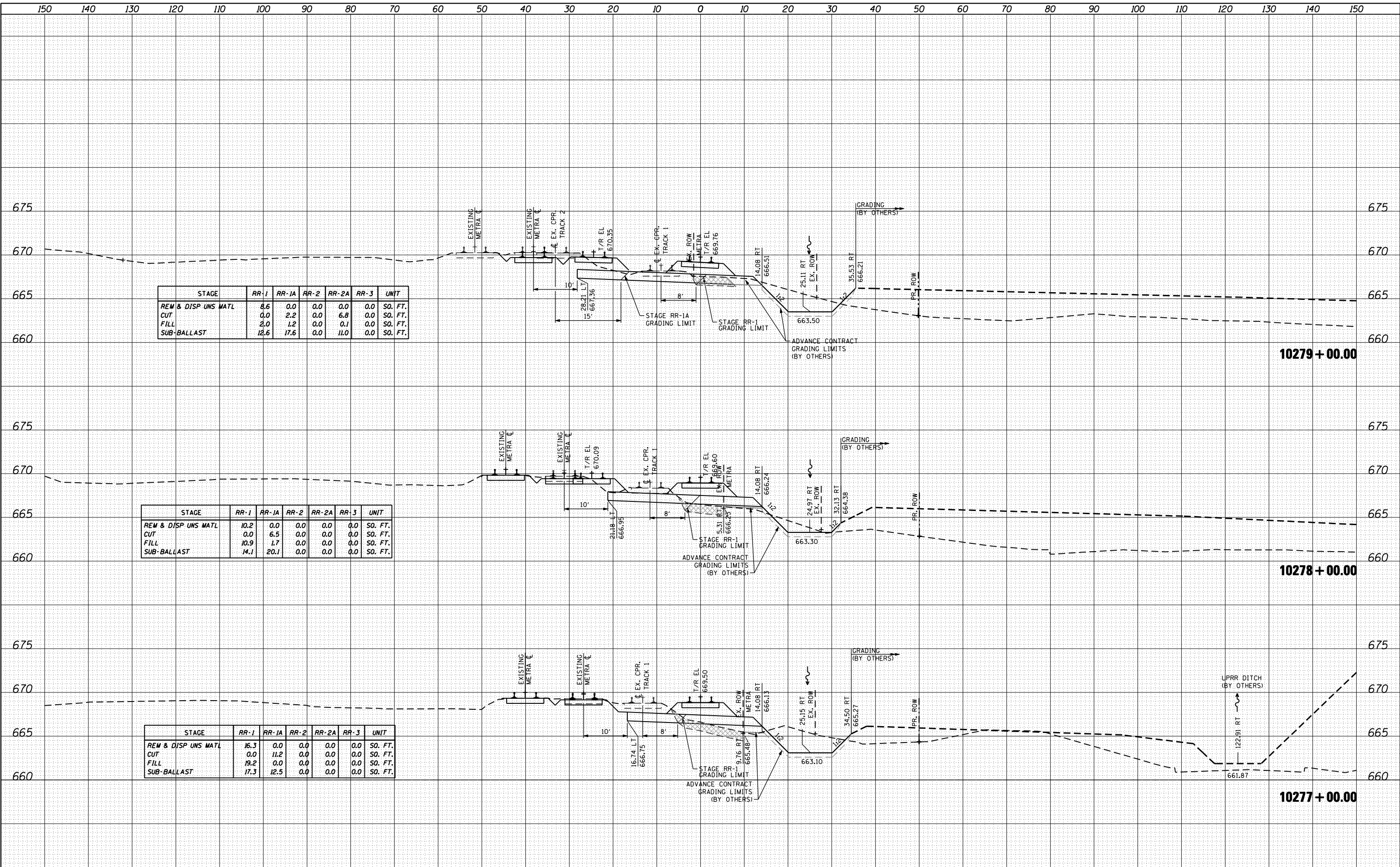

STAGE	RR-1	RR-1A	RR-2	RR-2A	RR-3	UNIT
REM & DISP UNS MATL	8.6	0.0	0.0	0.0	0.0	SO. FT.
CUT	0.0	2.2	0.0	6.8	0.0	SO. FT.
FILL	2.0	1.2	0.0	0.1	0.0	SO. FT.
SUB-BALLAST	12.6	17.6	0.0	11.0	0.0	SO. FT.

STAGE	RR-1	RR-1A	RR-2	RR-2A	RR-3	UNIT
REM & DISP UNS MATL	10.2	0.0	0.0	0.0	0.0	SO. FT.
CUT	0.0	6.5	0.0	0.0	0.0	SO. FT.
FILL	10.9	1.7	0.0	0.0	0.0	SO. FT.
SUB-BALLAST	14.1	20.1	0.0	0.0	0.0	SO. FT.

STAGE	RR-1	RR-1A	RR-2	RR-2A	RR-3	UNIT
REM & DISP UNS MATL	16.3	0.0	0.0	0.0	0.0	SO. FT.
CUT	0.0	11.2	0.0	0.0	0.0	SO. FT.
FILL	19.2	0.0	0.0	0.0	0.0	SO. FT.
SUB-BALLAST	17.3	12.5	0.0	0.0	0.0	SO. FT.



USER NAME = natterm
 DESIGNED - NMR
 DRAWN - NMR
 CHECKED - MPH
 DATE - 11-02-2012
 PLOT SCALE = 20.0000' / IN.
 PLOT DATE = 11/2/2012

REVISID -
 REVISID -
 REVISID -
 REVISID -

STATE OF ILLINOIS
 DEPARTMENT OF TRANSPORTATION

CANADIAN PACIFIC RAILWAY
 CROSS SECTIONS

SCALE: SHEET NO. 3 OF 28 SHEETS STA. 10277+00.00 TO STA. 10279+00.00

F.A.U. RTE.	SECTION	COUNTY	TOTAL SHEETS	SHEET NO.
1321	32VB	DUPAGE	388	363
CONTRACT NO. 60W01				
ILLINOIS FED. AID PROJECT				