

BY: _____ DATE: _____
 SURVEYED: _____ PLOTTED: _____
 FINISHED: _____ TEMPLATE: _____
 NO. _____ NOTE BOOK: _____
 AREAS CHECKED: _____

BY: _____ DATE: _____
 SURVEYED: _____ PLOTTED: _____
 ORIGINAL: _____ TEMPLATE: _____
 NO. _____ NOTE BOOK: _____
 AREAS CHECKED: _____

FILE NAME = ... \060801-SHT-VSC-Rail.dwg

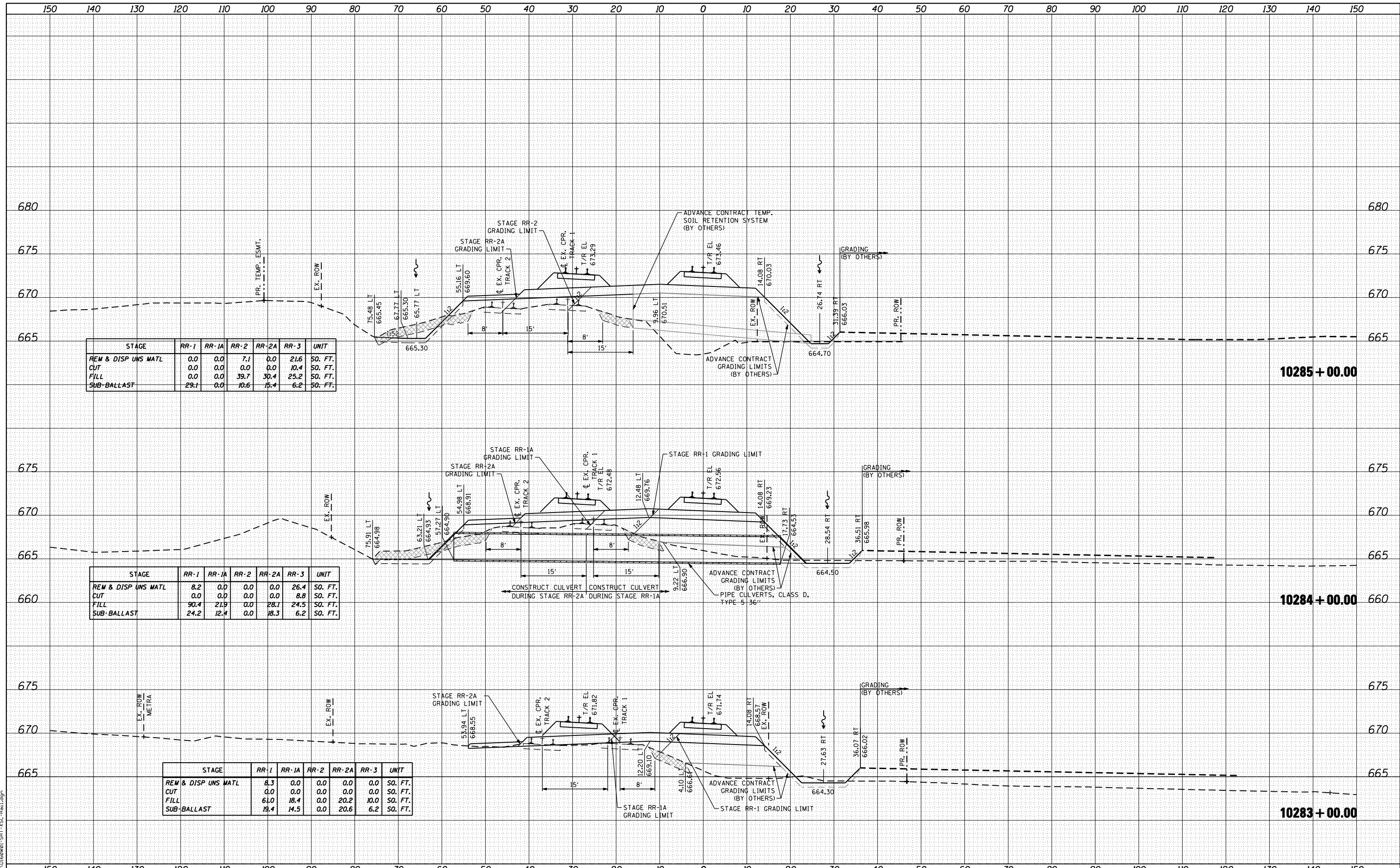

STAGE	RR-1	RR-1A	RR-2	RR-2A	RR-3	UNIT
REM & DISP UNS MATL	0.0	0.0	7.1	0.0	21.6	50. FT.
CUT	0.0	0.0	0.0	0.0	10.4	50. FT.
FILL	0.0	0.0	39.7	30.4	25.2	50. FT.
SUB-BALLAST	29.1	0.0	10.6	15.4	6.2	50. FT.

STAGE	RR-1	RR-1A	RR-2	RR-2A	RR-3	UNIT
REM & DISP UNS MATL	8.2	0.0	0.0	0.0	26.4	50. FT.
CUT	0.0	0.0	0.0	0.0	8.8	50. FT.
FILL	90.4	21.9	0.0	28.1	24.5	50. FT.
SUB-BALLAST	24.2	12.4	0.0	18.3	6.2	50. FT.

STAGE	RR-1	RR-1A	RR-2	RR-2A	RR-3	UNIT
REM & DISP UNS MATL	8.3	0.0	0.0	0.0	0.0	50. FT.
CUT	0.0	0.0	0.0	0.0	0.0	50. FT.
FILL	61.0	18.4	0.0	20.2	10.0	50. FT.
SUB-BALLAST	19.4	14.5	0.0	20.6	6.2	50. FT.



USER NAME = natterm
 PLOT SCALE = 20.0000' / IN.
 PLOT DATE = 11/2/2012

DESIGNED - NMR
 DRAWN - NMR
 CHECKED - MPH
 DATE - 11-02-2012

REVISED -
 REVISED -
 REVISED -
 REVISED -

STATE OF ILLINOIS
 DEPARTMENT OF TRANSPORTATION

CANADIAN PACIFIC RAILWAY
 CROSS SECTIONS

SCALE: SHEET NO. 5 OF 28 SHEETS STA. 10283+00.00 TO STA. 10285+00.00

F.A.U. RTE. 1321	SECTION 32VB	COUNTY	TOTAL SHEETS 388	SHEET NO. 365
ILLINOIS FED. AID PROJECT			CONTRACT NO. 6W01	