

DATE	
BY	
SURVEYED	
PLOTTED	
TEMPLATE	
AREAS	
CHECKED	
NO.	

DATE	
BY	
SURVEYED	
PLOTTED	
TEMPLATE	
AREAS	
CHECKED	
NO.	

FILE NAME = ... \D69081-SHT-VSC-Rail.dwg

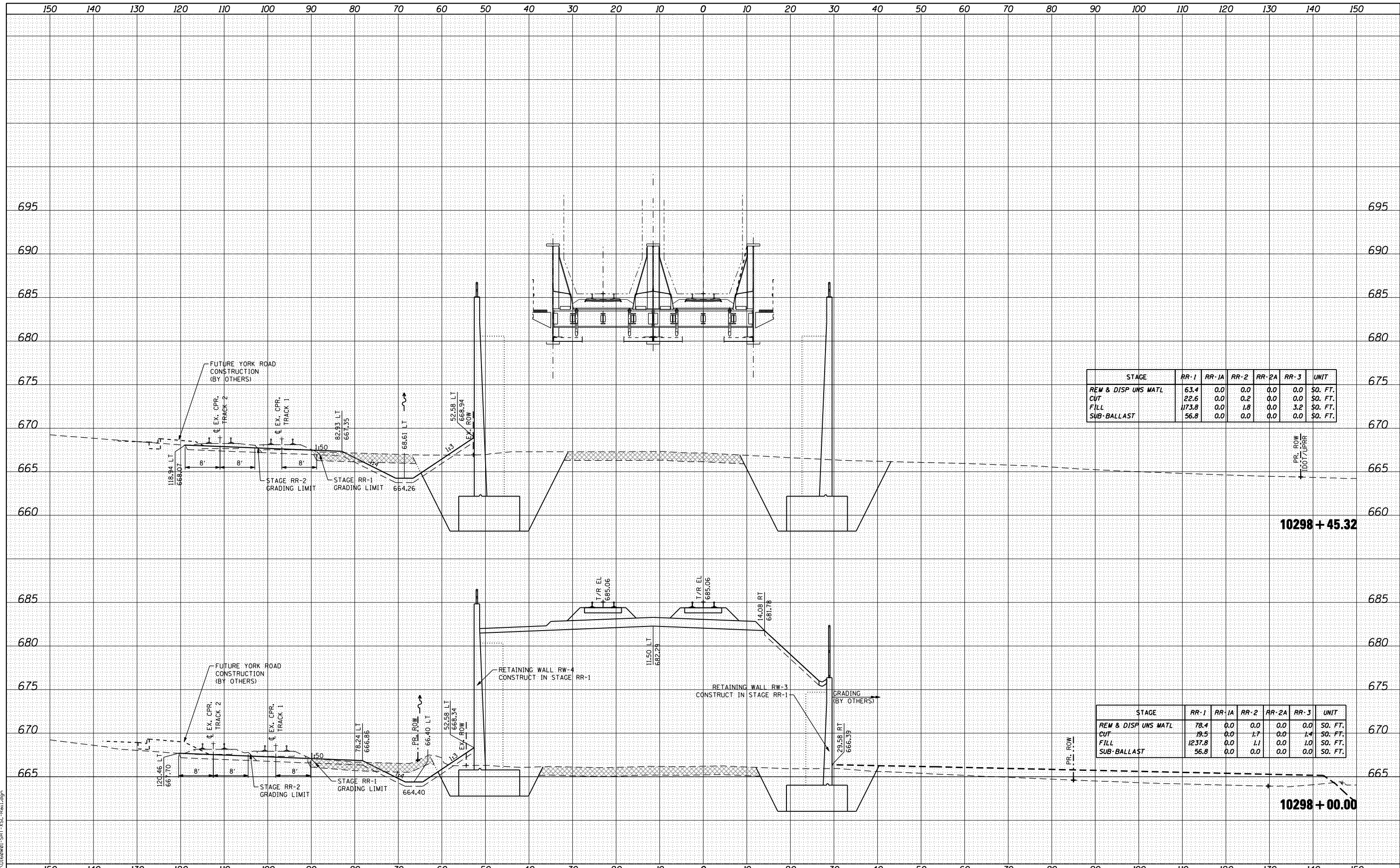

STAGE	RR-1	RR-1A	RR-2	RR-2A	RR-3	UNIT
REM & DISP UNS MATL	63.4	0.0	0.0	0.0	0.0	\$0. FT.
CUT	22.6	0.0	0.2	0.0	0.0	\$0. FT.
FILL	173.8	0.0	1.8	0.0	3.2	\$0. FT.
SUB-BALLAST	56.8	0.0	0.0	0.0	0.0	\$0. FT.

STAGE	RR-1	RR-1A	RR-2	RR-2A	RR-3	UNIT
REM & DISP UNS MATL	78.4	0.0	0.0	0.0	0.0	\$0. FT.
CUT	19.5	0.0	1.7	0.0	1.4	\$0. FT.
FILL	1237.8	0.0	1.1	0.0	1.0	\$0. FT.
SUB-BALLAST	56.8	0.0	0.0	0.0	0.0	\$0. FT.



USER NAME = natterm
 DESIGNED - NMR
 DRAWN - NMR
 CHECKED - MPH
 DATE - 11-02-2012
 PLOT SCALE = 20.0000' / IN.
 PLOT DATE = 11/2/2012

REVISIED -
 REVISIED -
 REVISIED -
 REVISIED -

**STATE OF ILLINOIS
 DEPARTMENT OF TRANSPORTATION**

**CANADIAN PACIFIC RAILWAY
 CROSS SECTIONS**

SCALE: SHEET NO. 11 OF 28 SHEETS STA. 10298+00.00 TO STA. 10298+45.32

F.A.U. RTE.	SECTION	COUNTY	TOTAL SHEETS	SHEET NO.
1321	32VB	DUPAGE	388	371
CONTRACT NO. 60W01			ILLINOIS FED. AID PROJECT	